

TRAFFIC SIGNAL LEGEND

- |  |          |          |
|--|----------|----------|
|  | PROPOSED | EXISTING |
| CONTROLLER   |          |          |
| SERVICE INSTALLATION   |          |          |
| SIGNAL HEAD  |          |          |
| SIGNAL HEAD WITH BACKPLATE                                   |          |          |
| SIGNAL HEAD, PEDESTRIAN                                      |          |          |
| SIGNAL POST  |          |          |
| MAST ARM ASSEMBLY AND POLE, STEEL                            |          |          |
| MAST ARM ASSEMBLY AND POLE, ALUMINUM                         |          |          |
| COMBINATION MAST ARM ASSEMBLY AND POLE, STEEL WITH LUMINAIRE |          |          |
| UNIT DUCT  |          |          |
| COMMON TRENCH  |          |          |
| HANDHOLE   |          |          |
| HEAVY DUTY HANDHOLE  |          |          |
| DOUBLE HANDHOLE  |          |          |
| G.S. CONDUIT IN TRENCH (T) OR PUSHED (P)                     |          |          |
| PEDESTRIAN PUSHBUTTON DETECTOR                               |          |          |
| DETECTOR LOOP  |          |          |

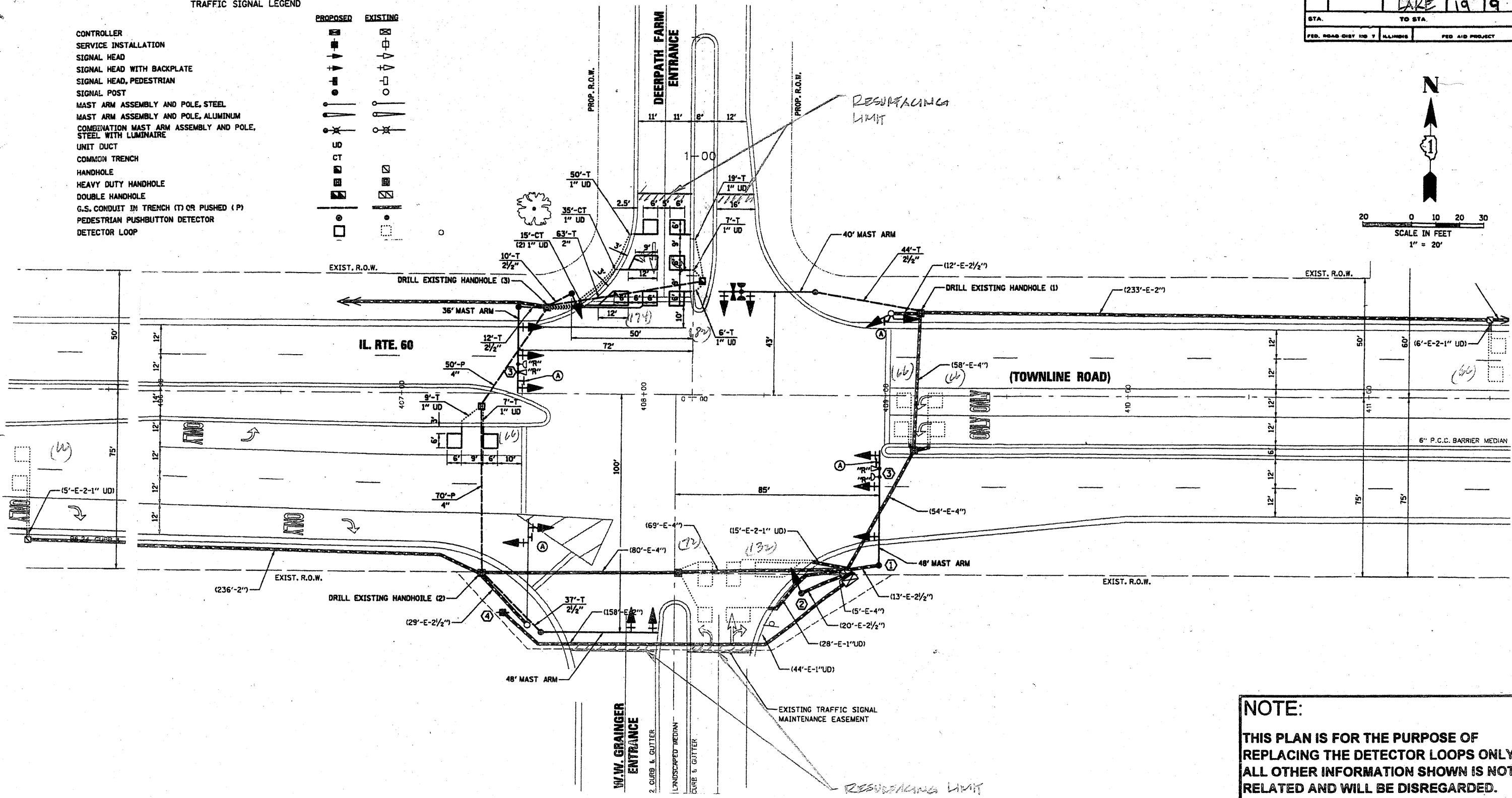
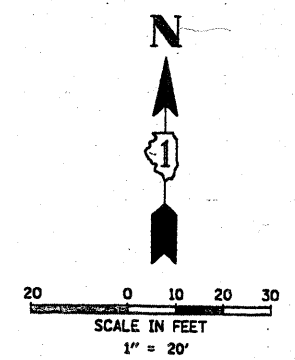

**REPLACE ALL DETECTOR LOOPS AS SHOWN**  
(WITHIN THE RESURFACING LIMITS)

CODE NO.	QUANTITY	UNIT	ITEM
80500600	790	Foot	Detector Loop Replacement

REVISIONS	
NAME	DATE

**NOTE:**  
THIS PLAN IS FOR THE PURPOSE OF REPLACING THE DETECTOR LOOPS ONLY. ALL OTHER INFORMATION SHOWN IS NOT RELATED AND WILL BE DISREGARDED.

ILLINOIS DEPARTMENT OF TRANSPORTATION  
**DETECTOR LOOP REPLACEMENT**  
*IL. RTE. 60 @ W.W. GRAINGER*  
SCALE: NONE  
DATE: *Jan. 3, 2007*  
DRAWN BY: JHE  
DESIGNED BY: JHE  
CHECKED BY: DAD