

F.A.P. RTE.	SECTION	COUNTY	TOTAL SHEETS	SHEET NO.
348	3128-Z-B-1	COOK	35	10
STA.	TO STA.			
FED. ROAD DIST. NO.	ILLINOIS FED. AID PROJECT			

TRAFFIC SIGNAL LEGEND

	PROPOSED	EXISTING
CONTROLLER		
SERVICE INSTALLATION		
SIGNAL HEAD		
SIGNAL HEAD WITH BACKPLATE		
SIGNAL HEAD, PEDESTRIAN		
SIGNAL POST		
MAST ARM ASSEMBLY AND POLE, STEEL		
MAST ARM ASSEMBLY AND POLE, ALUMINUM		
COMMON TRENCH		
UNIT DUCT		
HANDHOLE		
HEAVY DUTY HANDHOLE		
DOUBLE HANDHOLE		
G.S. CONDUIT IN TRENCH OR PUSHED		
PEDESTRIAN PUSHBUTTON DETECTOR		
DETECTOR LOOP		
CAST IRON JUNCTION BOX		
EMERGENCY VEHICLE SYSTEM DETECTOR		
CONFIRMATION BEACON		
SIGNAL HEAD OPTICALLY PROGRAMMED		
CONDUIT SPLICE		
WOOD POLE		
RACEWAY FOR MAGNETIC DETECTOR, TYPE I OR TYPE II		
VEHICLE DETECTOR, NON COMPENSATED MAGNETIC TYPE		
RAILROAD CONTROL CABINET		

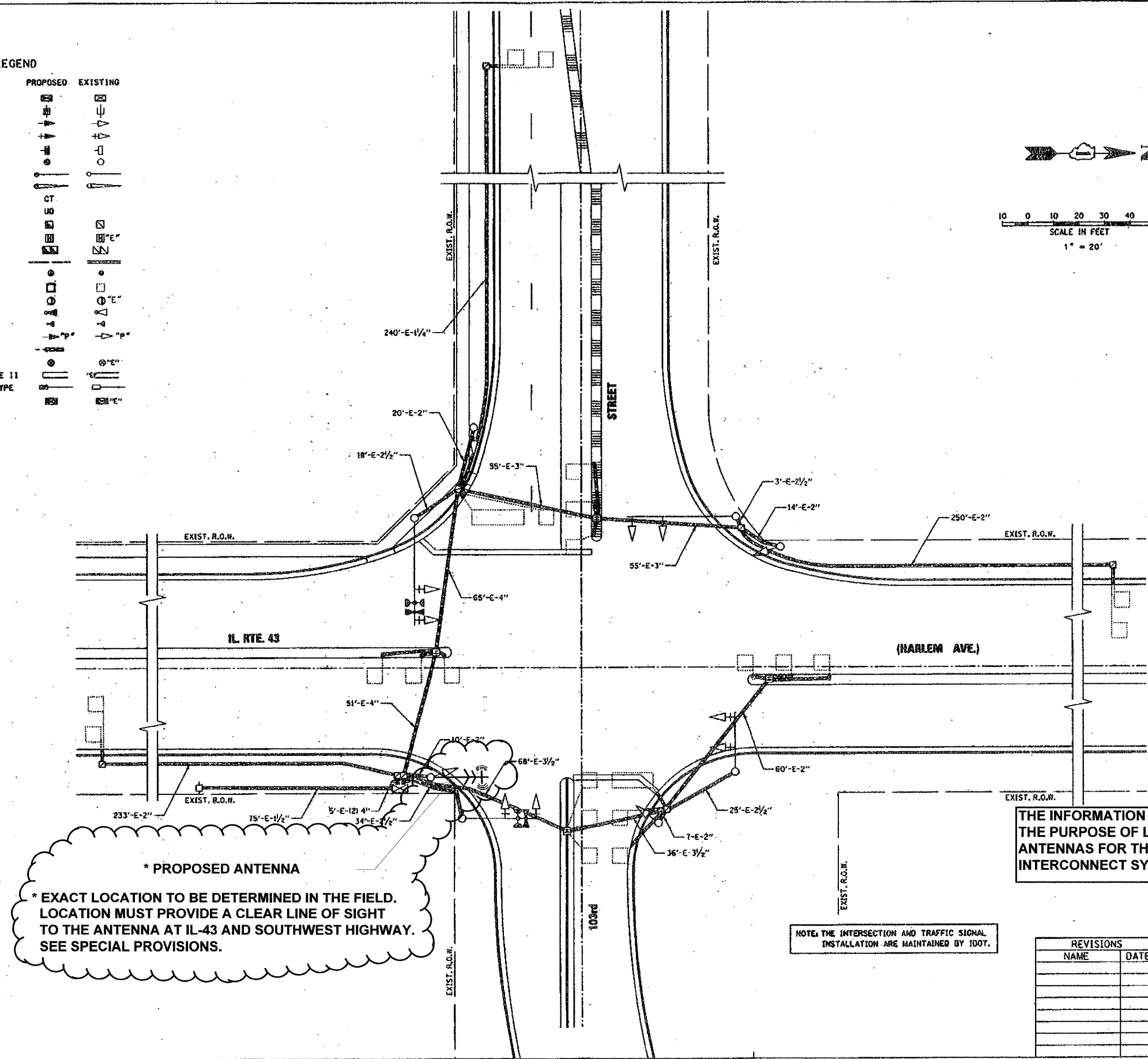
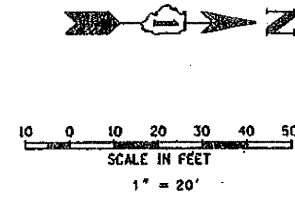

* PROPOSED ANTENNA
 * EXACT LOCATION TO BE DETERMINED IN THE FIELD. LOCATION MUST PROVIDE A CLEAR LINE OF SIGHT TO THE ANTENNA AT IL-43 AND SOUTHWEST HIGHWAY. SEE SPECIAL PROVISIONS.

THE INFORMATION SHOWN HERE IS FOR THE PURPOSE OF LOCATING AND INSTALLING ANTENNAS FOR THE TEMPORARY WIRELESS INTERCONNECT SYSTEM ONLY.

NOTE: THE INTERSECTION AND TRAFFIC SIGNAL INSTALLATION ARE MAINTAINED BY IDOT.

REVISIONS	
NAME	DATE

ILLINOIS DEPARTMENT OF TRANSPORTATION
TRAFFIC SIGNAL MODIFICATION PLAN
 IL RTE. 43 (HARLEM AVENUE) AND 103rd STREET
 SCALE 1" = 20'
 DATE 9-25-98
 DRAWN BY FPB / FCP
 CHECKED BY ABR / GMZ