

STATE OF ILLINOIS
DEPARTMENT OF TRANSPORTATION

Benchmark: Survey Monument (Bronze Disk) located on the concrete sidewalk NE side of bridge for the commuter parking lot on Old Willow Road. Sta. 125+91 offset 46 Rt Elev. 598.39

Existing Structure: S.N. 016-0540 built in 1976, nine span steel continuous girders and stringers with 8" reinforced concrete deck and 1/2" bituminous overlay. The substructure consists of 8 piers supported on spread footing or piles and vaulted abutments supported on piles. The structure measures 1,529.5 ft. ϕ to ϕ Bearings at Abutments and 70.0 ft. out to out deck. Traffic is to be maintained utilizing stage construction. One lane for each direction will be provided.

Salvage: None

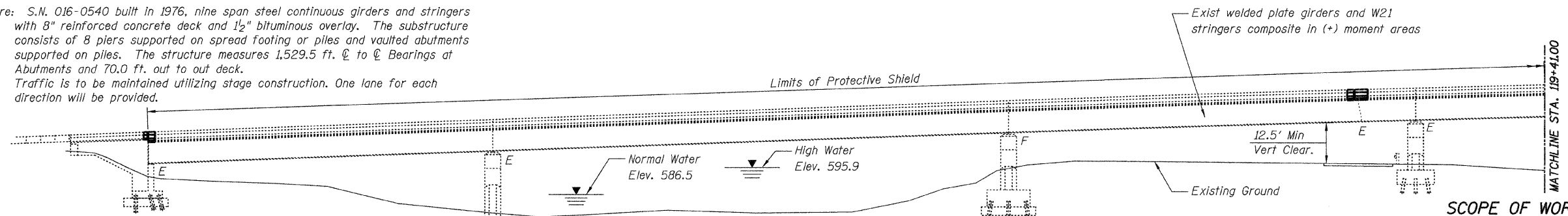

DESIGN STRESSES

EXISTING CONSTRUCTION

- $f_c = 1,000$ psi (abutment)
- $f_c = 1,200$ psi (deck)
- $f_c = 1,400$ psi (curb, parapet & appr. slab)
- $f_s = 20,000$ psi (reinforcement)
- $f_s = 20,000$ psi (M189)
- $f_s = 27,000$ psi (M222, painted)
- $f_s = 27,000$ psi (M223)

NEW CONSTRUCTION

- $f'_c = 3,500$ psi
- $f_y = 60,000$ psi

SCOPE OF WORK

1. Install Protective Shield
2. Remove HMA Surface
3. Hydroscarify Deck Surface and Approach Spans
4. Deck Full Depth Repairs and Concrete Parapets repairs
5. Reconstruct Transverse Joints
6. Replace Bearings at North Abutment
7. Place Latex Concrete Overlay
8. Sawcut Groove Deck Surface
9. Substructure Repairs
10. Rehab Drainage Systems at Scuppers
11. Steel Repairs performed under separate Contract, except as noted on the plans

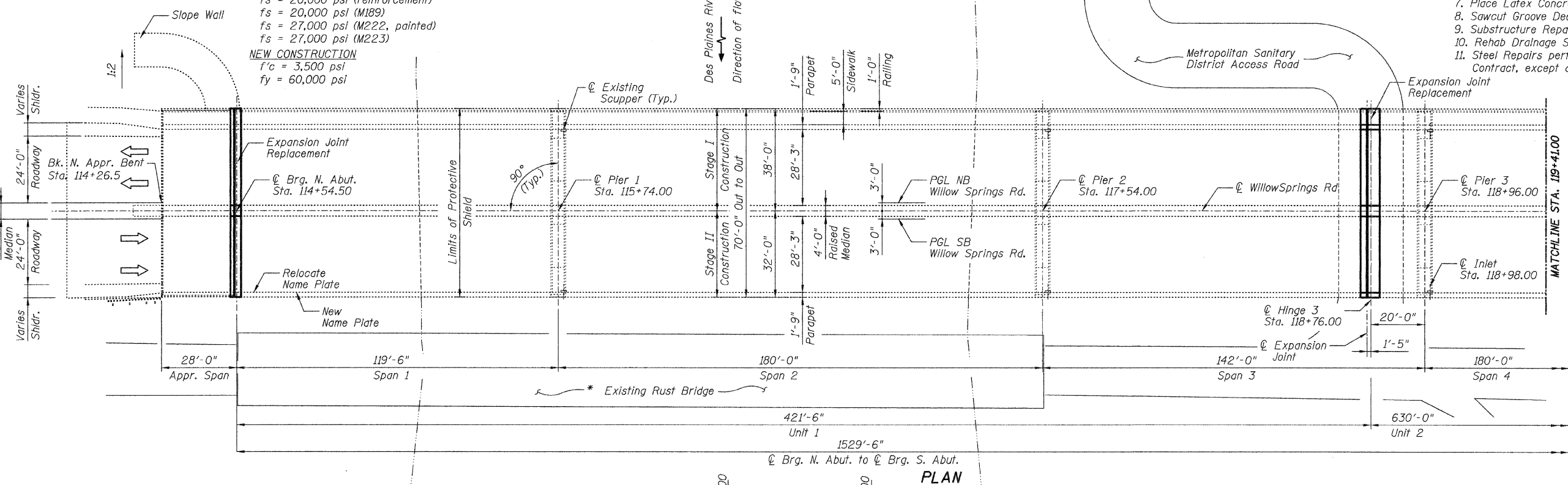

LOADING HS-20-44

No future wearing surface allowance

DESIGN SPECIFICATIONS

2002 AASHTO Standard Specifications

* Existing Rust Bridge is posted to 10 ton weight limit

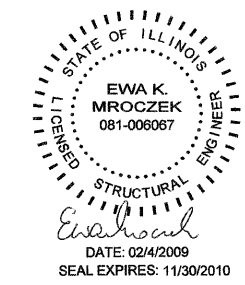
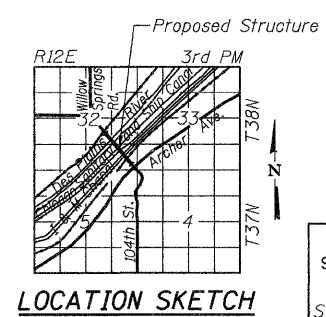
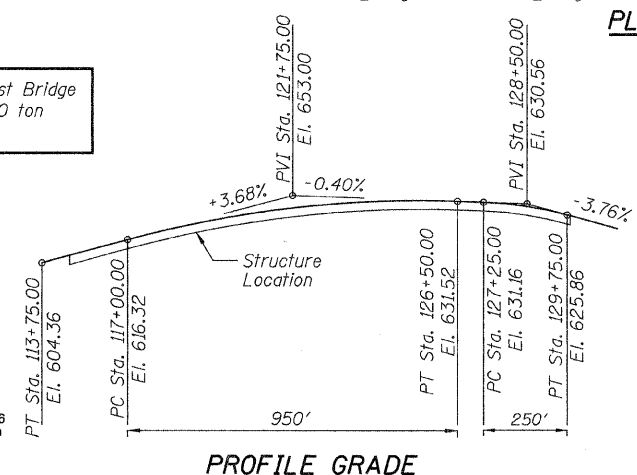

GENERAL PLAN AND ELEVATION I
FAU 2697 WILLOW SPRINGS ROAD
OVER DES PLAINES RIVER,
CHICAGO SANITARY & SHIP CANAL,
ILLINOIS AND MICHIGAN CANAL,
AND ICG RAILROAD
COOK COUNTY
S.N. 016-0540

DESIGNED	B. Sauter
CHECKED	E. Mroczek
DRAWN	R. Danley
CHECKED	B. Sauter

CG **Ciorba Group, Inc.**
CONSULTING ENGINEERS
5507 North Cumberland Avenue, Suite 402 Chicago, Illinois 60656
Tel. 773.775.4009 Fax 773.775.4014 Email chicago@ciorba.com

SHEET NO. S-1	F.A.U. RTE.	SECTION	COUNTY	TOTAL SHEETS	SHEET NO.
	2697	142 B-1-I	COOK	48	15
S-27 SHEETS			CONTRACT NO. 60D89		
FED. ROAD DIST. NO.		ILLINOIS	FED. AID PROJECT		

02/14/2009
 02/14/2009
 NA PROJ: 3329, 3329, 30, Design, Structural, CAD, Shts, Concrete, Repairs, 3329, 30, 01, GP, sht