

\*NOTE:  
 MEDIAN REPAIR AT VARIOUS LOCATIONS BETWEEN STA. 113+00 & STA. 125+00,  
 TO BE DETERMINED BY THE RESIDENT ENGINEER

- PAVEMENT MARKING LEGEND
- ① 6" WHITE LINE
  - ② WHITE LETTERS & SYMBOLS
  - ③ 24" WHITE LINE
  - ④ 4" SOLID DOUBLE YELLOW LINE
  - ⑤ 12" YELLOW DIAGONAL LINE
  - ⑥ 4" WHITE SKIP DASH LANE LINE
  - ⑦ 4" YELLOW SKIP DASH CENTER LINE
  - ⑧ 4" YELLOW SOLID SINGLE MEDIAN LINE
  - ⑨ 16" WHITE LINE
  - ⑩ 8" WHITE LINE
  - ⑪ 12" WHITE LINE
  - ⑫ 6" WHITE DOTTED EXTENSIONS
  - ⑬ WHITE TWO WAY LEFT TURN

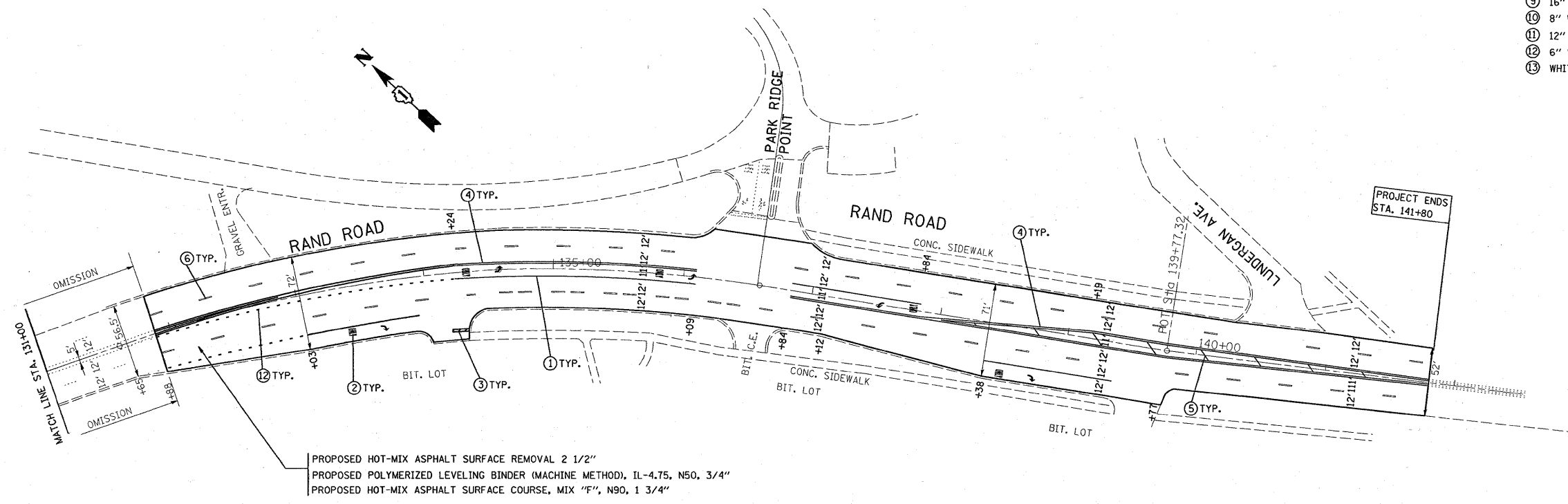

PROPOSED HOT-MIX ASPHALT SURFACE REMOVAL 2 1/2"  
 PROPOSED POLYMERIZED LEVELING BINDER (MACHINE METHOD), IL-4.75, N50, 3/4"  
 PROPOSED HOT-MIX ASPHALT SURFACE COURSE, MIX "F", N90, 1 3/4"

FILE NAME =	USER NAME = obreuh	DESIGNED -	REVISED -	<b>STATE OF ILLINOIS DEPARTMENT OF TRANSPORTATION</b>	<b>ROADWAY &amp; PAVEMENT MARKING PLAN U.S. ROUTE 12 (RAND RD.) 3RD AVE. TO LUNDERGAN AVE.</b>	F.A.U. RTE.	SECTION	COUNTY	TOTAL SHEETS	SHEET NO.	
ca:\pw_work\pw\dot\obreuh\dms89779\dl1944-shit-plan.dgn		DRAWN -	REVISED -			3523	2008-021 RS	COOK	30	14	
PLOT SCALE = 50,0000 "/> <td></td> <td>CHECKED -</td> <td>REVISED -</td> <td colspan="6" style="text-align: center;">CONTRACT NO. 60E51</td>		CHECKED -	REVISED -			CONTRACT NO. 60E51					
PLOT DATE = 1/26/2009		DATE -	REVISED -			SCALE:	SHEET NO. OF SHEETS	STA. TO STA.	FED. ROAD DIST. NO.	ILLINOIS FED. AID PROJECT	