

LEGEND

- ① INLET TO BE REMOVED (SEE NOTE 3)
- ② MANHOLE TO BE REMOVED (SEE NOTE 3)
- ③ CATCH BASIN TO BE REMOVED (SEE NOTE 3)
- ④ VALVE VAULTS TO BE ADJUSTED (SEE NOTE 3)
- ⑤ NOT USED
- ⑥ UTILITY POLE TO BE RELOCATED BY OTHERS
- ⑦ UTILITY RISER TO BE RELOCATED BY OTHERS
- ⑧ NOT USED
- ⑨ FIRE HYDRANT TO BE MOVED
- ⑩ SANITARY MANHOLES TO BE ADJUSTED (SEE NOTE 3)
- ⑪ MANHOLES TO BE ADJUSTED (SEE NOTE 3)

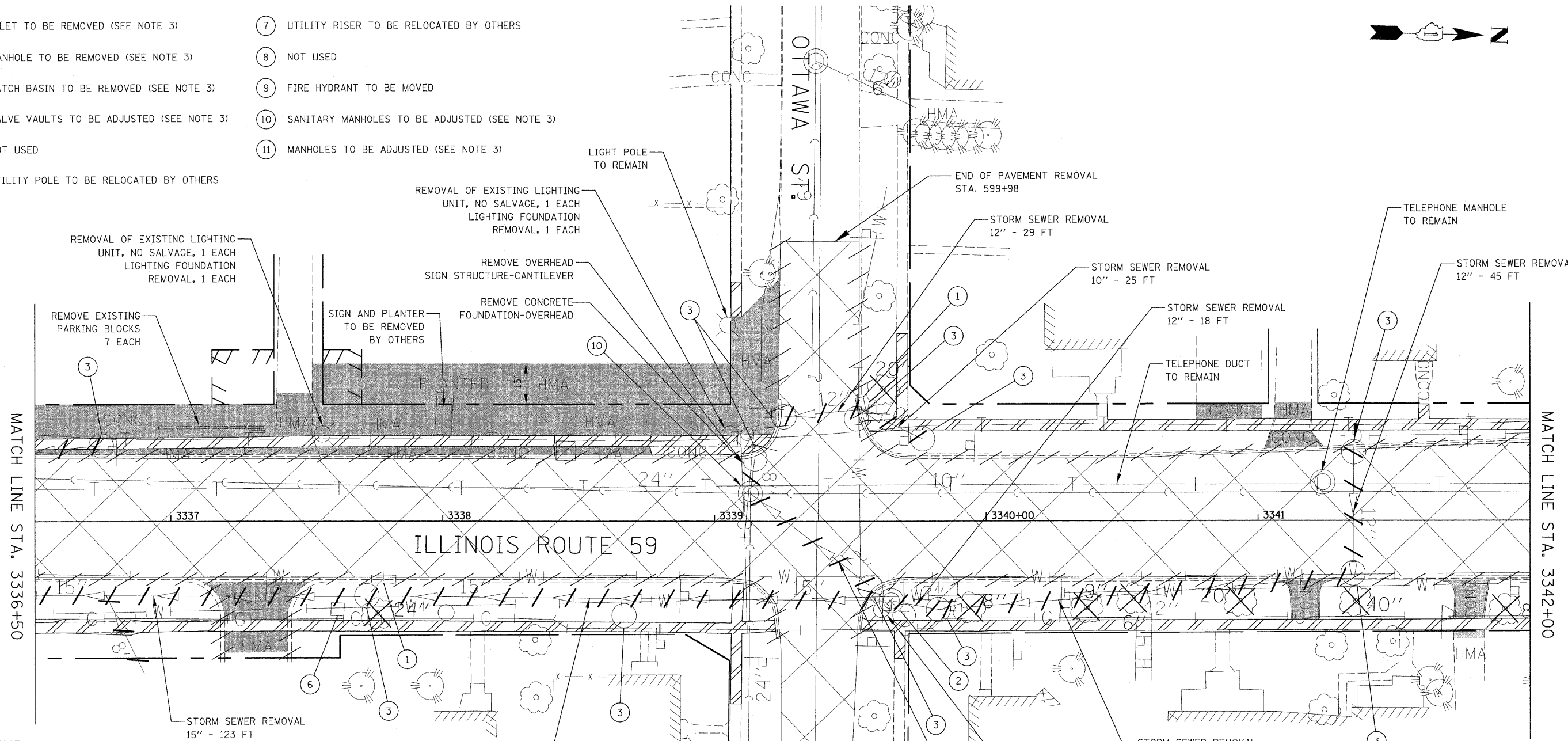
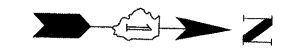

LEGEND

- 8" TREE REMOVAL (DIA.)
- TREE TO REMAIN (SEE SCHEDULE OF QUANTITIES FOR LOCATIONS OF TREE TRUNK PROTECTION, TREE PRUNING AND TREE ROOT PRUNING)
- PAVEMENT REMOVAL
- DRIVEWAY PAVEMENT REMOVAL (EXISTING CONCRETE SURFACE)
- DRIVEWAY PAVEMENT REMOVAL (EXISTING HOT-MIX ASPHALT SURFACE)
- SIDEWALK REMOVAL
- EXISTING AGGREGATE DRIVEWAY TO BE REMOVED (PAID FOR AS EARTH EXCAVATION)
- CURB AND GUTTER REMOVAL
- STORM SEWER REMOVAL
- INDICATES GAS STATION PROPERTY WITH BUILDING NO.1, CANOPY, AND GAS PUMPS TO BE REMOVED. SEE SPECIAL PROVISIONS FOR DETAILS
- REMOVE EXISTING BRICK PAVERS

NOTES

1. FOR WATER MAIN AND SANITARY SEWER REMOVAL INFORMATION, SEE CORRESPONDING WATER MAIN PLAN AND PROFILE.
2. QUANTITIES FOR TREE TRUNK PROTECTION, TREE PRUNING, ROOT PRUNING AND TREE REMOVAL HAVE BEEN INCLUDED IN THE CONTRACT. SEE SCHEDULE OF QUANTITIES FOR LOCATIONS.
3. SOME MANHOLES, CATCH BASINS, INLETS, AND VALVE VAULTS REQUIRE TEMPORARY ADJUSTMENT PRIOR TO THEIR REMOVAL OR FINAL ADJUSTMENT TO MEET PROPOSED GRADES. SEE EROSION CONTROL PLANS FOR THE REQUIRED ADDITIONAL ADJUSTMENTS.

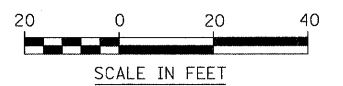

FILE NAME =	USER NAME = #USER#	DESIGNED - PJO	REVISED -	STATE OF ILLINOIS DEPARTMENT OF TRANSPORTATION	REMOVAL PLANS	F.A. RTE. 338	SECTION 113 N-2	COUNTY WILL	TOTAL SHEETS 260	SHEET NO. 85	
#FILE#		DRAWN - GS	REVISED -			CONTRACT NO. 60E73					
	PLOT SCALE = #SCALE#	CHECKED - JCM	REVISED -			FED. ROAD DIST. NO. [ILLINOIS] FAP 338 (IL RTE. 59)					
	PLOT DATE = #DATE#	DATE - JANUARY 16, 2009	REVISED -			SCALE: AS SHOWN SHEET NO. 3 OF 7 SHEETS STA. 3336+50 TO STA. 3342+00					