

PLAN	SURVEYED	DATE
	PLOTTED	BY
	GRADES CHECKED	
	STRUCTURE NOTATIONS OK'D	
	NOTE BOOK NO.	
	CADD FILE NAME	

PROFILE	SURVEYED	DATE
	PLOTTED	BY
	GRADES CHECKED	
	STRUCTURE NOTATIONS OK'D	
	NOTE BOOK NO.	
	CADD FILE NAME	

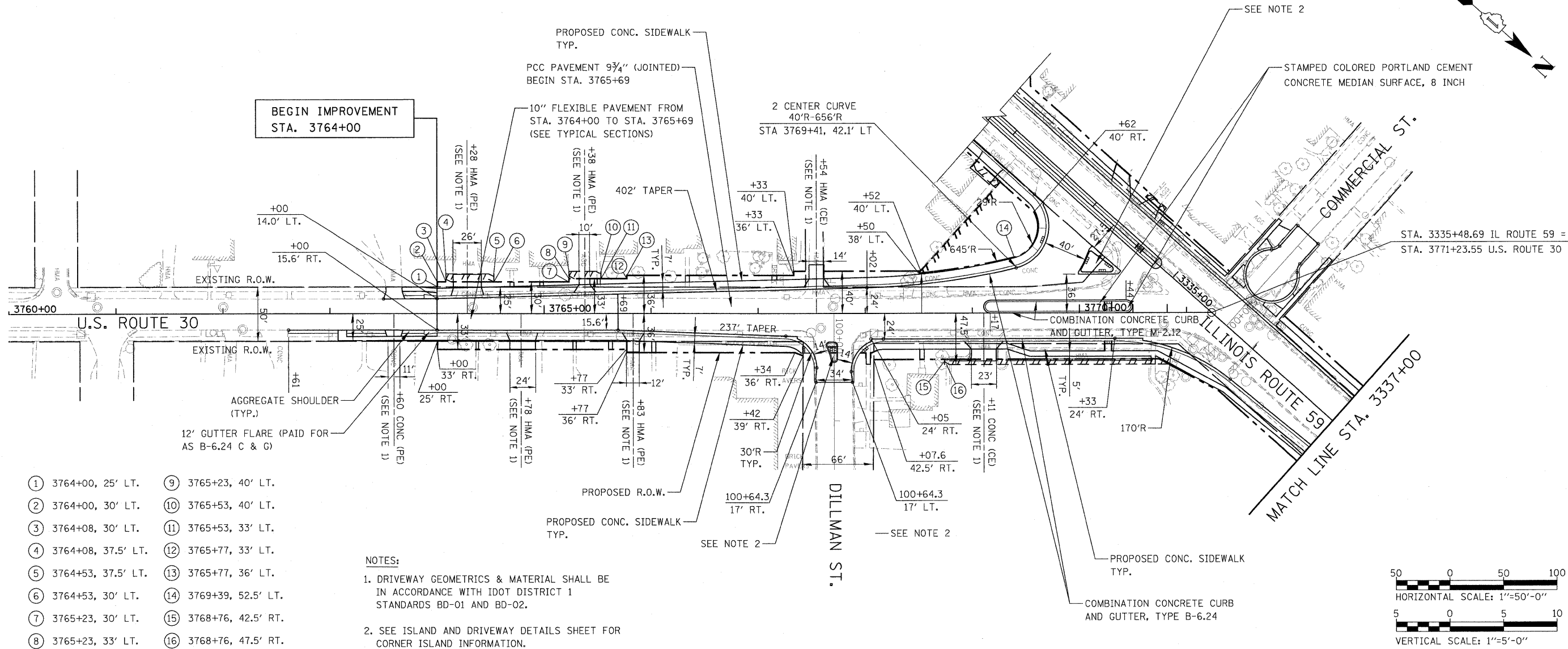

- ① 3764+00, 25' LT.
- ② 3764+00, 30' LT.
- ③ 3764+08, 30' LT.
- ④ 3764+08, 37.5' LT.
- ⑤ 3764+53, 37.5' LT.
- ⑥ 3764+53, 30' LT.
- ⑦ 3765+23, 30' LT.
- ⑧ 3765+23, 33' LT.
- ⑨ 3765+23, 40' LT.
- ⑩ 3765+53, 40' LT.
- ⑪ 3765+53, 33' LT.
- ⑫ 3765+77, 33' LT.
- ⑬ 3765+77, 36' LT.
- ⑭ 3769+39, 52.5' LT.
- ⑮ 3768+76, 42.5' RT.
- ⑯ 3768+76, 47.5' RT.

**NOTES:**

- DRIVEWAY GEOMETRICS & MATERIAL SHALL BE IN ACCORDANCE WITH IDOT DISTRICT 1 STANDARDS BD-01 AND BD-02.
- SEE ISLAND AND DRIVEWAY DETAILS SHEET FOR CORNER ISLAND INFORMATION.

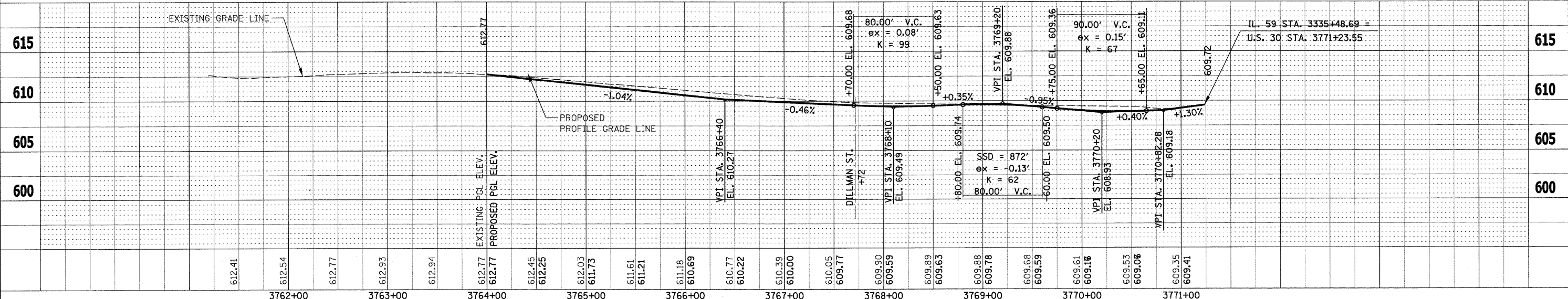
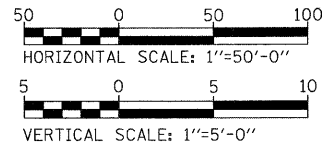

FILE NAME =	USER NAME = #USER#	DESIGNED - PJO	REVISED -	<b>STATE OF ILLINOIS DEPARTMENT OF TRANSPORTATION</b>	<b>U.S. ROUTE 30 PLAN &amp; PROFILE</b>	F.A. RTE. 338	SECTION 113 N-2	COUNTY WILL	TOTAL SHEETS 260	SHEET NO. 93	
#FILEL#	PLDT SCALE = #SCALE#	DRAWN - RTA	REVISED -			SCALE: AS SHOWN SHEET NO. 1 OF 1 SHEETS STA. 3764+00 TO STA. 3771+24		CONTRACT NO. 60E73			
	PLDT DATE = #DATE#	CHECKED - JCM	REVISED -			FED. ROAD DIST. NO. ILLINOIS FAP 338 (IL RTE. 59)					
		DATE - JANUARY 16, 2009	REVISED -								