

**NOTES:**  
SEE PRECEDING DRAWING SHEET FOR NOTES.

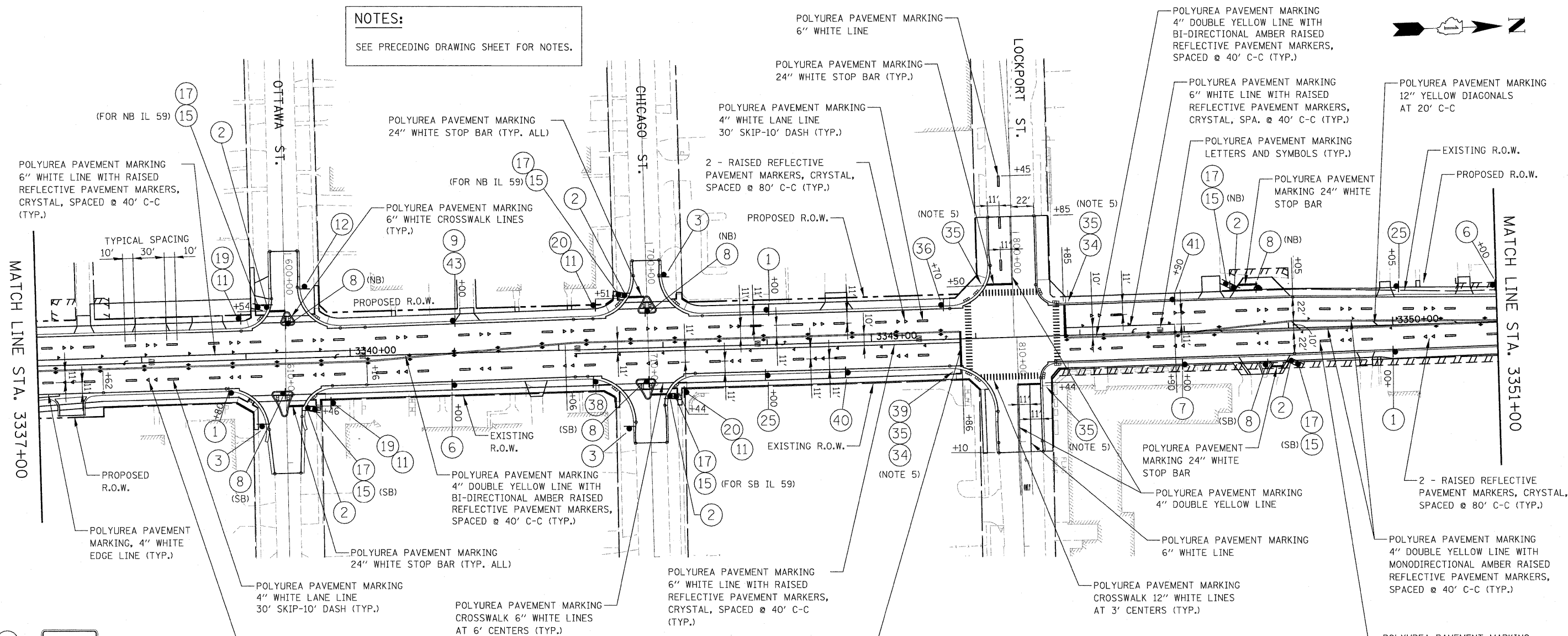

①		R2-1-3036	⑦	M3-4-2412 WEST NORTH M3-1-2412	⑪	IL ROUTE 59 D3 30" X 8"	⑳	CHICAGO ST D3 20" X 8"	⑳		R10-11b-24	⑳		EXISTING SPECIAL-2430	④①		EXISTING D4-1101-3018
②		R1-1-30	⑧	M1-1100-24  M1-4-24	⑫		R5-2-24	⑫		S4-1100-2448	⑳		EXISTING SPECIAL-2430	④②		EXISTING M6-1-2115 WHITE ON GREEN	
③		R12-1-2430	⑨	NOTE: USE R3-2-30 FOR CROSS-STREETS/DRIVES, USE R3-2-36 FOR IL 59/U.S. 30	⑮		R5-1-30	⑮		S4-1100-2448	⑳		EXISTING SPECIAL-2430	④③		SPECIAL-2430 BLACK ON WHITE W/ BLUE & RED	
④		W16-9P-2412	⑬	M3-2-2412 EAST SOUTH M3-3-2412	⑰		R3-5R-2430	⑰		S4-1100-2448	⑳		EXISTING SPECIAL-2430	④④		M5-2L-2115	
⑤		W16-9P-2412	⑭	M1-4-24  M1-1100-24	⑱		R3-5R-2430	⑱		S4-1100-2448	⑳		EXISTING SPECIAL-2430	④⑤		M5-2L-2115	
⑥		W16-9P-2412	⑯	M5-2L-2115  M6-3-2115	⑲		R3-5R-2430	⑲		S4-1100-2448	⑳		EXISTING SPECIAL-2430	④⑥		M5-2L-2115	

EXISTING SIGNS ARE LOCATED ON THE WEST SIDE OF ILLINOIS ROUTE 59

