

TYPICAL ENTRANCE/EXIT RAMP COMBINATION PAVEMENT MARKINGS

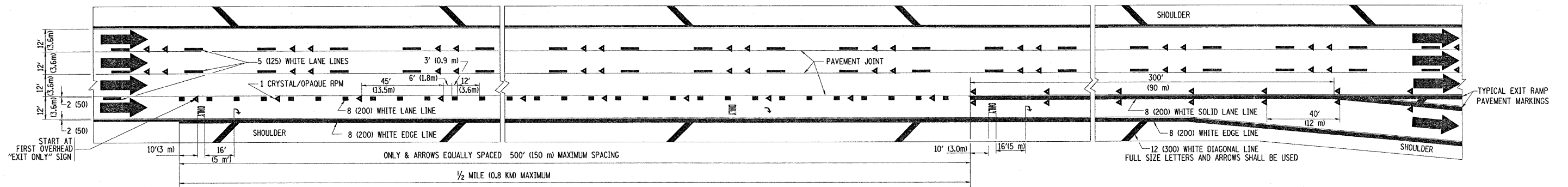

TYPICAL EXIT ONLY LANE PAVEMENT MARKINGS

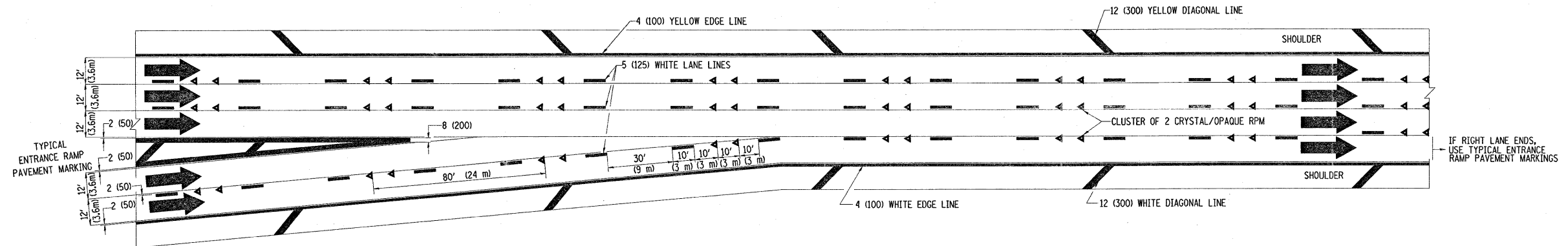

TYPICAL TWO LANE ENTRANCE RAMP PAVEMENT MARKINGS

FILE NAME =	USER NAME = galbannb	DESIGNED - D.W.S.	REVISED - A.H. 03-96	STATE OF ILLINOIS DEPARTMENT OF TRANSPORTATION	MULTI-LANE FREEWAY PAVEMENT MARKING DETAILS		F.A.I. RTE. 290	SECTION 2008-055 1	COUNTY COOK	TOTAL SHEETS 53	SHEET NO. 50	
ct:\pwork\VPWIDOT\GALBANNB\dms88502\01-45td.dgn	PLLOT SCALE = 50.00000' / IN.	DRAWN -	REVISED - D.W.S. 07-96		SCALE: NONE	SHEET NO. 2 OF 2 SHEETS	STA. TO STA.	FED. ROAD DIST. NO. 1 [ILLINOIS] FED. AID PROJECT				
	PLLOT DATE = 12/18/2008	CHECKED -	REVISED - J.A.F. 02-06		TC-12 CONTRACT NO. GOF 10							
		DATE - 01-90	REVISED - S.P.B. 01-07									