

**SCHEDULE OF QUANTITIES**

ILLINOIS ROUTE 131 (GREEN BAY ROAD) AND 10th STREET

QUANT.	UNIT	ITEM
1.	0.20	L.SUM TRAFFIC CONTROL AND PROTECTION, STANDARD 701606-06
2.	0.20	L.SUM TRAFFIC CONTROL AND PROTECTION, STANDARD 701701-06
3.	27.5	SQ.FT. SIGN PANEL - TYPE 2
4.	52	FOOT CONDUIT IN TRENCH, 2-1/2" DIA., GALVANIZED STEEL
5.	52	FOOT TRENCH AND BACKFILL FOR ELECTRICAL WORK
6.	1	EACH MAINTENANCE OF EXISTING TRAFFIC SIGNAL INSTALLATION
7.	1	EACH FULL-ACTUATED CONTROLLER
* 8.	98	FOOT ELECTRIC CABLE IN CONDUIT, SIGNAL, NO. 14 3C
9.	820	FOOT ELECTRIC CABLE IN CONDUIT, SIGNAL, NO. 14 5C
10.	29	FOOT ELECTRIC CABLE IN CONDUIT, SERVICE, NO. 6 2C
11.	29	FOOT ELECTRIC CABLE IN CONDUIT, GROUNDING, NO. 6 1C
* 12.	98	FOOT ELECTRIC CABLE IN CONDUIT, NO. 20 3C, TWISTED, SHIELDED
13.	2	EACH TRAFFIC SIGNAL POST, GALVANIZED STEEL, 14 FT
14.	2	EACH TRAFFIC SIGNAL POST, GALVANIZED STEEL, 16 FT
15.	2	EACH STEEL MAST ARM ASSEMBLY AND POLE, 28 FT
16.	27	FOOT CONCRETE FOUNDATION, TYPE E, 30" DIAMETER
17.	2	EACH DRILL EXISTING HANDHOLE
18.	6	EACH SIGNAL HEAD, L.E.D., 1-FACE, 3-SECTION, MAST ARM MOUNTED
19.	2	EACH SIGNAL HEAD, L.E.D., 1-FACE, 3-SECTION, BRACKET MOUNTED
20.	2	EACH SIGNAL HEAD, L.E.D., 1-FACE, 5-SECTION, BRACKET MOUNTED
21.	2	EACH SIGNAL HEAD, L.E.D., 1-FACE, 5-SECTION, MAST ARM MOUNTED
22.	8	EACH TRAFFIC SIGNAL BACKPLATE, LOUVERED, ALUMINIUM
* 23.	1	EACH LIGHT DETECTOR
24.	330	FOOT REMOVE ELECTRIC CABLE FROM CONDUIT
25.	1	EACH REMOVE EXISTING TRAFFIC SIGNAL EQUIPMENT
26.	2	EACH REMOVE EXISTING CONCRETE FOUNDATION
27.	1	EACH SERVICE INSTALLATION - POLE MOUNTED
28.	1	EACH UNINTERRUPTIBLE POWER SUPPLY (UPS)

\*100% COST TO THE CITY OF WAUKEGAN

**CABLE PLAN LEGEND**

EXISTING	PROPOSED	DESCRIPTION
		8" (200mm) TRAFFIC SIGNAL SECTION
		12" (300mm) TRAFFIC SIGNAL SECTION
		12" (300mm) PEDESTRIAN SIGNAL SECTION
		CONTROLLER CABINET
		SERVICE INSTALLATION
		TELEPHONE
		VEHICLE DETECTOR, INDUCTION LOOP
		MAGNETIC DETECTOR
		EMERGENCY VEHICLE LIGHT DETECTOR
		CONFIRMATION BEACON
		PUSHBUTTON DETECTOR
		2 DENOTES NUMBER OF CONDUCTORS. ALL CABLE NO. 14 EXCEPT AS INDICATED. ALL LOOP DETECTOR CABLE TO BE SHIELDED.
		1 GROUND CABLE IN CONDUIT NO.6 SOLID COPPER (GREEN)
		35 FIBER OPTIC CABLE IN CONDUIT NO. 62.5/125 MM12F SM24F
		SIGNAL FACE WITH BACKPLATE. "P" INDICATES PROGRAMMED HEAD
		RAILROAD CONTROL CABINET
		ILLUMINATED SIGN "NO LEFT TURN"
		ILLUMINATED SIGN "NO RIGHT TURN"
		H/C GROUND ROD AT HANDHOLE (H), DOUBLE HANDHOLE (H), OR CONTROLLER (C)
		P GROUND ROD AT POST (P) OR MAST ARM POLE (MA)
		S GROUND ROD AT ELECTRIC SERVICE INSTALLATION
		UPS UNINTERRUPTIBLE POWER SUPPLY (UPS)

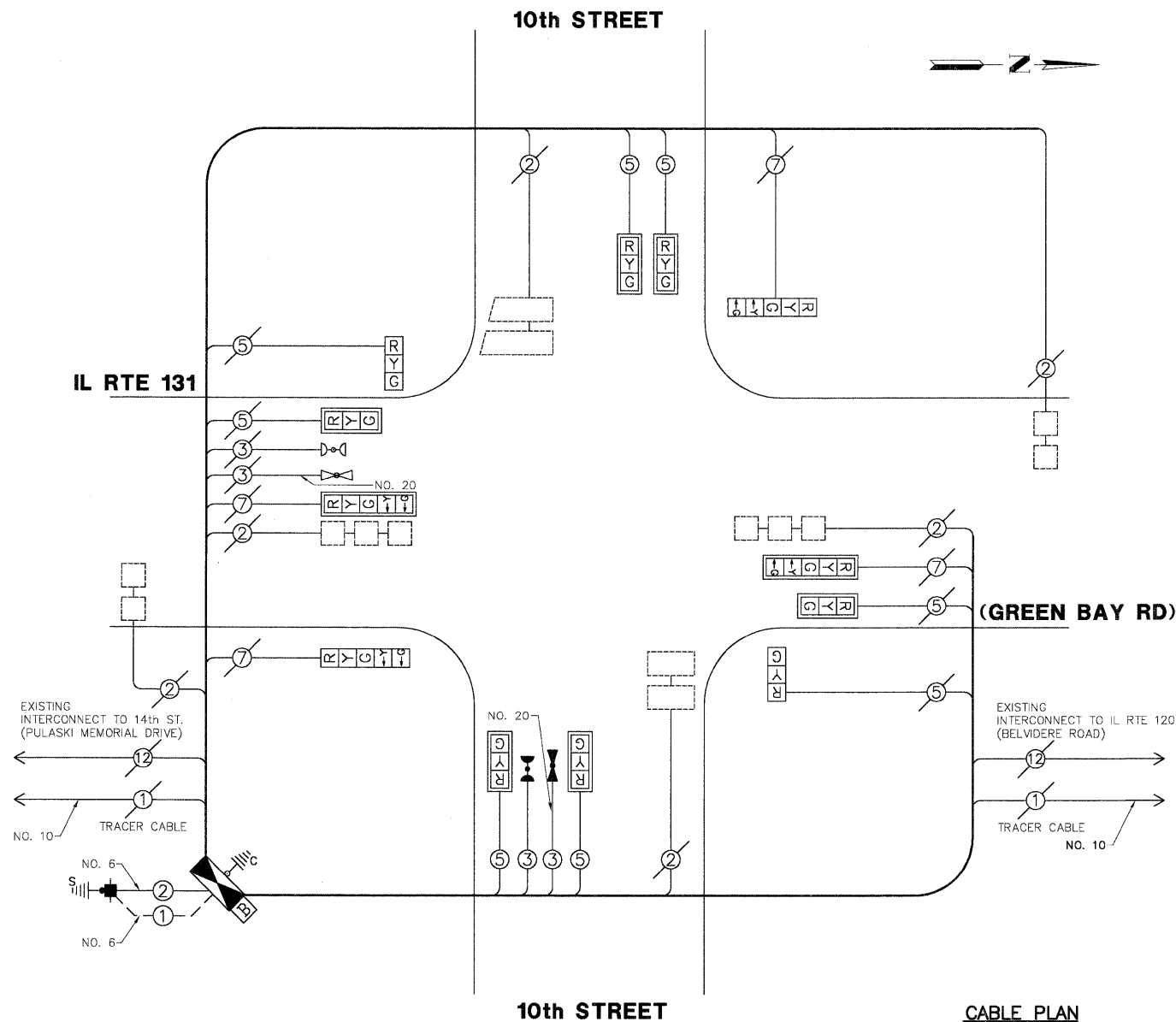

**EXISTING AND PROPOSED CONTROLLER SEQUENCE**

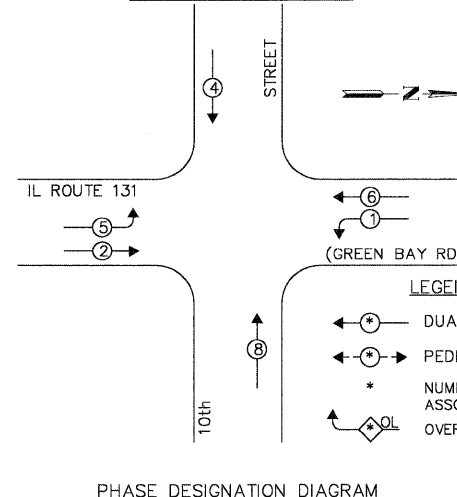

**EXISTING AND PROPOSED EMERGENCY VEHICLE PREEMPTION SEQUENCE**

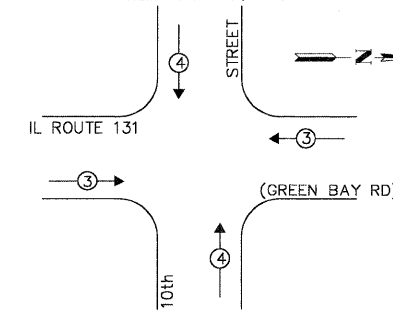

EMERGENCY VEHICLE PREEMPTOR	EXISTING	PROPOSED
EMERGENCY VEHICLE PREEMPTOR	3	4
MOVEMENT	—	

THE TRAFFIC SIGNAL CONTROL EQUIPMENT FOR THIS PROJECT SHALL BE "NTCIP" COMPLIANT.

TYPE	NO LAMPS	INCAND.	L.E.D.	% OPERATION	TOTAL WATTAGE
SIGNAL (RED)	12	135	17	0.50	102.0
SIGNAL (YELLOW)	12	135	25	0.25	75.0
SIGNAL (GREEN)	12	135	15	0.25	45.0
ARROW	8	135	12	0.10	9.6
PED.SIGNAL	-	90	25	1.00	-
CONTROLLER	1	-	100	1.00	100.0
LUMINAIRE	-	-	250	0.50	-
L.E.D. ST. NAME SIGN	-	-	64	0.50	-
VIDEO SYSTEM	-	-	150	1.00	-
BATTERY BACKUP	1	-	25	1.00	25.0
<b>TOTAL =</b>					<b>356.6</b>

FOUNDATION (DEPTH)	(FT.)	CABLE SLACK	(FT.)	VERTICAL	(FT.)
TYPE A - POST	4	HANDHOLE	6.5	ALL FOUNDATIONS	3.5
TYPE D - CONTROLLER	4	DOUBLE HANDHOLE	13	MAST ARM (L) POLE	20'+L-2'
TYPE E - M.ARM POLE	10	SIGNAL POST	2	BRACKET MOUNTED	13
30" (16'-30')	10	CONTROLLER CAB.	1	PED. PUSHBUTTON	4
30" (30'-40')	13.5	FIBER OPTIC	13.5	ELECTRIC SERVICE	13.5
36" (40'-48')	13	ELECTRIC SERVICE	1	SERVICE TO GROUND	13.5
36" (50'-55')	15	GROUND CABLE	1	POST MOUNTED	6

ENERGY COSTS - BILLED TO: CITY OF WAUKEGAN  
 (ADDRESS) 100 N. W.L.K. JR. AVENUE  
 (ADDRESS) WAUKEGAN, IL  
 ENERGY SUPPLY - CONTACT: NEW BUSINESS  
 PHONE: 1-866-639-3552  
 COMPANY: COMED