

PROFILE SURVEYED BY DATE
 GRADES CHECKED
 B.M. NOTED
 STRUCTURE NOTATIONS CRP
 N:\dot\1080040\Task 5-EE Nor-west Cook State\g\Prof\io\SCH2_Tmp-US14.dgn
 PLAN SURVEYED BY DATE
 NOTE BOOK NO.
 NO. OF WAY CHECKED
 CAD FILE NAME

CHRISTOPHER B. BURKE ENGINEERING LTD.
 9575 West Higgins Road, Suite 600
 Rosemont, Illinois 60018
 (817) 823-0500

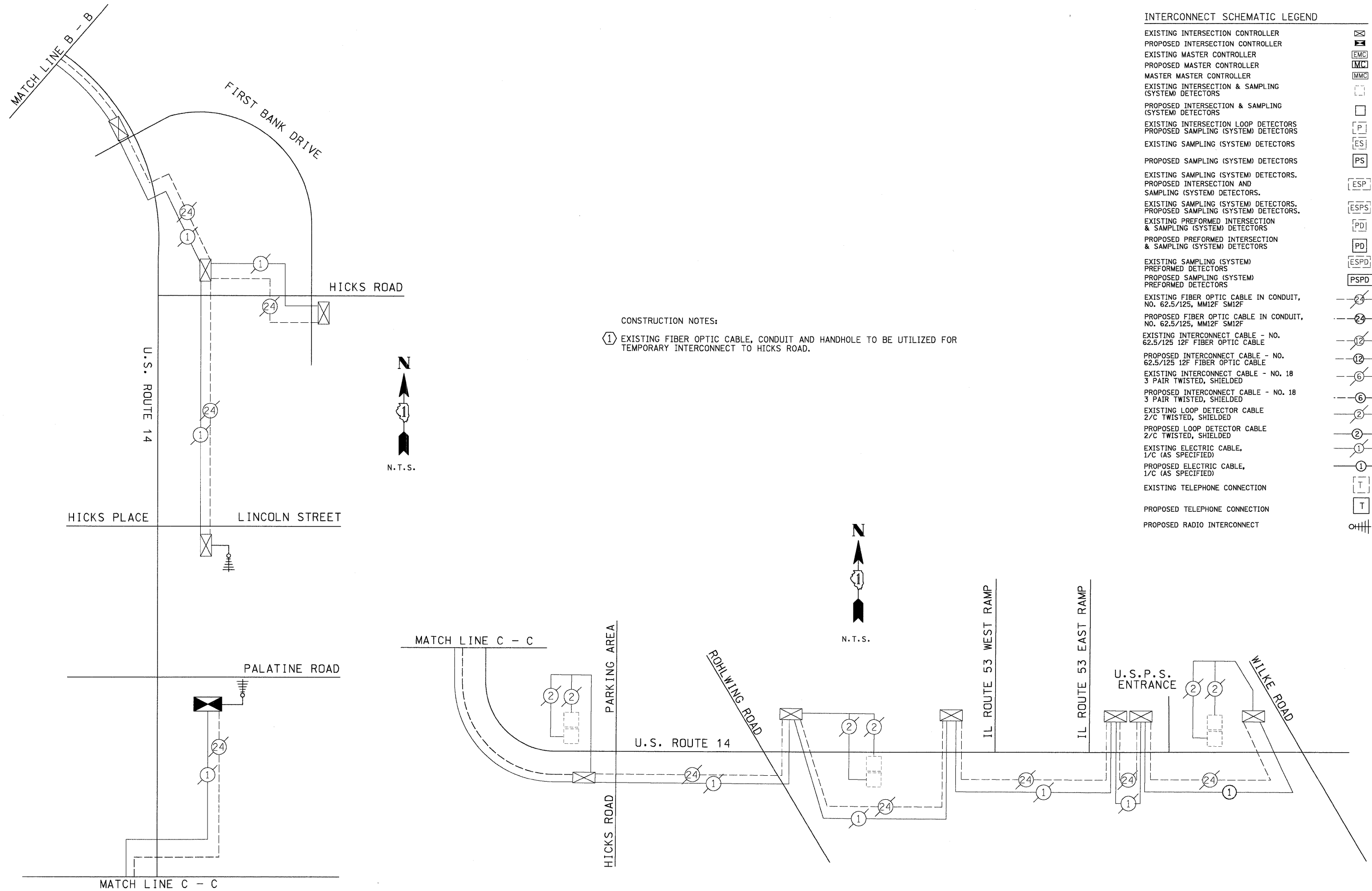

CONSTRUCTION NOTES:
 ① EXISTING FIBER OPTIC CABLE, CONDUIT AND HANDHOLE TO BE UTILIZED FOR TEMPORARY INTERCONNECT TO HICKS ROAD.

INTERCONNECT SCHEMATIC LEGEND

EXISTING INTERSECTION CONTROLLER	⊗
PROPOSED INTERSECTION CONTROLLER	⊠
EXISTING MASTER CONTROLLER	EMC
PROPOSED MASTER CONTROLLER	MCM
MASTER MASTER CONTROLLER	MMC
EXISTING INTERSECTION & SAMPLING (SYSTEM) DETECTORS	⊠
PROPOSED INTERSECTION & SAMPLING (SYSTEM) DETECTORS	□
EXISTING INTERSECTION LOOP DETECTORS	[P]
PROPOSED SAMPLING (SYSTEM) DETECTORS	[P]
EXISTING SAMPLING (SYSTEM) DETECTORS	[ES]
PROPOSED SAMPLING (SYSTEM) DETECTORS	[PS]
EXISTING SAMPLING (SYSTEM) DETECTORS, PROPOSED INTERSECTION AND SAMPLING (SYSTEM) DETECTORS.	[ESP]
EXISTING SAMPLING (SYSTEM) DETECTORS, PROPOSED SAMPLING (SYSTEM) DETECTORS.	[ESPS]
EXISTING PREFORMED INTERSECTION & SAMPLING (SYSTEM) DETECTORS	[PD]
PROPOSED PREFORMED INTERSECTION & SAMPLING (SYSTEM) DETECTORS	[PD]
EXISTING SAMPLING (SYSTEM) PREFORMED DETECTORS	[ESPD]
PROPOSED SAMPLING (SYSTEM) PREFORMED DETECTORS	[PSPD]
EXISTING FIBER OPTIC CABLE IN CONDUIT, NO. 62.5/125, MM12F SM12F	---(24)---
PROPOSED FIBER OPTIC CABLE IN CONDUIT, NO. 62.5/125, MM12F SM12F	---(24)---
EXISTING INTERCONNECT CABLE - NO. 62.5/125 12F FIBER OPTIC CABLE	---(12)---
PROPOSED INTERCONNECT CABLE - NO. 62.5/125 12F FIBER OPTIC CABLE	---(12)---
EXISTING INTERCONNECT CABLE - NO. 18 3 PAIR TWISTED, SHIELDED	---(6)---
PROPOSED INTERCONNECT CABLE - NO. 18 3 PAIR TWISTED, SHIELDED	---(6)---
EXISTING LOOP DETECTOR CABLE 2/C TWISTED, SHIELDED	---(2)---
PROPOSED LOOP DETECTOR CABLE 2/C TWISTED, SHIELDED	---(2)---
EXISTING ELECTRIC CABLE, 1/C (AS SPECIFIED)	---(1)---
PROPOSED ELECTRIC CABLE, 1/C (AS SPECIFIED)	---(1)---
EXISTING TELEPHONE CONNECTION	[T]
PROPOSED TELEPHONE CONNECTION	[T]
PROPOSED RADIO INTERCONNECT	⊕

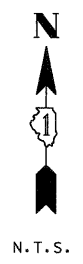
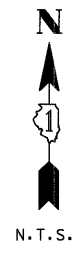

FILE NAME = ...N:\Tr of fio\SC12_Tmp-US14.dgn	USER NAME = FPACIONE	DESIGNED - ABR	REVISED -	STATE OF ILLINOIS DEPARTMENT OF TRANSPORTATION	TEMPORARY INTERCONNECT SCHEMATIC U.S. ROUTE 14 FROM BALDWIN ROAD TO WILKE ROAD PALATINE, ILLINOIS			F.A.P. RTE. VAR	SECTION 2009-007-TS	COUNTY COOK	TOTAL SHEETS 30	SHEET NO. 20	
PLOT SCALE = N.T.S.					CHECKED - MJT	SCALE: N.T.S.	SHEET NO. OF SHEETS	STA. TO STA.	CONTRACT NO. 60603				
DATE = 1/22/2009					REVISED -	FED. ROAD DIST. NO. ILLINOIS FED. AID PROJECT							
N.T.S.					REVISED -								