

| | | | | |
|-----------------------|-----------|---------------------------|--------------|-----------|
| F.A.I. RTE. | SECTION | COUNTY | TOTAL SHEETS | SHEET NO. |
| 57 | 1920.1B-R | COOK | 101 | 024 |
| STA. | | TO STA. | | |
| FED. ROAD DIST. NO. 1 | | ILLINOIS FED. AID PROJECT | | |
| CONTRACT NO. 62533 | | | | |

NOTES:

1. FOR CURB RAMP AND SIDEWALK DETAILS AND GENERAL NOTES SEE SHEETS 061 TO 064
2. ALL SLOPES SHOWN ARE ROUNDED NUMBERS
3. THE WIDTHS OF PAVEMENT MARKINGS FOR CROSSWALKS ARE SHOWN ON PAVEMENT MARKING PLANS
4. FOR DETAILS OF CURB RAMP AND CURB GUTTER SEE SHEET 060
5. KEYSTONE/TOP LANDINGS AREA, RAMPS AND SIDE FLARES WILL BE PAID FOR AS PCC SIDEWALK 8"

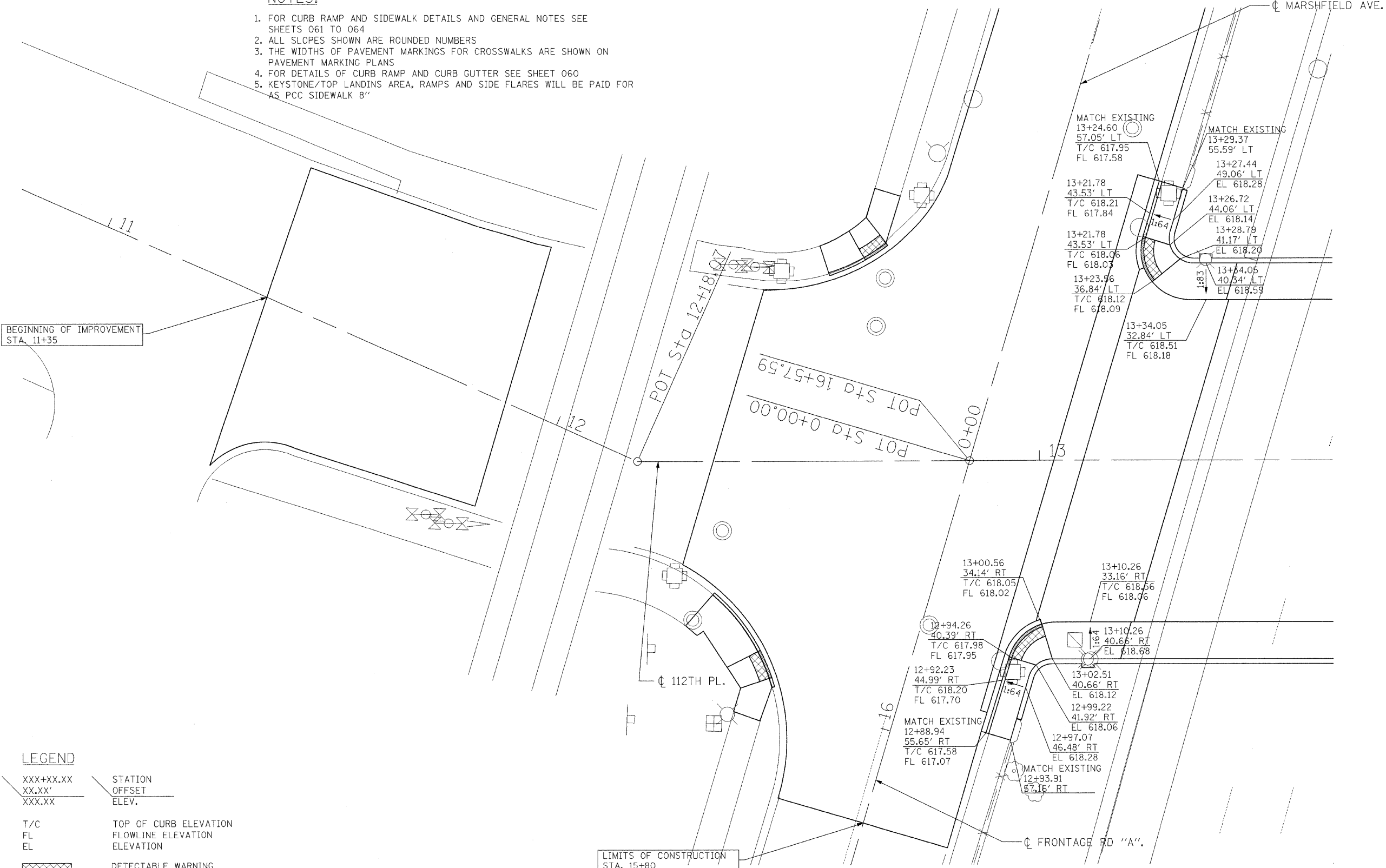

LEGEND

- XXX+XX.XX STATION
- XX.XX' OFFSET
- XXX.XX ELEV.
- T/C TOP OF CURB ELEVATION
- FL FLOWLINE ELEVATION
- EL ELEVATION
- [Cross-hatched box] DETECTABLE WARNING TILES
- [Solid shaded box] DEPRESSED CURB
- 0.5% SLOPE DIRECTION SLOPE IN PERCENT
- 1:6.4 SLOPE DIRECTION SLOPE IN RISE:RUN

PROPOSED ADA RAMP GRADING PLAN FOR 112TH PLACE AND MARSHFIELD AVE.

NOTE: ALL STATIONING BASED OFF 112TH PLACE UNLESS OTHERWISE NOTED.

| REVISIONS | |
|-----------|------|
| NAME | DATE |
| | |
| | |
| | |
| | |
| | |
| | |
| | |
| | |
| | |
| | |

ILLINOIS DEPARTMENT OF TRANSPORTATION
 112TH PLACE OVER
 F.A.I ROUTE 57 (INTERSTATE 57)
112TH PLACE AND MARSHFIELD AVE
ADA SIDEWALK DETAILS
 SCALE: 1"=10'
 DATE: 01/16/09
 DRAWN BY: BRH
 CHECKED BY: ACL
TENG
TENG & ASSOCIATES, INC.
 ENGINEERS/ARCHITECTS/PLANNERS
 205 N. MICHIGAN AVE. CHICAGO, IL 60601
 TELEPHONE: 312/616-0000

..\ALTCOM8.DGN ..\TFCOMM.DGN ..\RWD005V6.DGN ..\SURF005V6.DGN ..\LIT0005.DGN ..\AG-SCRATCH-V7.DGN
 H6-2009.134635 T:\DOCUMENT\193080N\CWL\DWG\RWD005V6.DGN
 1 2 3 4 5 6 7 8 9 10 11 12 13 14 15 16 17 18 19 20 21 22 23 24 25 26 27 28 29 30 31 32 33 34 35 36 37 38 39 40 41 42 43 44 45 46 47 48 49 50 51 52 53 54 55 56 57 58 59 60 61 62