

F.A.I. RTE.	SECTION	COUNTY	TOTAL SHEETS	SHEET NO.
57	1920.1B-R	COOK	101	069
STA.	TO STA.			
FED. ROAD DIST. NO. 1	ILLINOIS	FED. AID PROJECT		
CONTRACT NO. 62533				

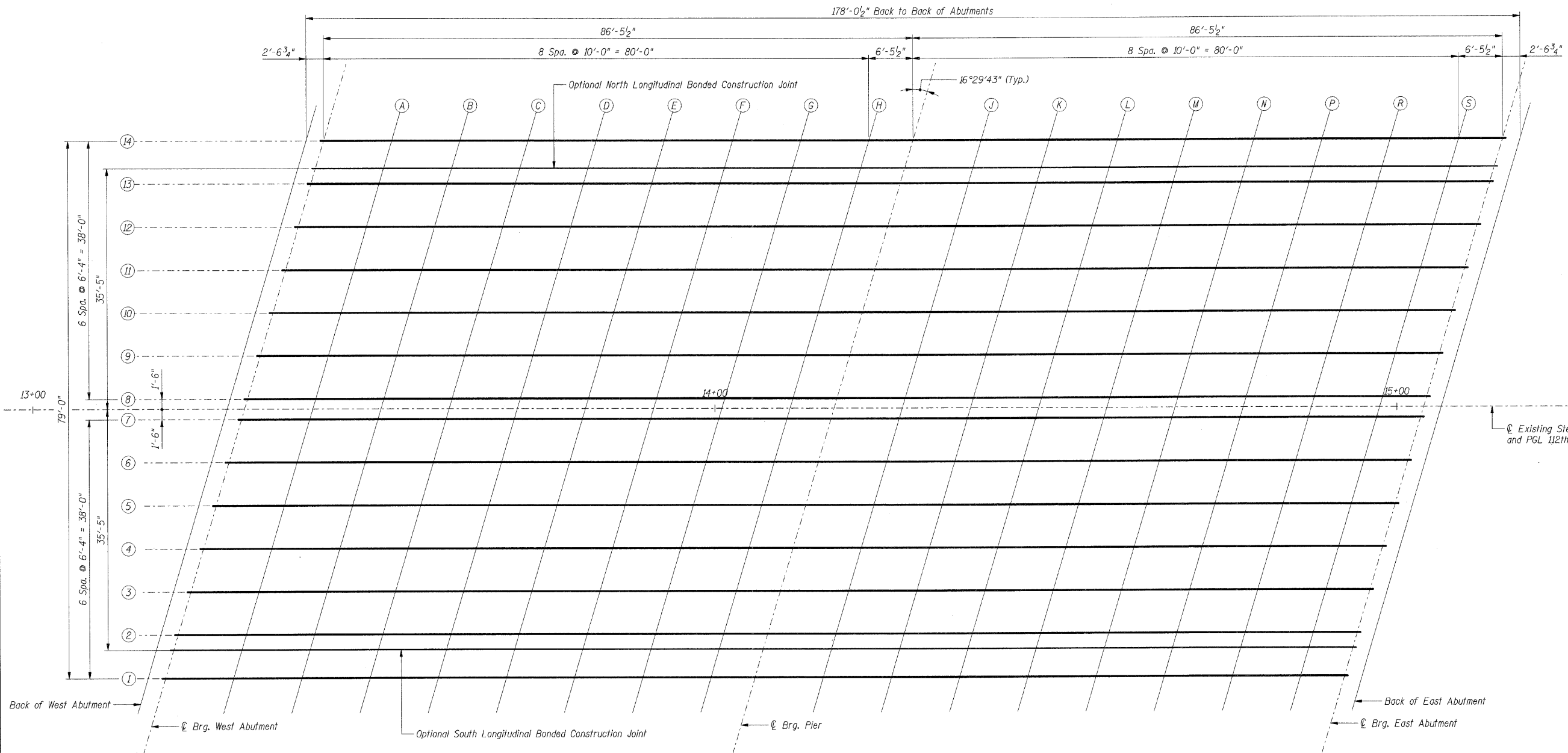

SCREED PLAN

DEFLECTIONS

Girder	A	B	C
1 and 14	7/8"	1/8"	1/2"
2-5 and 9-13	7/8"	1"	3/8"
7 and 8	5/8"	3/4"	3/8"

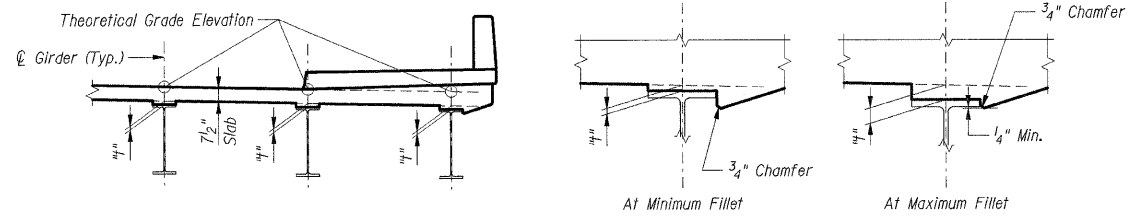

FILLET HEIGHTS

To determine "h": After all structural steel has been erected, elevations of the top flanges of the girders shall be taken at intervals shown above. These elevations subtracted from the "Theoretical Grade Elevations Adjusted for Dead Load Deflections" shown on Sheets S-004 and S-005, minus the slab thickness, equal the fillet heights "h" above the top flanges of the girders.

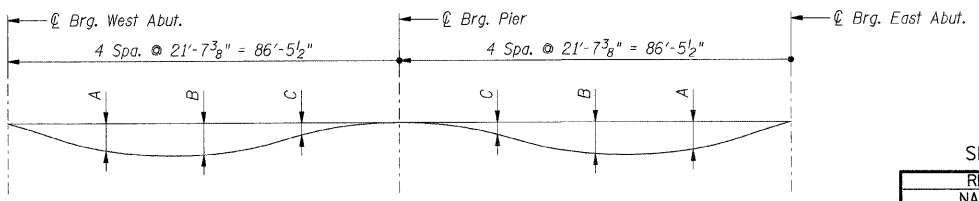

DEAD LOAD DEFLECTION DIAGRAM
(Includes weight of concrete only)

Notes:
The above deflections are not to be used in the field if the Engineer is working from the theoretical grade elevations adjusted for dead load deflections shown on Sheets S-004 and S-005.

Notes:
Work this sheet with Sheets S-004 and S-005.

SHT. S-003

REVISIONS	
NAME	DATE

ILLINOIS DEPARTMENT OF TRANSPORTATION
F.A.I. ROUTE 57 (INTERSTATE 57)
112TH PLACE BRIDGE DECK REPLACEMENT
112th PLACE OVER I-57
SN 016-0988 STA. 546+15.56
COOK COUNTY

DECK ELEVATION PLAN

DATE: 01/16/09

DRAWN BY: CCE
CHECKED BY: JLR

TENG
TENG & ASSOCIATES, INC.
ENGINEERS/ARCHITECTS/PLANNERS
225 N. MICHIGAN AVE., CHICAGO, IL 60601
TELEPHONE: 312.487.0000

\\A:\PROJECTS\0516\0516.DGN ... \PROJECTS\0516\0516.DGN ... \PROJECTS\0516\0516.DGN ...
PLOT FILE: 0516_PLOT.DWG
PLOT DATE: 01/16/09 10:10:10
PLOT BY: JLR