

LEGEND

- HOT-MIX ASPHALT SURFACE REMOVAL, VARIABLE DEPTH (3.2 INCHES TO 4.1 INCHES)
- HOT-MIX ASPHALT SURFACE REMOVAL, 3"
- HOT-MIX ASPHALT SURFACE REMOVAL, 1 1/4"
- HOT-MIX ASPHALT SURFACE REMOVAL, 1/2"
- SIDEWALK REMOVAL
- BUTT JOINT
- DRIVEWAY PAVEMENT REMOVAL AND REPLACEMENT
- PAVEMENT REMOVAL, 10"

NOTE:

BUTT JOINTS WILL BE AT SIDE STREETS, AT LIMITS OF THE PROJECT AND AT OTHER LOCATIONS AS SHOWN ON THE PLANS. ALL BUTT JOINTS ARE INCIDENTAL TO THE SURFACE COURSE.

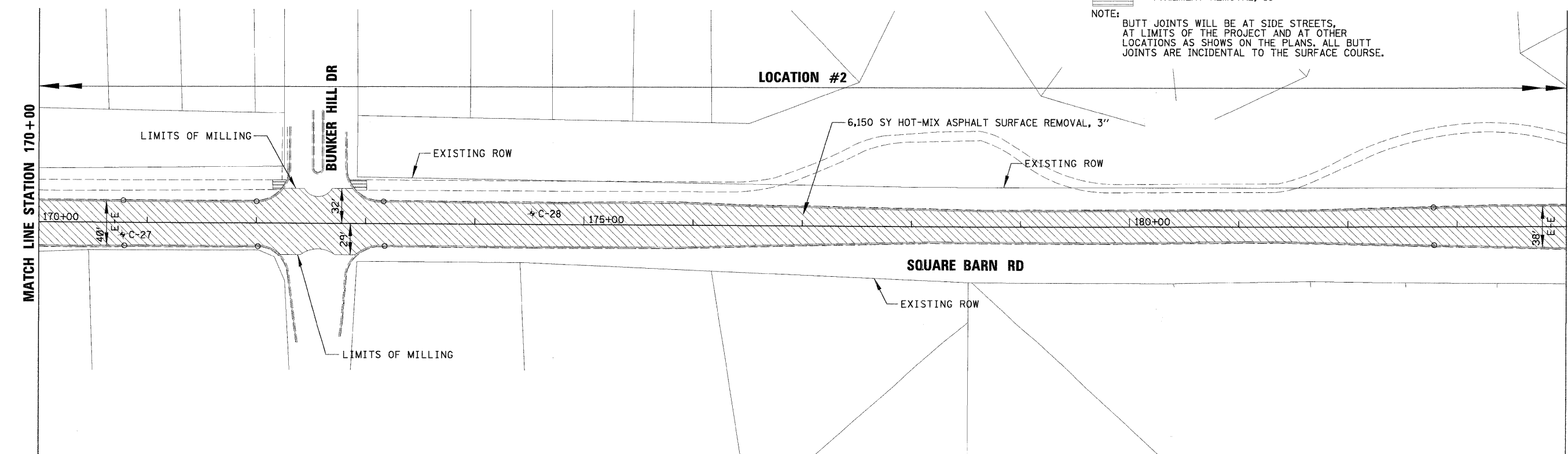

FILE NAME =	USER NAME = MAGOLDEN	DESIGNED - LMF	REVISED -	STATE OF ILLINOIS DEPARTMENT OF TRANSPORTATION	EXISTING CONDITIONS AND REMOVAL PLAN SQUARE BARN RD - 3	F.A. RTE.	SECTION	COUNTY	TOTAL SHEETS	SHEET NO.	
N:\ALCONQUIN\070273\070273\00019\Civil\REM070273 LAPP Square Barn North-3.dgn						DRAWN - MDH	REVISED -	08-00075-00-RS	MCHENRY	35	14
PLOT SCALE = 50'						CHECKED - LMF	REVISED -	CONTRACT NO. 63138			
PLOT DATE = 2/13/2009						DATE - 2/13/2009	REVISED -	FED. ROAD DIST. NO. 1 ILLINOIS FED. AID PROJECT			
					SCALE: 50'	SHEET NO. 3 OF 9 SHEETS		STA. 156+00 TO STA. 184+00			