

NOTES:

1. COMBINATION CONCRETE CURB AND GUTTER REMOVAL TO BE DETERMINED BY THE RESIDENT ENGINEER IN THE FIELD.
2. PAVEMENT PATCHING LIMITS TO BE DETERMINED BY THE RESIDENT ENGINEER IN THE FIELD.
3. THE EXACT THERMOPLASTIC PAVEMENT MARKING LOCATIONS WILL BE DETERMINED IN THE FIELD BY THE ENGINEER. ALL THERMOPLASTIC PAVEMENT MARKINGS MUST FOLLOW THE IDOT DETAIL AND HIGHWAY STANDARDS. THE THERMOPLASTIC PAVEMENT MARKINGS WILL BE REPLACED INKIND.

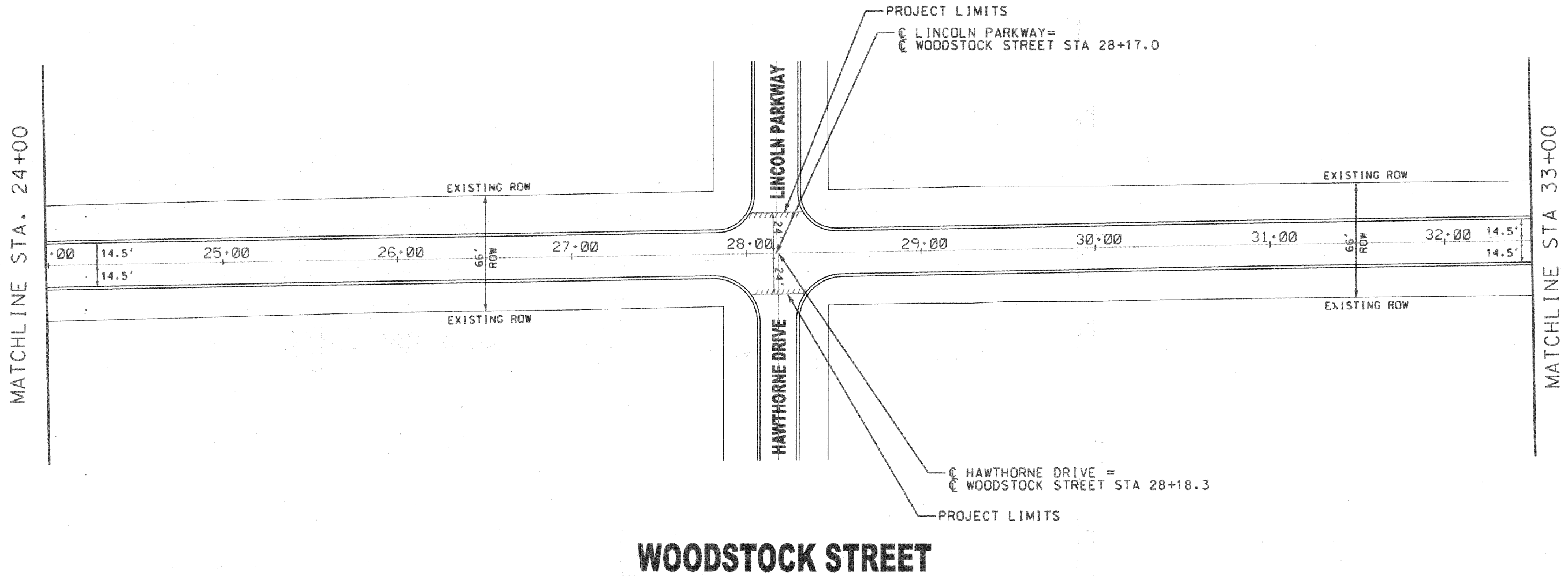

**WOODSTOCK STREET**

FILE NAME = WOODSTOCK_SHEET4.DGN	DESIGNED <i>SCC</i>	REVISED <i>2-25-2009</i>	<b>STATE OF ILLINOIS DEPARTMENT OF TRANSPORTATION</b>	<b>City of Crystal Lake, Illinois STP (LAPP) IMPROVEMENTS</b>	<b>Location No. 1: WOODSTOCK STREET</b>	F.A. RTE.	SECTION	COUNTY	TOTAL SHEETS	SHEET NO.
	DRAWN <i>JAM</i>	REVISED				120	08-00110-00-RS	MCHENRY	43	9
	CHECKED <i>EDM</i>	REVISED				CONTRACT NO. 63139		FED. ROAD DIST. NO. 1 (ILLINOIS) FED. AID PROJECT		
	DATE <i>11-26-2008</i>	REVISED				SCALE: 1"=30'	SHEET NO. 4 OF 7 SHEETS	STA. 24+00 TO STA. 33+00		