

F.A.S. RTE.	SECTION	COUNTY	TOTAL SHEETS	SHEET NO.
1042	107T-1	OGLE	53	1
FED. ROAD DIST. NO.	ILLINOIS	CONTRACT NO. 64B09		

STATE OF ILLINOIS
DEPARTMENT OF TRANSPORTATION
DIVISION OF HIGHWAYS
**PROPOSED
HIGHWAY PLANS**

FAS ROUTE 1042 (IL 251)
SECTION 107T-1
PROJECT ACBRS-ACRS-1042(106)
OGLE COUNTY

C-92-023-09

R 1 E

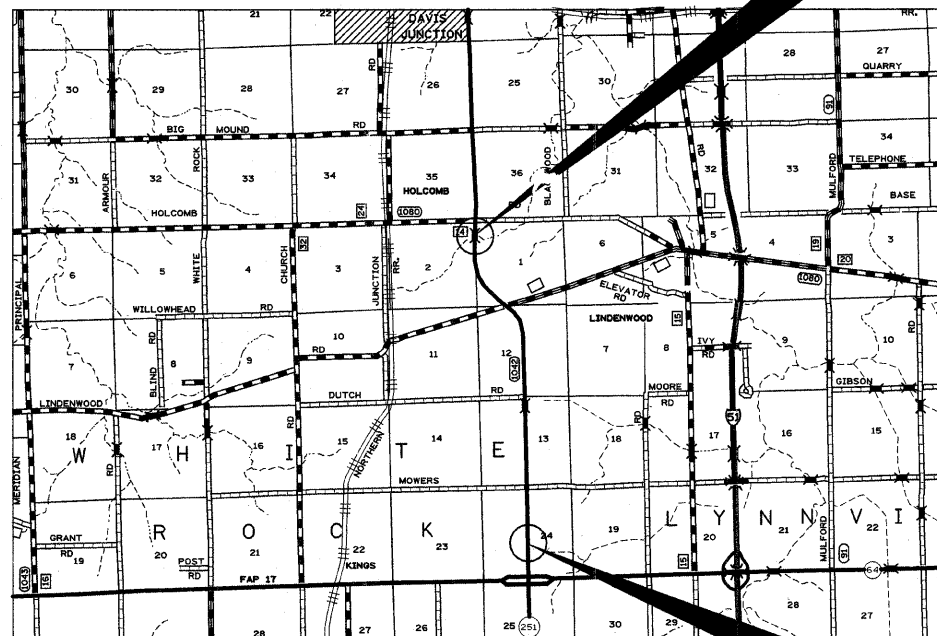

**IMPROVEMENT BEGINS
STA. 640 + 00
SECTION BEGINS
STA. 640 + 50**
INCLUDES THE REMOVAL AND REPLACEMENT
OF THE EXISTING BOX CULVERT
EXISTING SN-071-2001
PROPOSED SN-071-2027
**SECTION ENDS
STA. 643 + 60
IMPROVEMENT ENDS
STA. 644 + 10**

T 41 N

**IMPROVEMENT BEGINS
STA. 446 + 50
SECTION BEGINS
STA. 447 + 00**
INCLUDES THE REMOVAL AND REPLACEMENT
OF THE EXISTING BOX CULVERT
EXISTING SN-071-1092
PROPOSED SN-071-1147
**SECTION ENDS
STA. 450 + 50
IMPROVEMENT ENDS
STA. 451 + 00**

D-92-071-05



LOCATION OF SECTION INDICATED THUS: - [thick black line] -

INDEX OF SHEETS

- 1 COVER SHEET
- 2-3 SUMMARY OF QUANTITIES
- 4-5 GENERAL NOTES
- 6-8 TYPICAL SECTIONS
- 9-12 SCHEDULE OF QUANTITIES
- 13-16 HORIZONTAL AND VERTICAL CONTROL SHEETS
- 17-18 PLAN AND PROFILE SHEETS
- 19-20 EROSION CONTROL SHEETS
- 21 FIELD TILE DETAIL SHEET
- 22-30 CULVERT DETAILS
- 31 DETOUR DETAIL
- 32-33 BORING LOG SHEETS
- 34 HOT-MIX ASPHALT SHOULDER (23.4a)
SLOPED HEADWALL, TYPE 1 (28.4)
DELINEATOR AND POST ORIENTATION (37.4)
TYPICAL BENCHING DETAIL ON EXISTING EMBANKMENT (50.4)
LETTERING FOR NAME PLATE (89.4)
TREE REPLACEMENT SCHEDULE (90.4)
EROSION CONTROL DETAILS FOR SILT FENCE (29.2)
- 35 FIELD TILE JUNCTION VAULTS 600 (24) AND 900 (36) DIA (30.2)
WITNESS MARKER & PERMANENT SURVEY MARKERS, TYPE II (66.2)
- 37 STORM WATER PREVENTION PLAN (2.1)
- 38 HOT-MIX ASPHALT APPROACHES & MAILBOX TURNOUTS (20.1)
- 39 TRAFFIC CONTROL FOR ROAD CLOSURE (40.1)
- 40-42 TYPICAL PAVEMENT MARKINGS (41.1)
- 43 DETAILS OF PLANTING AND BRACING TREES (92.1)
- 44-53 CROSS SECTIONS

STATE STANDARDS

- 000001-05 STANDARD SYMBOLS, ABBREVIATIONS AND PATTERNS
- 001001-02 AREAS OF REINFORCEMENT BARS
- 001006 DECIMAL OF AN INCH AND OF A FOOT
- 280001-04 TEMPORARY EROSION CONTROL SYSTEMS
- 406201-01 MAILBOX TURNOUT
- 420001-07 PAVEMENT JOINTS
- 442201-03 CLASS C AND D PATCHES
- 482001-02 HMA SHOULDER ADJACENT TO FLEXIBLE PAVEMENT
- 515001-03 NAME PLATE FOR BRIDGES
- 542401-01 METAL END SECTION FOR PIPE CULVERTS
- 635001-01 DELINEATORS
- 665001-02 WOVEN WIRE FENCE
- 666001-01 RIGHT-OF-WAY MARKERS
- 701901-01 TRAFFIC CONTROL DEVICES
- 720011-01 METAL POSTS FOR SIGNS, MARKERS, AND DELINEATORS
- 728001-01 TELESCOPING STEEL SIGN SUPPORT
- 729001-01 APPLICATIONS OF TYPES A AND B METAL POSTS (FOR SIGNS & MARKERS)
- 780001-02 TYPICAL PAVEMENT MARKINGS
- 781001-03 TYPICAL APPLICATIONS RAISED REFLECTIVE PAVEMENT MARKERS

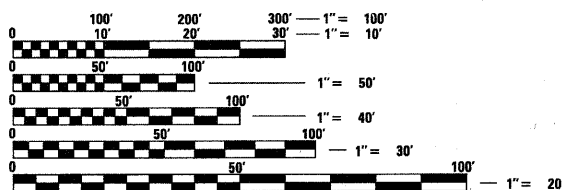

FULL SIZE PLANS HAVE BEEN PREPARED USING STANDARD ENGINEERING SCALES. REDUCED SIZED PLANS WILL NOT CONFORM TO STANDARD SCALES. IN MAKING MEASUREMENTS ON REDUCED PLANS, THE ABOVE SCALES MAY BE USED.

J.U.L.I.E.
JOINT UTILITY LOCATION INFORMATION FOR EXCAVATION
1-800-892-0123
OR 811

**WHITE ROCK TOWNSHIP, SECTIONS 1,2, & 24
CONTRACT NO. 64B09**

WHITE ROCK TOWNSHIP, SECTION 1,2,24
GROSS LENGTH OF PROJECT = 19,710 LIN. FT = 3.73 MILE
NET LENGTH OF PROJECT = 760 LIN. FT = 0.14 MILE

STATE OF ILLINOIS
DEPARTMENT OF TRANSPORTATION
DIVISION OF HIGHWAYS

SUBMITTED 12/05 2008

[Signature]
DEPUTY DIRECTOR OF HIGHWAYS, REGION ENGINEER

March 27, 2009
[Signature]
ENGINEER OF DESIGN AND ENVIRONMENT

March 27, 2009
[Signature]
DIRECTOR OF HIGHWAYS, CHIEF ENGINEER

**PRINTED BY THE AUTHORITY
OF THE STATE OF ILLINOIS**

PROJECT ENGINEER: REBECCA MARRUFFO

SQUAD LEADER: BRAD CUSHMAN (815)-284-5996