

HORIZONTAL & VERTICAL CONTROL

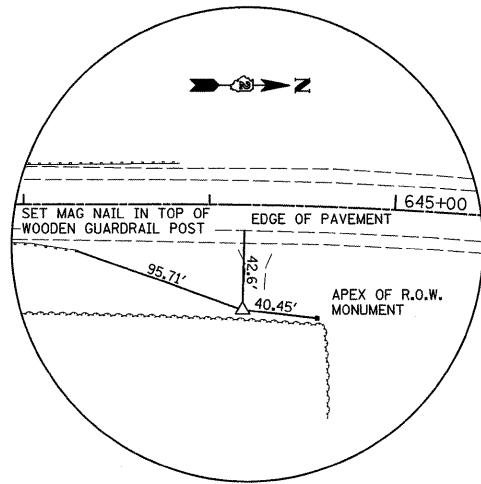

HORIZONTAL CONTROL
POINT NO. 1

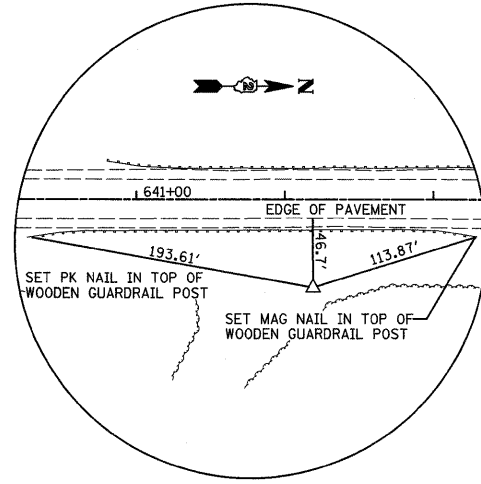

HORIZONTAL CONTROL
POINT NO. 103

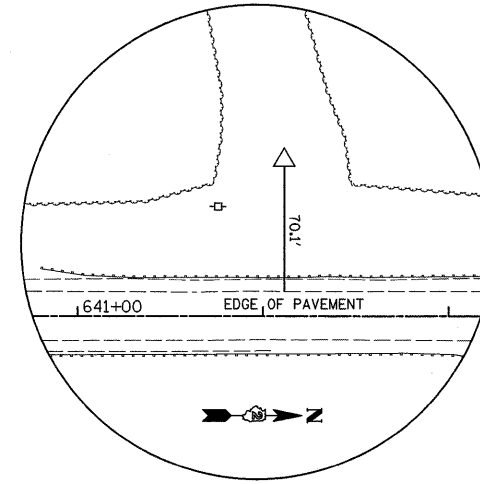

HORIZONTAL CONTROL
POINT NO. 104

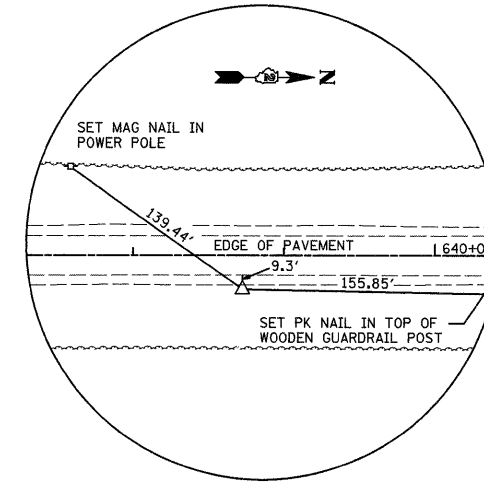

HORIZONTAL CONTROL
POINT NO. 105

HORIZONTAL CONTROL POINTS					
POINT	NORTHING	EASTING	STATION	OFFSET	DESCRIPTION
1	1967135.72	2592810.64	644+18.53	56.32' RT	5/8" REBAR
103	1966937.04	2592818.00	642+19.00	59.31' RT	5/8" REBAR
104	1966926.17	2592675.61	642+11.38	83.28' LT	5/8" REBAR
105	1966589.80	2592788.95	638+72.51	22.35' RT	5/8" REBAR

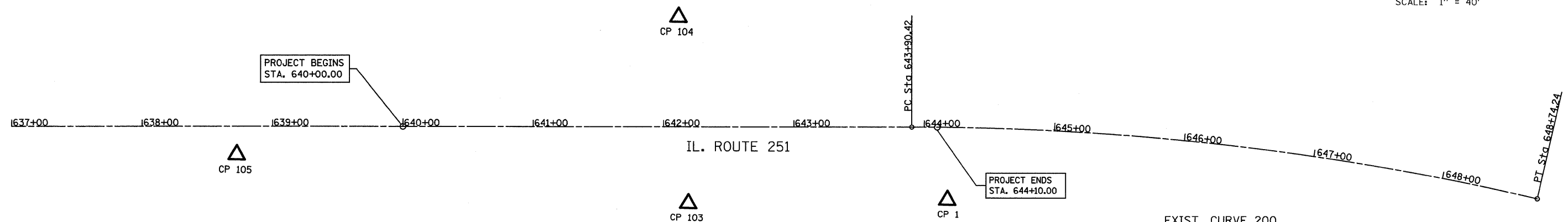
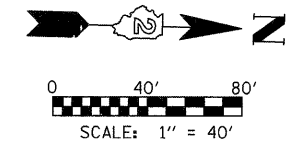

EXIST. CURVE 200
 PI STA. = 646+33.36
 Δ = 12° 54' 20" (RT)
 D = 2° 40' 03"
 R = 2,148.00'
 T = 242.94'
 L = 483.82'
 E = 13.69'
 P.C. STA. = 643+90.42
 P.T. STA. = 648+74.24

FILE NAME =	USER NAME = cushmanbw	DESIGNED - FML	REVISED -	STATE OF ILLINOIS DEPARTMENT OF TRANSPORTATION	HORIZONTAL & VERTICAL CONTROL	F.A.S. RTE.	SECTION	COUNTY	TOTAL SHEETS	SHEET NO.
c:\pw_work\pw\dot\cushmanbw\d0103291\0264809-sh1-ATB\CONTROL_POINTS.dgn	DRAWN - FML	REVISED -	1042			107T-1	OGLE	53	16	
PLOT SCALE = 48.00' / IN.	CHECKED - DMM	REVISED -	CONTRACT NO. 64B09							
PLOT DATE = Mon Dec 01 11:53:40 2008	DATE - MAY 2008	REVISED -	FED. ROAD DIST. NO. ILLINOIS FED. AID PROJECT							