

STATE OF ILLINOIS
DEPARTMENT OF TRANSPORTATION

ROUTE NO.	SECTION	COUNTY	SHEETS	SHEET	SHEET NO. 8 SHEETS 19
F.A.P. 17	101BR-4	OGLE	60	25	
FED. ROAD DIST. NO. 2		ILLINOIS	FED. AID PROJECT		

Contract # 64D11

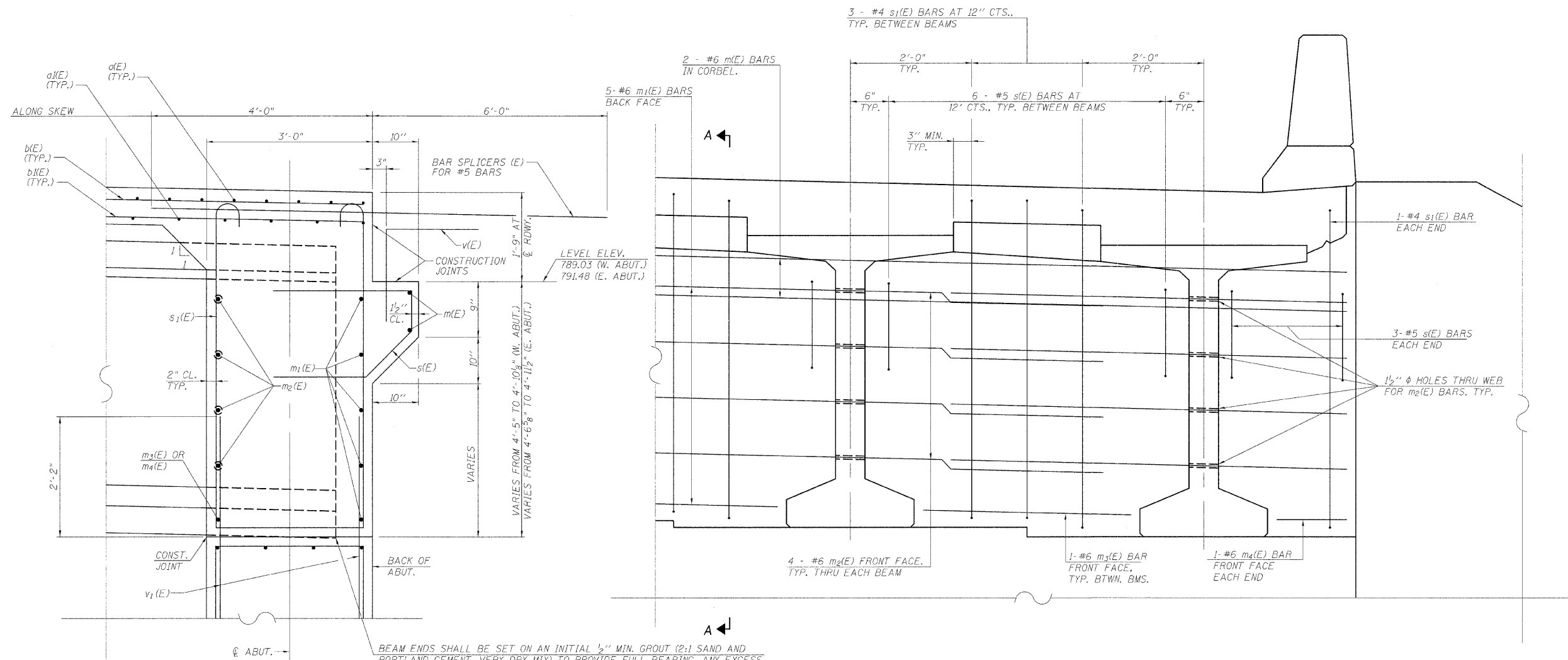

SECTION A-A

DIMENSIONS AT RIGHT ANGLES TO ABUTMENT, EXCEPT AS SHOWN.

DIAPHRAGM ELEVATION AT ABUTMENT

MIN. BAR LAP

#6 BAR = 2'-9"

NOTES:
REINFORCEMENT BARS IN DIAPHRAGM ARE BILLED WITH SUPERSTRUCTURE ON SHEET 7 OF 19.
CONCRETE IN DIAPHRAGM IS INCLUDED WITH CONCRETE SUPERSTRUCTURE ON SHEET 7 OF 19.
FOR DETAILS OF BARS s(E) AND s1(E), SEE SHEET 7 OF 19.
THE s(E) AND s1(E) BARS SHALL BE PLACED PARALLEL TO THE BEAMS. SPACING FOR THESE BARS SHALL BE AT RIGHT ANGLES TO THE BEAMS.

DESIGNED	ASP
CHECKED	WSP
DRAWN	BGC
CHECKED	ASP

ABUTMENT DIAPHRAGM DETAILS
IL 64 OVER FIVE MILE CREEK
F.A.P. RT. 17 SECTION 101BR-4
OGLE COUNTY
STATION 124+91.00
STRUCTURE NO. 071-0095

DLZ 85 W. Algonquin Rd. Ste. 220
Arlington Heights IL 60005
DLZ Illinois, Inc.