

# FOR INFORMATION ONLY

STATE OF ILLINOIS  
DEPARTMENT OF TRANSPORTATION

ROUTE NO.	SECTION	COUNTY	TOTAL SHEETS	SHEET NO.
1197-1	107VB-1	WHITESIDE	61	39
SHEET NO. 4				
13 SHEETS				

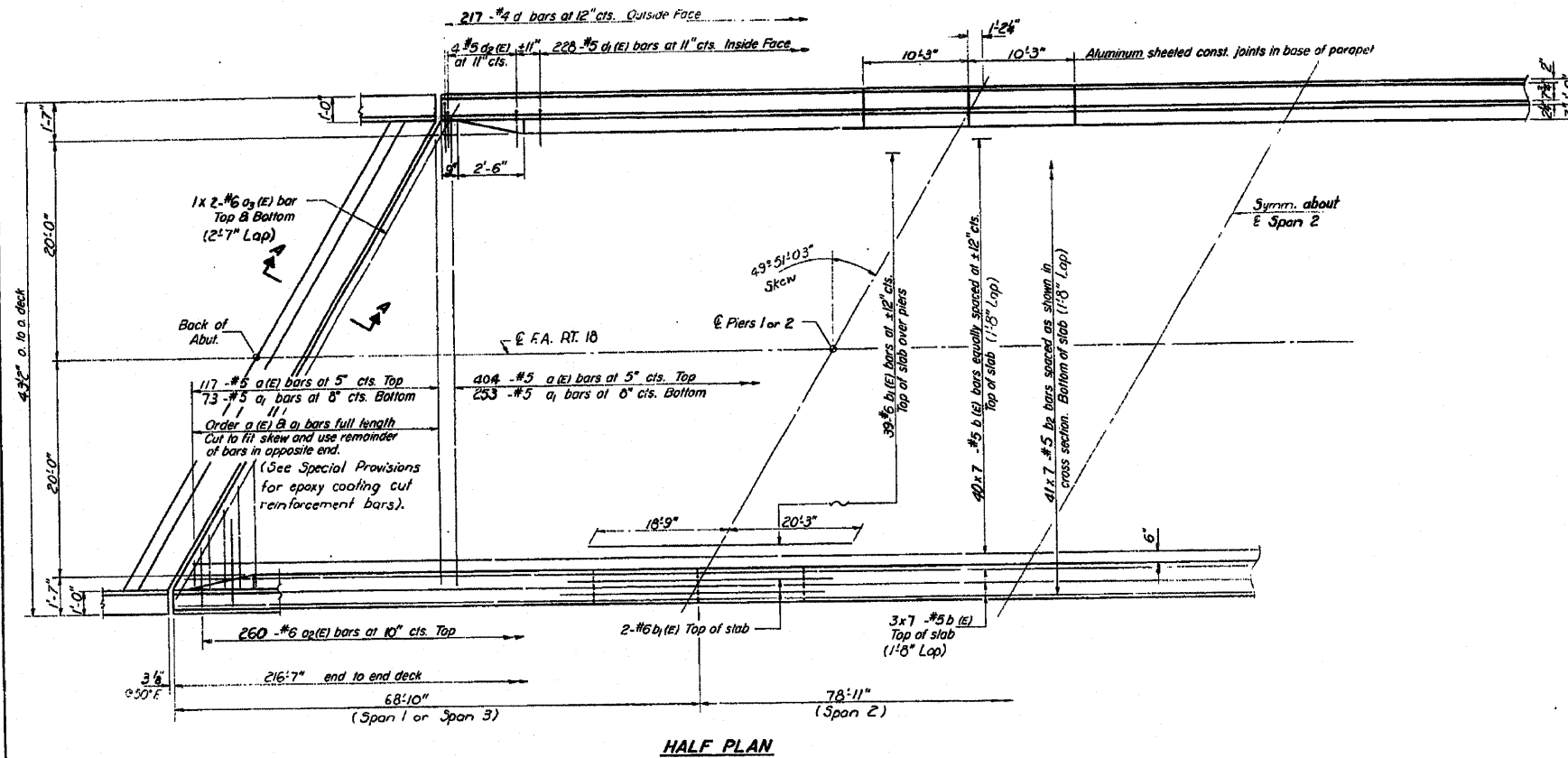

TOP OF FLANGE ELEVATIONS  
\* (Before any deflection)

	Beam 1	Beam 2	Beam 3	Beam 4	Beam 5	Beam 6
E Brg. E. Abut.	627.22	627.34	627.42	627.34	627.23	627.04
E Pier #1	627.30	627.44	627.55	627.49	627.40	627.23
E Splice #1	627.32	627.47	627.58	627.53	627.45	627.28
E Splice #2	627.29	627.45	627.53	627.58	627.47	627.32
E Pier #2	627.24	627.41	627.49	627.55	627.45	627.30
E Brg. W. Abut.	627.05	627.24	627.35	627.43	627.35	627.23

\* For fabrication only

INTERIOR BEAM MOMENT TABLE

	4 Splice 3 Pier 1 or 2	5 Span 2
$I_s$ (in <sup>4</sup> )	6710	6710
$I_c$ (in <sup>4</sup> )	17173	17173
$S_s$ (in <sup>3</sup> )	405	405
$S_c$ (in <sup>3</sup> )	582	582
$R$ (in)	.862	.862
$M_R$ (in)	206	463
$M_P$ (in)	.323	.323
$M_S$ (in)	122	137
$M_L$ (in)	544	320
$M_{max}$ (in)	742	80
	2020	1648
	3308	1688
$VR$ (k)	53.9	47.8

INTERIOR BEAM REACTION TABLE

	E. Abut.	Pier 1 or 2	W. Abut.
$R_R$ (k)	31.1	95.7	31.1
$R_L$ (k)	40.8	53.4	40.8
$I_{mp}$ (k)	10.6	13.3	10.6
$R_{TOTAL}$ (k)	82.5	162.4	82.5

$I_s$  and  $S_s$  are the moment of inertia and section modulus of the steel section used in computing  $I_s$  TOTAL.  
 $I_c$  and  $S_c$  are the moment of inertia and section modulus of the composite section used in computing  $I_s$  TOTAL.  
 $VR$  is the maximum  $k+I$  impact shear range in span used to determine shear connector spacing.

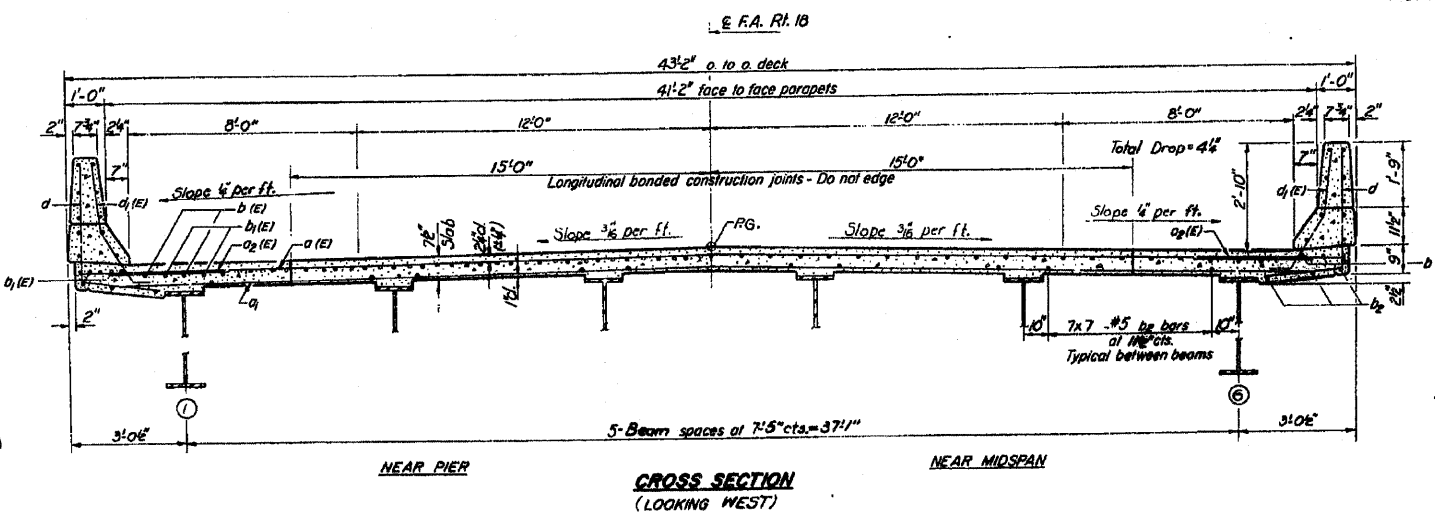

NOTES:  
 See sheet #5 for superstructure details and Bill of Material.  
 Reinforcement bars designated (E) shall be epoxy coated. See Special Provisions.  
 Bars indicated thus 20 x 3-#5 etc. indicate 20 lines of bars with 3 lengths per line.

DESIGNED	Suresh Desai
CHECKED	DAW KRULL
DRAWN	P. Joty
CHECKED	D.N.

EXAMINED	[Signature]
PASSED	[Signature]
APPROVED	[Signature]

S-I-L 1159 9-27-76

SUPERSTRUCTURE  
 F.A. RT. 10 SEC. 107VB-1  
 WHITESIDE COUNTY  
 STA. 722+33.72

\* FAS 1197 (West Lincolnway Road) & FAP 308 (IL 84)  
 \*\*D2 Bridge Painting 2009-3

FILE NAME = P:\PAINTING\64E93\PLANeng.dgn	USER NAME = linkd	DESIGNED -	REVISED -	STATE OF ILLINOIS DEPARTMENT OF TRANSPORTATION	Existing Plans SN 098-0096	F.A. RTE.	SECTION	COUNTY	TOTAL SHEET NO.
PLOT SCALE = 50.0000' / IN.	PLOT DATE = Thu Jan 29 10:22:53 2009	DRAWN -	REVISED -		SCALE: _____ SHEET NO. ____ OF ____ SHEETS STA. _____ TO STA. _____			Whiteside	15
		CHECKED -	REVISED -						13
		DATE -	REVISED -						CONTRACT NO. 64E93
									ILLINOIS FED. AID PROJECT