

F.A. RTE.	SECTION	COUNTY	TOTAL SHEETS	SHEET NO.
•	••	KANKAKEE	109	20
STA. 116+00 TO STA. 122+00		ILLINOIS FED. AID PROJECT		

STA. 119+09.43 ARMOUR ROAD=
STA. 200+00.00 STADIUM DRIVE

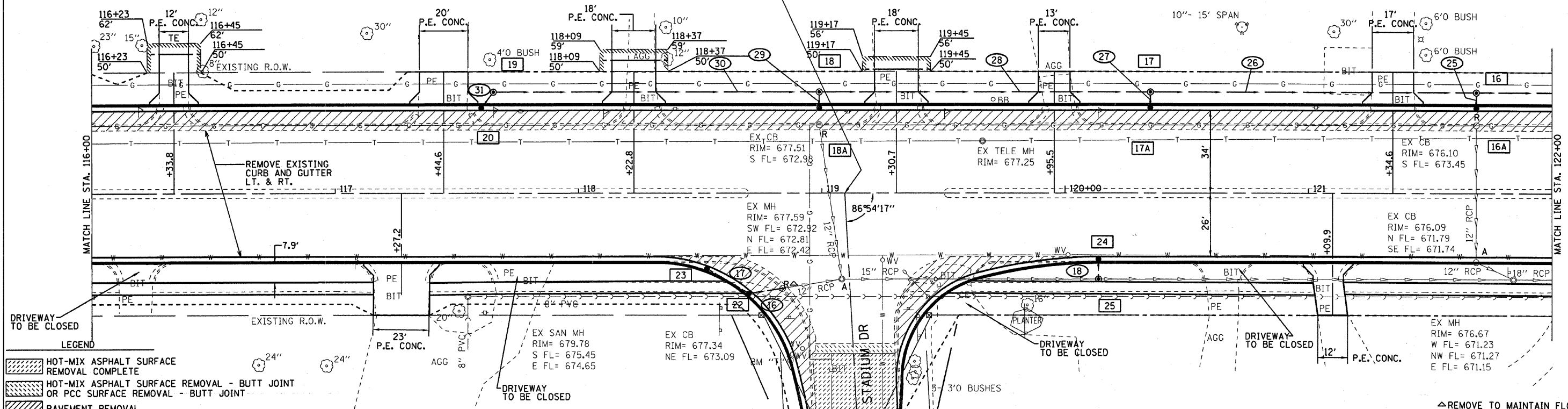

- LEGEND**
- HOT-MIX ASPHALT SURFACE REMOVAL COMPLETE
 - HOT-MIX ASPHALT SURFACE REMOVAL - BUTT JOINT OR PCC SURFACE REMOVAL - BUTT JOINT
 - PAVEMENT REMOVAL
 - PAVEMENT WIDENING

BENCHMARK "T"
TOP OF 5/8 NUT ON FIRE HYDRANT AT S.W. CORNER OF ARMOUR ROAD AND STADIUM DRIVE
ELEV. 682.41

NOTES:
OFFSETS SHOWN ARE TO EDGE OF PAVEMENT OR TO FLARED END SECTIONS, WHERE STRUCTURE IS NOT IN CURB AND GUTTER OFFSET IS TO CENTER OF STRUCTURE. RIM ELEVATIONS ARE AT FLOWLINE OF GUTTER OR TOP OF GRATE/LID.
• FLAT SLAB TOP REQUIRED
I-A - INLET TYPE A
I-B - INLET TYPE B
P.C.F.C.S. - PRECAST REINFORCED CONCRETE FLARED END SECTIONS
A(RG) - CLASS A RUBBER GASKET (SEE SPECIAL PROVISIONS)
WM - WATERMAIN (SEE SPECIAL PROVISIONS)
T.B. - TRENCH BACKFILL (CU YD)

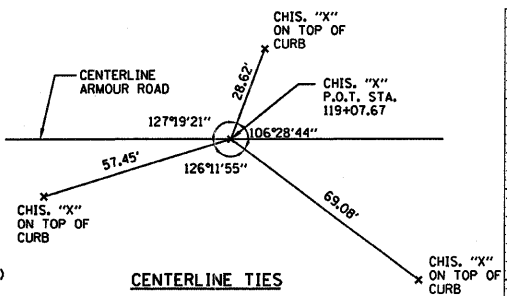

STRUCTURE NO.	20	19	18	18A	17	17A	16	16A	23	22	21	24	25	---	---	STRUCTURE NO.
STA	117+60.0	117+65.0	118+99.0	118+99.0	120+35.0	120+35.0	121+68.9	121+68.9	118+53.2	118+70.7	NOT	120+13.7	120+13.7	--	--	STA
OFFSET	34.0 LT	41.6 LT	41.6 LT	34.0 LT	41.6 LT	34.0 LT	41.6 LT	34.0 LT	29.9 RT	40.2 RT	USED	26.0 RT	35.2 RT	--	--	OFFSET
STRUCTURE TYPE	CB-C	MH TA 4	MH TA 4	CB-C	MH TA 4	CB-C	MH TA 4	CB-C	CB-C	CB-C	--	CB-C	MH TA 4	--	--	STRUCTURE TYPE
F&G TYPE	3	1 CL	1 CL	3	1 CL	3	1 CL	3	3	3	--	3	1 CL	--	--	F&G TYPE
RIM ELEVATION	678.03	678.50	678.50	677.43	677.30	676.90	676.90	676.31	677.76	677.50	--	677.14	677.80	--	--	RIM ELEVATION
EAST INVERT	--	674.63	674.09	--	673.55	--	673.01	--	674.76	672.48	--	--	671.97±	--	--	EAST INVERT
WEST INVERT	--	--	674.09	--	673.55	--	673.01	--	--	674.68	--	--	671.97±	--	--	WEST INVERT
NORTH INVERT	675.02	--	--	674.43	--	673.79	--	673.20	--	--	--	--	674.13	--	--	NORTH INVERT
SOUTH INVERT	--	674.98	674.40	--	673.76	--	673.17	--	--	--	--	--	674.14	--	--	SOUTH INVERT
PIPE NUMBER	17	16	18	25	26	27	28	29	30	31	-	-	-	-	-	PIPE NUMBER
SIZE	12"	12"	12"	12"	12"	12"	12"	12"	12"	12"	--	--	--	--	--	SIZE
LENGTH	20'	15'	8'	7'	134'	7'	136'	7'	134'	8'	--	--	--	--	--	LENGTH
CLASS	A	A	A	A	A (RG)	A	A (RG)	A	A (RG)	A	--	--	--	--	--	CLASS
TYPE	1	2	1	1	1	1	1	1	1	1	--	--	--	--	--	TYPE
% SLOPE	0.40%	0.40%	0.40%	0.40%	0.40%	0.40%	0.40%	0.40%	0.40%	0.40%	--	--	--	--	--	% SLOPE
T.B.	3.9	5.4	--	--	5.0	--	10.5	--	6.1	--	--	--	--	--	--	T.B.

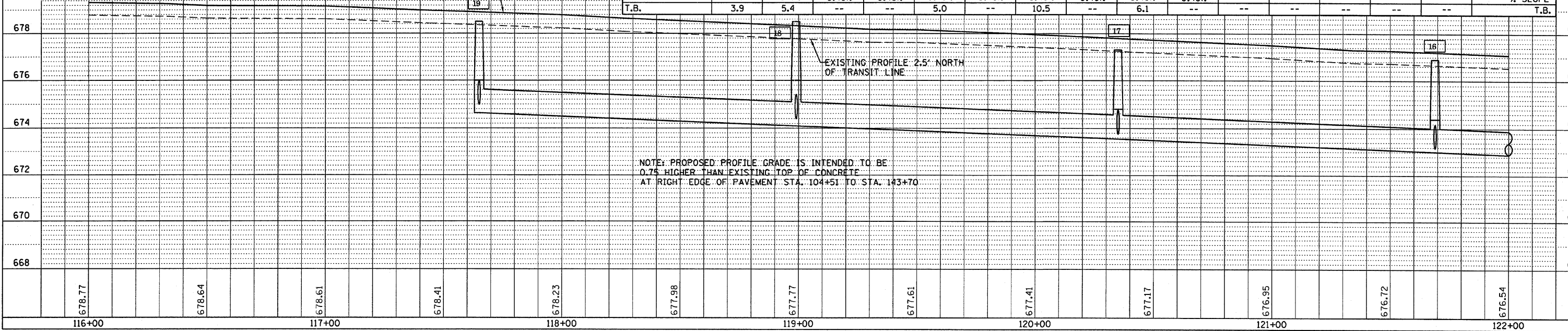

NOTE: PROPOSED PROFILE GRADE IS INTENDED TO BE 0.75' HIGHER THAN EXISTING TOP OF CONCRETE AT RIGHT EDGE OF PAVEMENT STA. 104+51 TO STA. 143+70