

STATE OF ILLINOIS
DEPARTMENT OF TRANSPORTATION

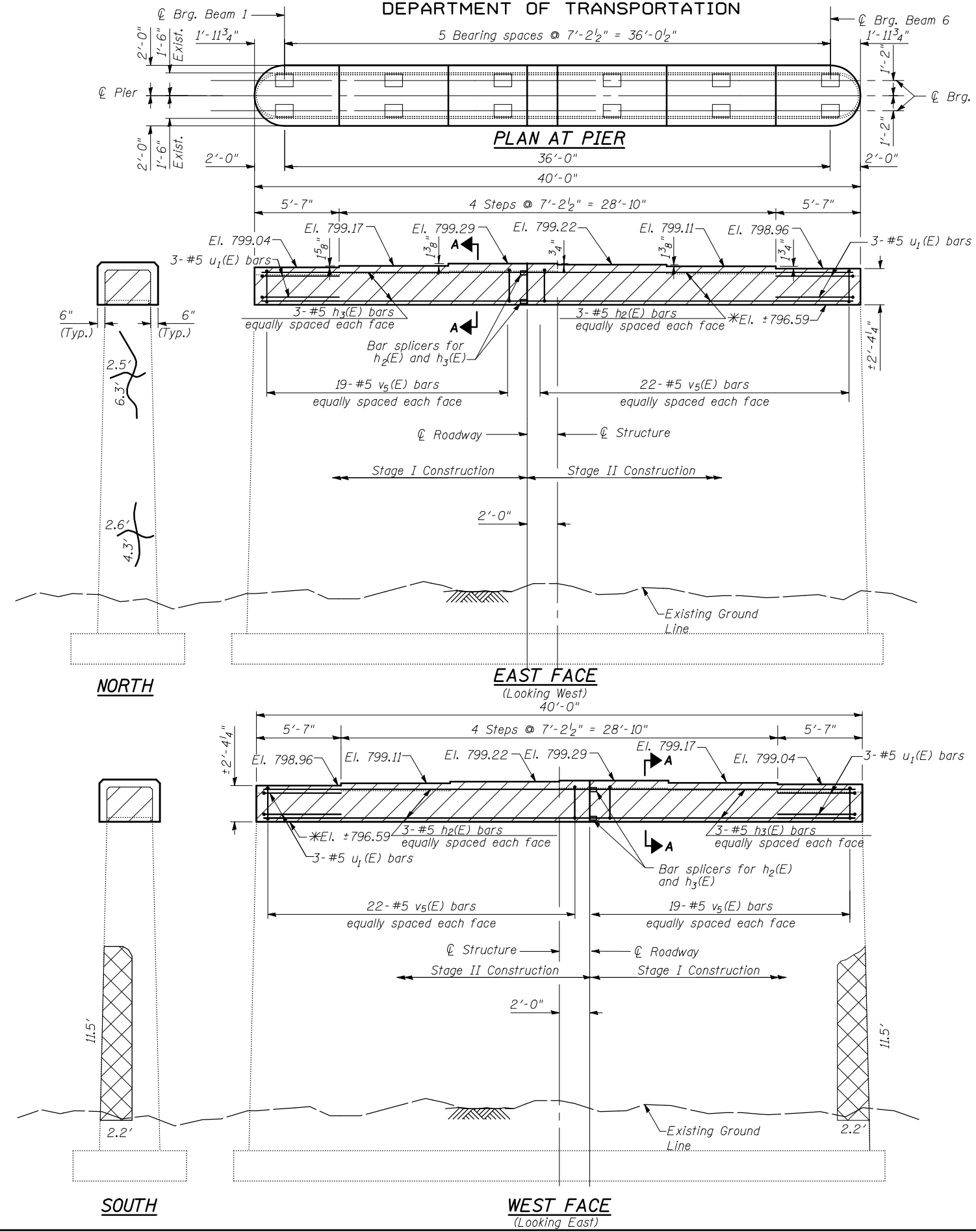

Notes:
Hatched areas indicate concrete removal. These areas to be poured after structural repair of concrete is complete for remainder of the pier.
For cap removal over non-repair areas, salvage existing #7 vertical bars. Bars to be cleaned, straightened, and incorporated into new construction. Cost included in cost of Concrete Removal.
For cap removal over repair areas, evaluate the existing #7 vertical bars as outlined in the Structural Repair of Concrete Special Provision.

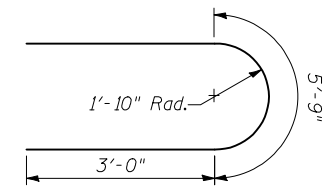
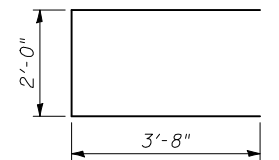
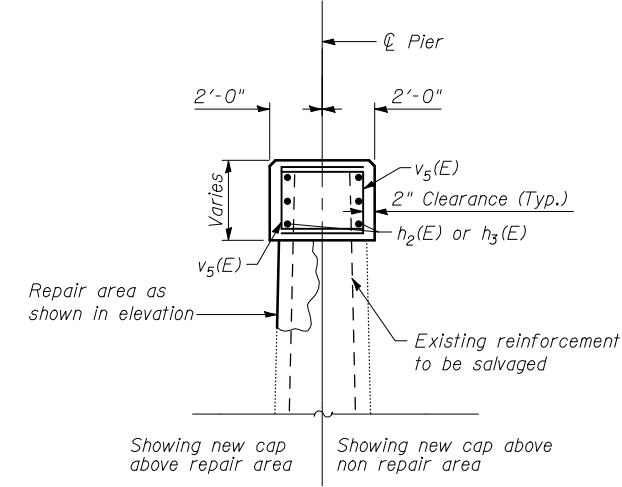

BILL OF MATERIALS

Bar	No.	Size	Length	Shape
h ₂ (E)	6	#5	21'-10"	—
h ₃ (E)	6	#5	17'-10"	—
v ₅ (E)	82	#5	9'-4"	—
u ₁ (E)	6	#5	11'-9"	—
Concrete Removal			CU YD	11
Concrete Structures			CU YD	16
Reinforcement Bars, Epoxy Coated			POUND	1,120
Epoxy Crack Injection			FT	18
Structural Repair of Concrete (Depth Equal to or less than 5 inches)			SQ FT	56

*Start removal from bottom of existing notch detail

**WESTBOUND PIER 1
REPAIR DETAILS
I-74 OVER LITTLE KICKAPOO CREEK
STRUCTURE NO. 057-0121**

STRAND ASSOCIATES, INC.

LEGEND

- Crack - Epoxy Crack Injection
- Portion of Existing Structure To Be Removed
- Structural Repair of Concrete (Depth Less than or Equal to 5 inches)

DESIGNED	RRD
CHECKED	AJS
DRAWN	KAS
CHECKED	JAR

SHEET NO. 24 27 SHEETS	F.A.I. RTE. 74	SECTION (57-21B)BR	COUNTY MCLEAN	TOTAL SHEETS 61	SHEET NO. 36
	PIER REPAIR DETAILS (3 OF 4)			CONTRACT NO. 70641	
FED. ROAD DIST. NO. 7 ILLINOIS FED. AID PROJECT					