

BENCHMARK:
 BM - Chiseled square on
 NW corner of E headwall of
 SN 015-2006, Station 1380+26,
 141.23' RT. Elev. 726.63 (NAVD 88)

EXISTING STRUCTURE:
 SN 015-2006
 was originally built in 1940
 as SBI 25, Section 19-X
 and was extended in 1969
 as SBI 25, Section 16-2, 19X-2,
 19 BY, 19 BY-1. It is a double
 box culvert with wingwalls on
 spread footings. The box dimensions
 are 8'5" x 6'6" and the length is
 242'-6" out to out of headwalls.
 Traffic shall be maintained
 utilizing stage construction. Road
 closure will be required of
 4th Street at the intersection with
 US 45 during construction.

STATIONING:
 Stationing of the structure
 is based on where the
 centerline of the culvert
 crosses the baseline as
 determined by IDOT
 District 7 Surveys.

No salvage.

STATE OF ILLINOIS
 DEPARTMENT OF TRANSPORTATION

ROUTE NO.	SECTION	COUNTY	SHEET	SHEET NO.
FAP 824	*	COLES	49 32	9 SHEETS
FED. ROAD DIST. NO.		ILLINOIS	FED. AID PROJECT	
			(16-2, 19X-2)RS-1, 19B, 19BR	

STRUCTURE INDEX OF SHEETS

General Plan	Sheet No. 1 of 9
General Data	Sheet No. 2 of 9
Stage Construction Details	Sheet No. 3 & 4 of 9
Box Culvert Details	Sheet No. 5 & 6 of 9
Bar Splicer Assembly Details	Sheet No. 7 of 9
Soil Boring Logs	Sheet No. 8 of 9
Temporary Concrete Barrier for Stage Construction	Sheet No. 9 of 9

DESIGN SPECIFICATIONS
 2002 AASHTO

LOADING HS20-44
 Allow 50 psf for future wearing surface.

DESIGN STRESSES

FIELD UNITS
 $f'_c = 3,500$ psi
 $f_y = 60,000$ psi (Reinf.)

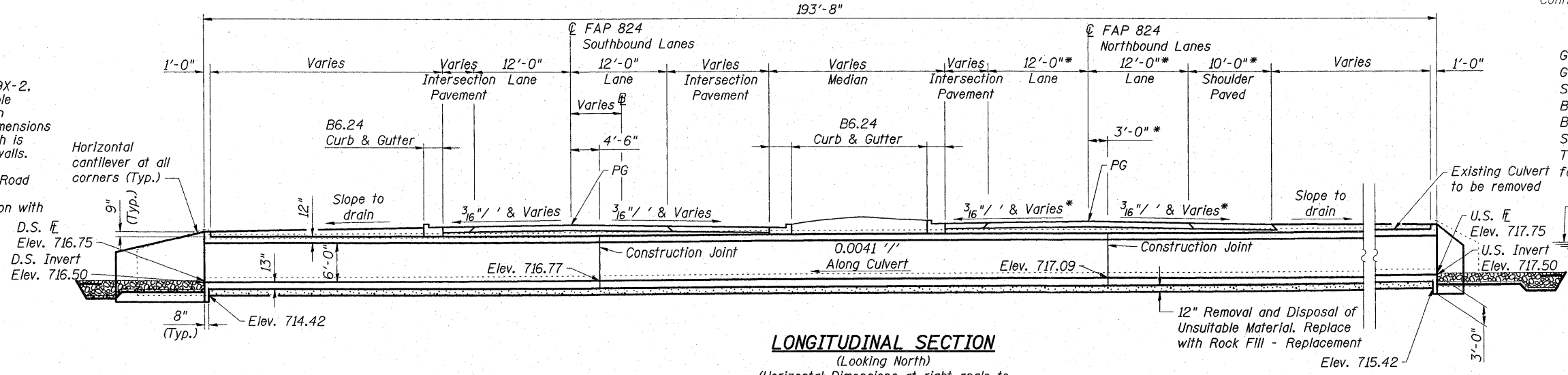

LONGITUDINAL SECTION
 (Looking North)
 (Horizontal Dimensions at right angle to
 @ FAP 824 southbound lanes unless noted otherwise)

* dimension at right angle
 to @ FAP 824 northbound lanes

WATERWAY INFORMATION

Drainage Area = 0.92 Sq. Mi.		Exist. Low Grade Elev. = 723.3 Ft. @ Sta. 1384+83.50		Prop. Low Grade Elev. = 723.3 Ft. @ Sta. 1384+83.50	
Flood	Freq. Yr.	Opening-Sq. Ft. C.F.S.	Nat. H.W.E.	Head-Ft. Exist.	Headwater El. Prop.
Design	10	477	722.0	1.2	723.2
Base	100	803	722.6	1.6	724.2
Overtopping	12	955	722.8	1.6	724.7
Overtopping	65	847	722.0	1.3	723.3
Overtopping			125	0.6	723.3

Sta. 1380+50 Elev. 726.18 (NB) Elev. 725.98 (SB)
 Sta. 1381+00 Elev. 725.81 (NB) Elev. 725.68 (SB)
 Sta. 1381+50 Elev. 725.53 (NB) Elev. 725.36 (SB)
 Sta. 1382+00 Elev. 725.13 (NB) Elev. 724.96 (SB)

PROFILE GRADE
 (Along @ of Lanes)

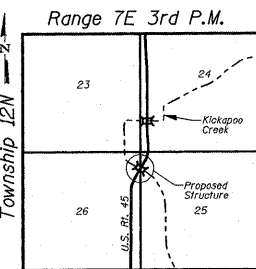

SCOUR INFORMATION

Design Scour Elevation (Ft.)	Upstream	Downstream
	714.50	713.50

ESCA
 CONSULTANTS, INC.

DESIGNED BY:	DAJ	07/08
DRAWN BY:	HAS	07/08
CHECKED BY:	ELH	09/08
APPROVED BY:	RDP	09/08

Note: Modify existing channel to match culvert at culvert ends as directed by the Engineer in the field. Cost included in Earth Excavation.



PLAN

APPROVED
 FOR STRUCTURAL ADEQUACY ONLY

Ralph Anderson
 ENGINEER OF BRIDGES AND STRUCTURES



EXPIRES 11-30-08
Richard J. Payne
 SIGNATURE
 7-29-08
 DATE

GENERAL PLAN
 US 45 OVER KICKAPOO CREEK
 FAP ROUTE 824
 SECTION (16-2, 19X-2)RS-1, 19B, 19BR
 COLES COUNTY
 STATION 1381+22.50
 STRUCTURE NO. 015-2023