

F.A.P. RTE.	SECTION	COUNTY	TOTAL SHEETS	SHEET NO.
310	60-15-2 60-15HB-2	MADISON	272	31
STA.		TO STA.		
FED. ROAD DIST. NO.		ILLINOIS FED. AID PROJECT		
CONTRACT NO. 76624				

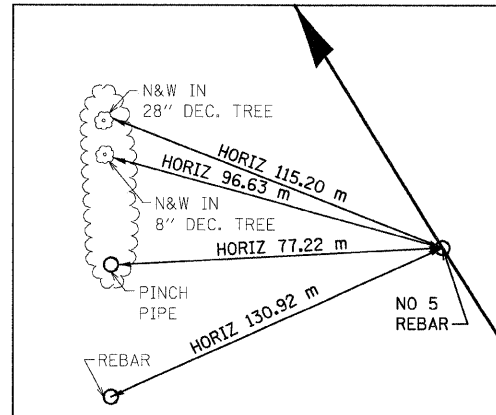

IL 255 MAINLINE POT
STA 39+505.000

N 255,335.0827 E 698,280.6163

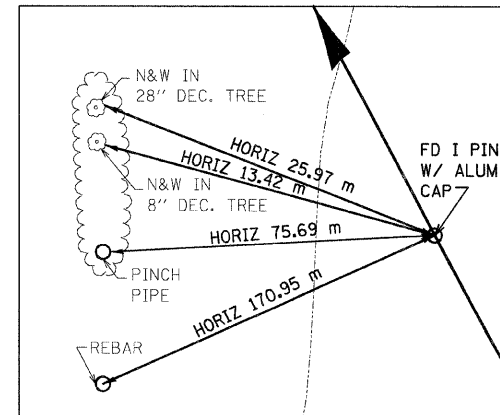

IL 255 MAINLINE PT
STA 39+561.606

N 255,384.0772 E 698,252.2896

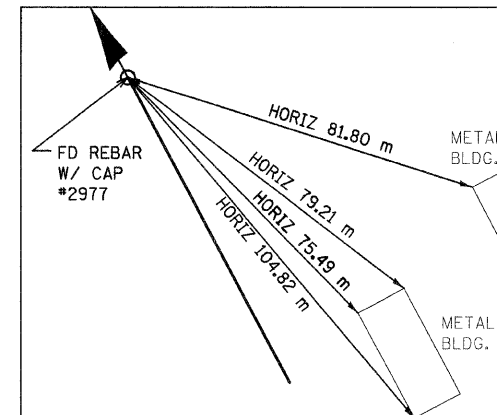

IL 255 MAINLINE PC
STA 40+086.205

N 255,847.4601 E 698,006.3632

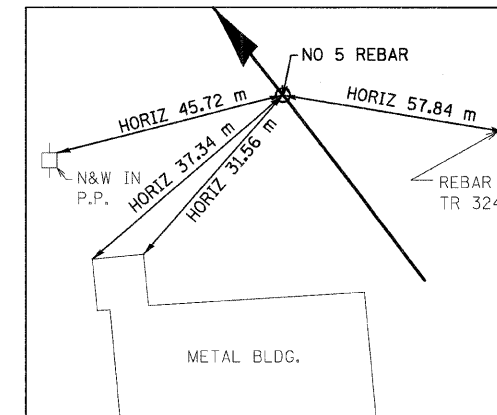

IL 255 MAINLINE POL
STA 40+260.000

N 255,993.0984 E 697,911.9303

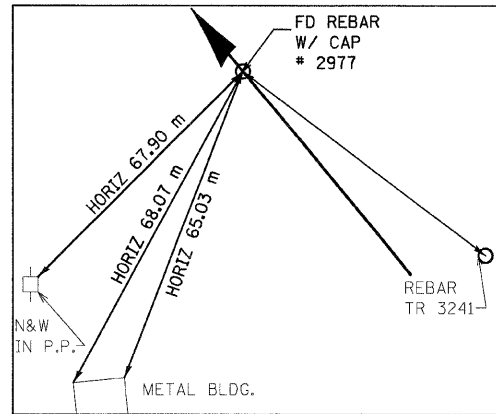

IL 255 MAINLINE PI
STA 40+295.227

N 256,032.0913 E 697,908.3758

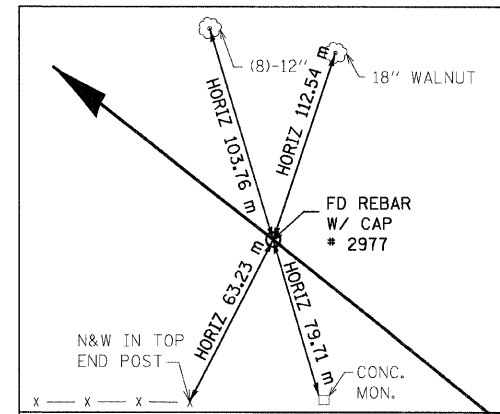

IL 255 MAINLINE PT
STA 40+498.257

N 256,161.6866 E 697,744.3781

NOTES:

- 1) DIMENSIONS LABELED "HORIZ" ARE HORIZONTAL PULLS.
- 2) DIMENSIONS NOT LABELED "HORIZ" ARE DIRECT PULLS.



(TYP ALL TIES THIS DWG)

REVISIONS	
NAME	DATE

ILLINOIS DEPARTMENT OF TRANSPORTATION
HORIZONTAL CONTROL TIES
FAP 310 (IL 255)
SECTION 60-15-2 & 60-15HB-2
MADISON COUNTY
DRAWN BY KAH
CHECKED BY
DATE