

F.A.P. RTE.	SECTION	COUNTY	TOTAL SHEETS	SHEET NO.
310	60-15-2 60-15HB-2	MADISON	272	40
STA.		TO STA.		
FED. ROAD DIST. NO.		ILLINOIS FED. AID PROJECT		
CONTRACT NO. 76624				

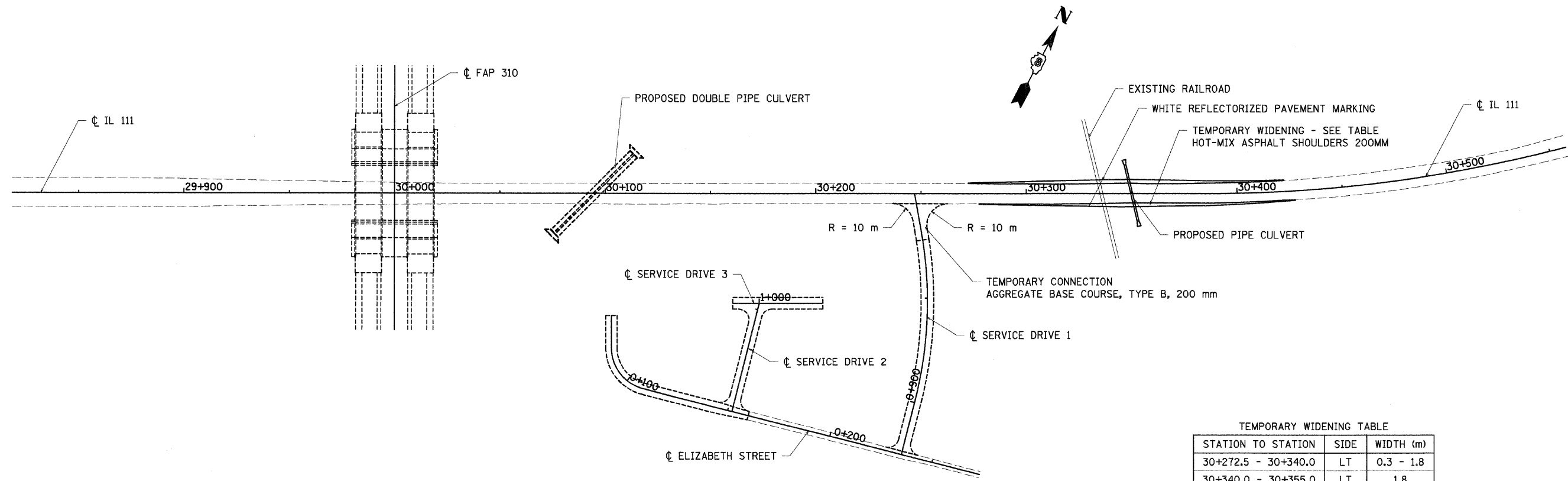

TEMPORARY WIDENING TABLE

STATION TO STATION	SIDE	WIDTH (m)
30+272.5 - 30+340.0	LT	0.3 - 1.8
30+340.0 - 30+355.0	LT	1.8
30+355.0 - 30+422.5	LT	1.8 - 0.3

TEMPORARY WIDENING TABLE

STATION TO STATION	SIDE	WIDTH (m)
30+277.5 - 30+345.0	RT	0.3 - 1.8
30+345.0 - 30+360.0	RT	1.8
30+360.0 - 30+427.5	RT	1.8 - 0.3

**STAGE CONSTRUCTION SEQUENCE**

THE FOLLOWING STAGE CONSTRUCTION SEQUENCE IS FOR INFORMATION ONLY. THE CONTRACTOR IS RESPONSIBLE FOR PLANNING AND EXECUTING THIS PROJECT WHICH SHALL BE SUBJECT TO THE APPROVAL OF THE ENGINEER.

STAGE CONSTRUCTION OF IL 111

STAGE 3C

STAGE CONSTRUCT THE PIPE CULVERT AT STATION 30+350. UTILIZE TRAFFIC CONTROL AND PROTECTION STANDARD 701201. TEMPORARY WIDENING RIGHT FROM STATION 30+277.5 TO STATION 30+427.5 WILL BE NECESSARY TO PROVIDE ADDITIONAL ROADWAY WIDTH DURING CONSTRUCTION. UTILIZE TRAFFIC CONTROL AND PROTECTION STANDARD 701326. THE LEFT SIDE OF THE PIPE CULVERT SHALL BE CONSTRUCTED. ANY OPEN TRENCH MUST BE FILLED BY THE END OF THE WORKING DAY AND THE PAVEMENT PATCHED TO MAINTAIN TWO WAY TRAFFIC DURING NON-WORKING HOURS.

STAGE CONSTRUCT THE REMAINING PIPE CULVERT AT STATION 30+350. UTILIZE TRAFFIC CONTROL AND PROTECTION STANDARD 701201. TEMPORARY WIDENING LEFT FROM STATION 30+272.5 TO STATION 30+422.5 WILL BE NECESSARY TO PROVIDE ADDITIONAL ROADWAY WIDTH DURING CONSTRUCTION. UTILIZE TRAFFIC CONTROL AND PROTECTION STANDARD 701326. THE REMAINDER OF THE PROPOSED PIPE CULVERT SHALL BE CONSTRUCTED. ANY OPEN TRENCH MUST BE FILLED BY THE END OF THE WORKING DAY AND THE PAVEMENT PATCHED TO MAINTAIN TWO WAY TRAFFIC DURING NON-WORKING HOURS.

**NOTES:**

- 1) GRADING WILL BE REQUIRED TO PROVIDE 1:3 SLOPES FROM THE TEMPORARY WIDENING TO THE EXISTING GROUND. THIS WORK WILL NOT BE PAID FOR SEPARATELY, BUT SHALL BE CONSIDERED INCLUDED IN THE CONTRACT UNIT PRICE PER SQUARE METER FOR HOT-MIX ASPHALT SHOULDERS 200MM.
- 2) THE REMOVAL OF THE TEMPORARY WIDENING WILL BE PAID FOR AT THE CONTRACT UNIT PRICE PER SQUARE METER FOR PAVED SHOULDER REMOVAL. THIS WORK WILL INCLUDE THE REMOVAL OF THE GRADING THAT WAS REQUIRED TO CONSTRUCT THE TEMPORARY WIDENING.
- 3) MINIMUM LANE WIDTHS OF 3.6 m (12') SHALL BE PROVIDED.
- 4) THE CONTRACTOR SHALL NOT STOP TRAFFIC ON THE RAILROAD TRACKS.

REVISIONS	
NAME	DATE

ILLINOIS DEPARTMENT OF TRANSPORTATION  
**STAGE CONSTRUCTION**  
**FAP 310 (IL 255)**  
**SECTION 60-15-2 & 60-15HB-2**  
**MADISON COUNTY**  
 DRAWN BY EBB  
 CHECKED BY  
 DATE

12/7/2007

p:\00f1\es\000024\di111\detail\misc\stage-construction.dgn