

F.A.P. RTE.	SECTION	COUNTY	TOTAL SHEETS	SHEET NO.
310	60-15-2 60-15HB-2	MADISON	272	95
STA.		TO STA.		
FED. ROAD DIST. NO.		ILLINOIS FED. AID PROJECT		
CONTRACT NO. 76624				

ADDITIONAL PERMANENT PAVEMENT STRIPING WILL BE DONE DURING CONTRACT 60-15

PRISMATIC REFLECTORS ON CURBS WILL BE INCLUDED IN THIS CONTRACT. SEE SHEET 152 FOR THE PLACEMENT OF THE REFLECTORS.

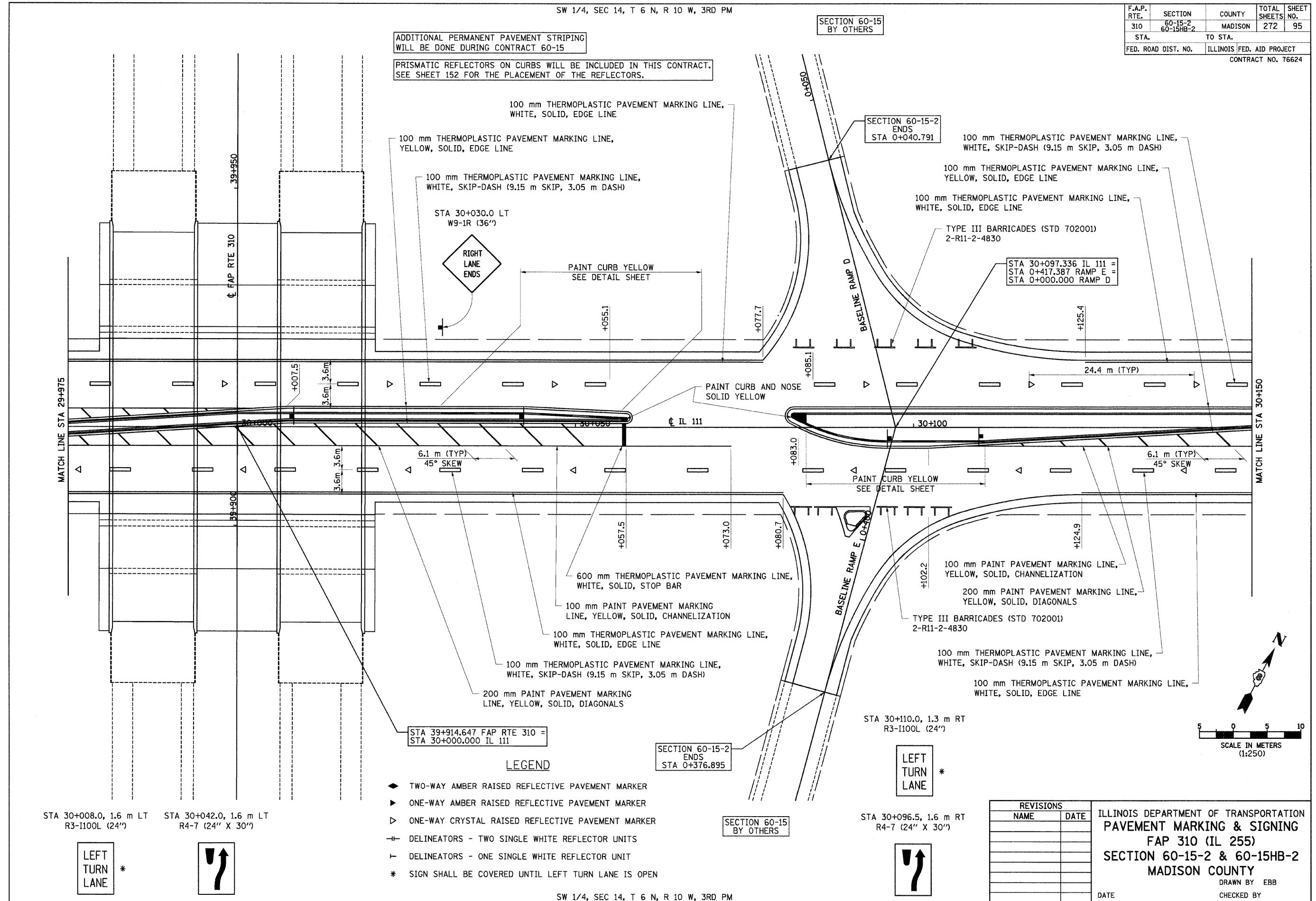

12/7/2007

p:\00f.iles\000024\dl\111\pvm\mkr\ks\pvm\015c02.dgn

STA 30+008.0, 1.6 m LT R3-I100L (24")

STA 30+042.0, 1.6 m LT R4-7 (24" X 30")

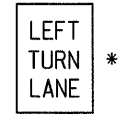

- LEGEND**
- ◆ TWO-WAY AMBER RAISED REFLECTIVE PAVEMENT MARKER
 - ▶ ONE-WAY AMBER RAISED REFLECTIVE PAVEMENT MARKER
 - ▷ ONE-WAY CRYSTAL RAISED REFLECTIVE PAVEMENT MARKER
 - DELINEATORS - TWO SINGLE WHITE REFLECTOR UNITS
 - ┴ DELINEATORS - ONE SINGLE WHITE REFLECTOR UNIT
 - * SIGN SHALL BE COVERED UNTIL LEFT TURN LANE IS OPEN

SECTION 60-15-2 ENDS STA 0+376.895

SECTION 60-15 BY OTHERS

STA 30+110.0, 1.3 m RT R3-I100L (24")

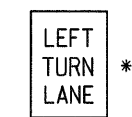

STA 30+096.5, 1.6 m RT R4-7 (24" X 30")



REVISIONS	
NAME	DATE

ILLINOIS DEPARTMENT OF TRANSPORTATION
PAVEMENT MARKING & SIGNING
 FAP 310 (IL 255)
 SECTION 60-15-2 & 60-15HB-2
 MADISON COUNTY

DRAWN BY EBB
 CHECKED BY
 DATE