

TRAFFIC SIGNAL QUANTITIES - RAMPS E & D			
QTY	UNIT	ITEM	LOCATION
1	EACH	SERVICE INSTALLATION (SPECIAL)	
3	EACH	HANDHOLE, PORTLAND CEMENT CONCRETE	
1	EACH	DOUBLE HANDHOLE, PORTLAND CEMENT CONCRETE	
1	EACH	FULL-ACTUATED CONTROLLER AND TYPE IV CABINET	
6	EACH	TRAFFIC SIGNAL BACKPLATE	A, C
2	EACH	TRAFFIC SIGNAL POST, ALUMINUM 3.95 METER	D, E
1	EACH	TRAFFIC SIGNAL POST, ALUMINUM 4.55 METER	B
1	EACH	STEEL MAST ARM ASSEMBLY AND POLE 12.80 METER	C
1	EACH	STEEL MAST ARM ASSEMBLY AND POLE WITH DUAL MAST ARMS, 12.80 METER AND 10.97 METER	A
2.7	METER	CONCRETE FOUNDATION, TYPE A	B, D, E
0.9	METER	CONCRETE FOUNDATION, TYPE D	CONTROLLER
8.3	METER	CONCRETE FOUNDATION, TYPE E 75MM DIAMETER	A, C
2	EACH	SIGNAL HEAD, POLYCARBONATE, LED, 1-FACE, 3-SECTION, BRACKET MOUNTED	D, E
5	EACH	SIGNAL HEAD, POLYCARBONATE, LED, 1-FACE, 3-SECTION, MAST ARM MOUNTED	A, C
1	EACH	SIGNAL HEAD, POLYCARBONATE, LED, 1-FACE, 5-SECTION, MAST ARM MOUNTED	C
1	EACH	SIGNAL HEAD, POLYCARBONATE, LED, 3-FACE, 2-3 SECTION, 1-5 SECTION, BRACKET MOUNTED	B
1	EACH	VIDEO VEHICLE DETECTION SYSTEM	

STRUCTURE LOCATION	
ITEM	LOCATION
CONTROLLER	30+105.0 19.0 RT
SERVICE	30+115.0 23.0 RT
A	30+075.0 15.0 LT
B	30+113.7 14.0 LT
C	30+112.1 15.0 RT
D	30+102.0 19.0 RT
E	30+074.0 14.0 RT
HH-1	30+079.0 17.0 LT
HH-2	30+104.0 17.0 LT
HH-3	30+076.0 13.0 RT
DH-1	30+104.0 17.0 RT

F.A.P. RTE.	SECTION	COUNTY	TOTAL SHEETS	SHEET NO.
310	60-15-2 60-15HB-2	MADISON	272	100
STA.		TO STA.		
FED. ROAD DIST. NO.		ILLINOIS FED. AID PROJECT		
CONTRACT NO. 76624				

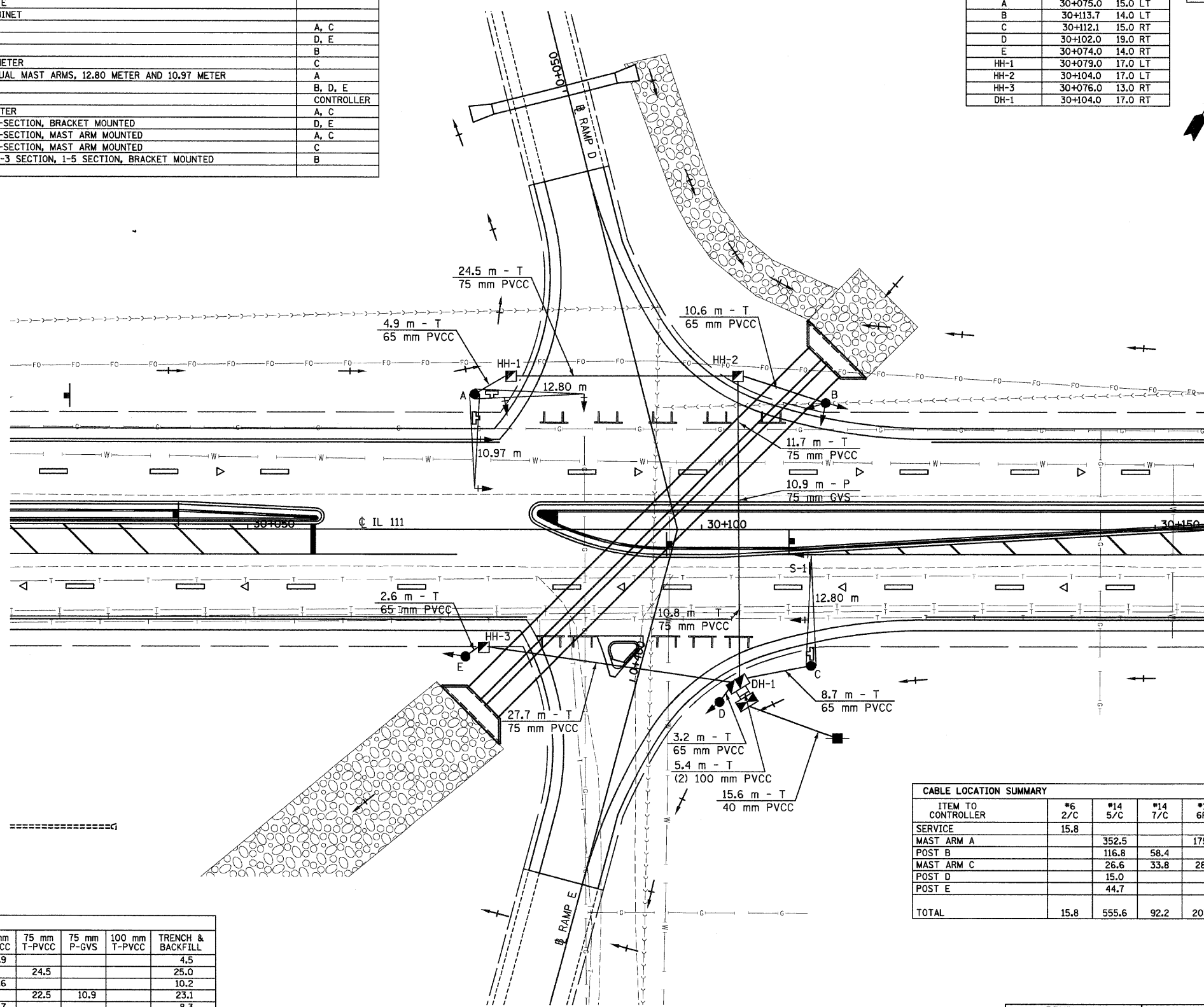

S-1  
(ON MAST ARM C)  
SIGN PANEL, TY 1, 0.47 sq m  
R10-12 2430 (600 mm x 750 mm)  
NOT TO SCALE

CABLE LOCATION SUMMARY				
ITEM TO CONTROLLER	#6 2/C	#14 5/C	#14 7/C	#18 6PR
SERVICE	15.8			
MAST ARM A		352.5		175.4
POST B		116.8	58.4	
MAST ARM C		26.6	33.8	28.5
POST D		15.0		
POST E		44.7		
TOTAL	15.8	555.6	92.2	203.9

CONDUIT LOCATION SUMMARY						
LOCATION	40 mm T-PVCC	65 mm T-PVCC	75 mm T-PVCC	75 mm P-GVS	100 mm T-PVCC	TRENCH & BACKFILL
MAST ARM "A" to HH-1		4.9				4.5
HH-1 to HH-2			24.5			25.0
SIGNAL "B" to HH-2		10.6				10.2
HH-2 to DH-1			22.5	10.9		23.1
MAST ARM "C" to DH-1		8.7				8.3
SIGNAL "D" to DH-1		3.2				2.2
SIGNAL "E" to HH-3		2.6				2.5
HH-3 to DH-1			27.7			28.3
DH-1 to CONTROLLER					5.4	4.4
SERVICE TO CONTROLLER	15.6					10.8
TOTAL	15.6	30.0	74.6	10.9	5.4	119.6

REVISIONS	
NAME	DATE

ILLINOIS DEPARTMENT OF TRANSPORTATION  
TRAFFIC SIGNAL PLAN  
FAP 310 (IL 255)  
SECTION 60-15-2 & 60-15HB-2  
MADISON COUNTY  
DRAWN BY  
CHECKED BY  
DATE

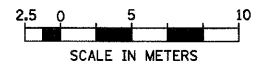

12/7/2007

pt:\00files\000024\dl\111\signals\sig01f.g015c.dgn