

4:11:53 PM

11/3/2008

BM 3023 - Chiseled "X" on west flange bolt of fire hydrant located on south side of IL 111 in front of Rister's Auto - IL 111 Sta 30+095.27 m Rt. Elev. 187.116

Existing Structure - None

INDEX OF SHEETS

1. General Plan and Elevation
2. Total Bill of Materials, General Notes & Footing Layout
3. Top of Slab Elevations
4. Top of Slab Elevations
5. Superstructure
6. Superstructure Details
7. South Approach Slabs (1 of 2)
8. South Approach Slabs (2 of 2)
9. North Approach Slabs (1 of 2)
10. North Approach Slabs (2 of 2)
11. Framing Plans & Girder Details
12. Girder Details
13. Bearing Details
14. South Abutments (1 of 2)
15. South Abutments (2 of 2)
16. North Abutments (1 of 2)
17. North Abutments (2 of 2)
18. Pile Details
19. Slope and Concrete Texture Details
20. Preformed Joint Strip Seal
21. Anchor Bolt Details for Bearings
- 22-24. Soil Boring Logs

STATION 39+914.647
 BUILT 200_ BY
 STATE OF ILLINOIS
 F.A.P. RT. 310 SEC. 60-15HB-2

LOADING MS18
 STR. NO. 060-0330

NAME PLATE

See Std. 515001 (2 Required)

(N.B. Bridge shown, S.B. Bridge same except Str. No. 060-0331)

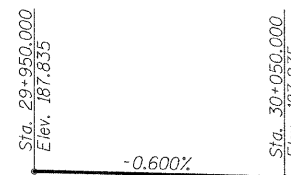

IL 111 PROFILE

(Along Median Edge)

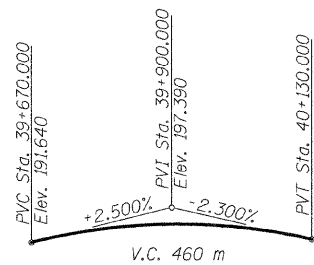

FAP 310 PROFILE

(Along Median Edge)

DESIGNED	ADL
CHECKED	WLW
DRAWN	DGM/ADL
CHECKED	WLW

KLINGNER & ASSOCIATES, P.C.

Engineers • Architects • Surveyors

605 North 24th Street, Aurora, IL Ph. (630) 222-2678 Fax (630) 222-2583
 4200 Pershing Road, Homewood, IL Ph. (708) 221-8820 Fax (708) 221-8822
 600 N. 4th Street, Suite 100, Arlington, IL Ph. (815) 753-6536 Fax (815) 752-5886
 45 North Prairie Street, Calumet, IL Ph. (815) 942-4842 Fax (815) 942-3781

Internet Address: www.klingner.com
 STATE OF ILLINOIS DESIGN FIRM # 1842738

SEISMIC DATA

Seismic Performance Category (SPC) = A
 Bedrock Acceleration Coefficient (A) = 0.080g
 Site Coefficient (S) = 1.0

DESIGN SPECIFICATIONS

AASHTO 1996 with 1997, 1998, 1999 & 2000 Interims

LOADING MS18

Allow 2.4 kN/m² for future wearing surface.

DESIGN STRESSES

FIELD UNITS
 f'c = 24 MPa
 fy = 400 MPa (reinf.)
 fy = 250 MPa (M270M Grade 250)
 fy = 345 MPa (M270M Grade 345)

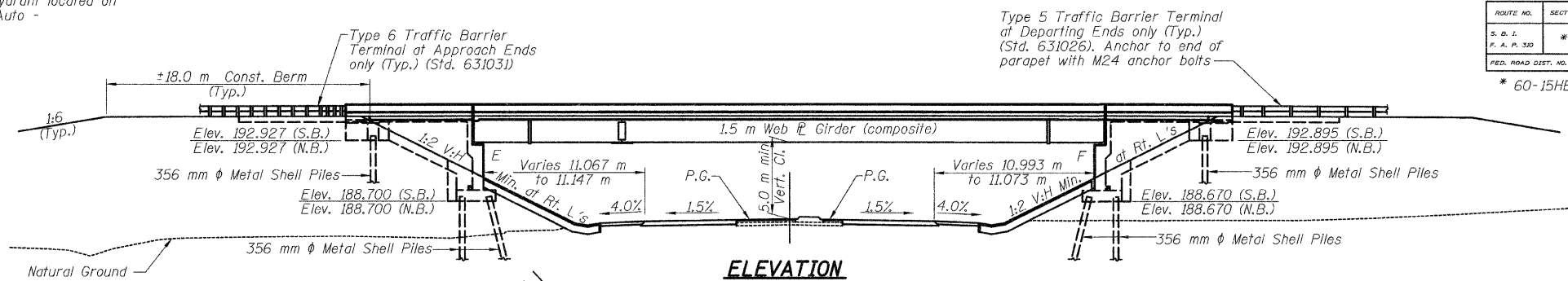

ELEVATION

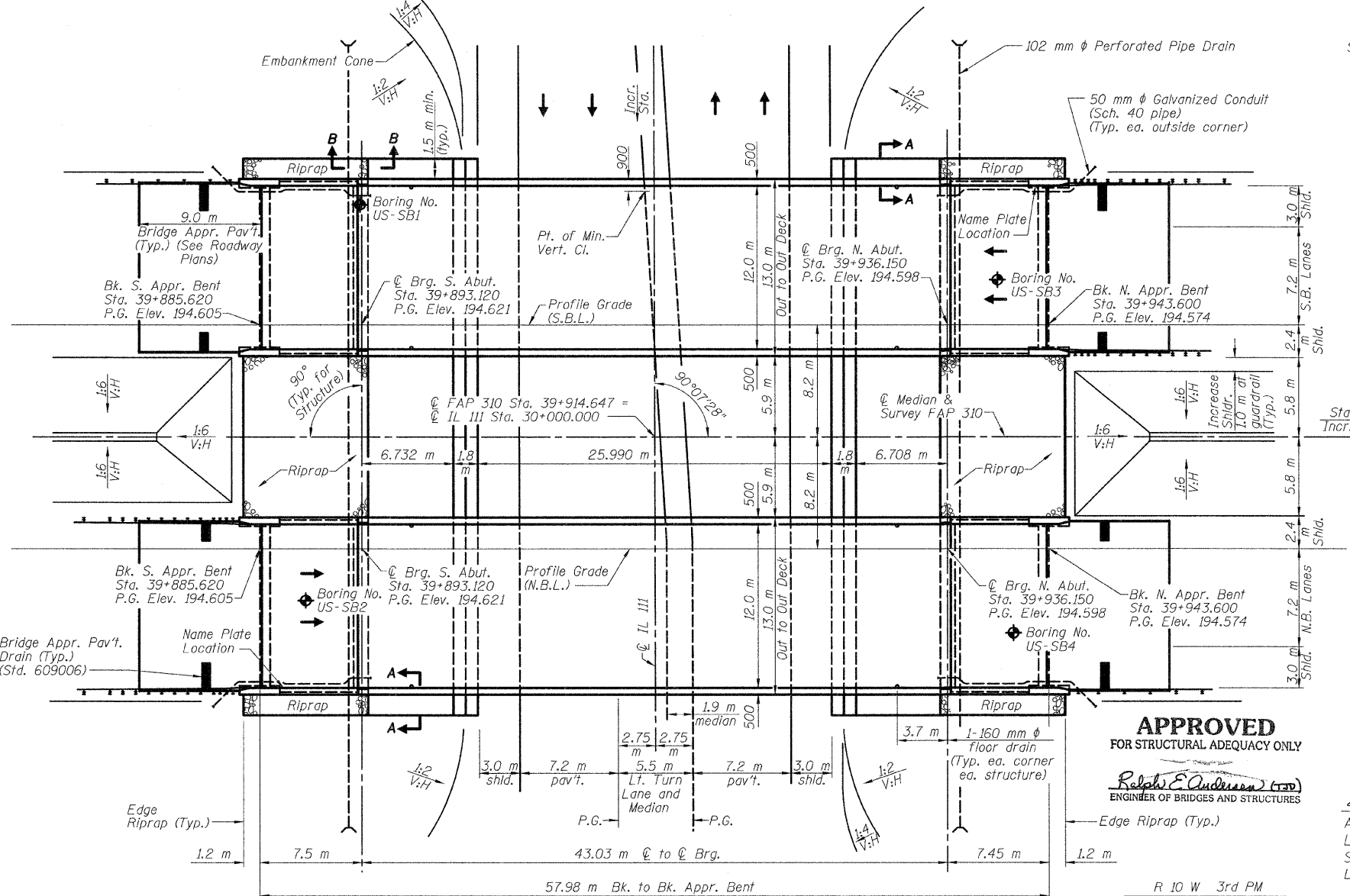

PLAN

ROUTE NO.	SECTION	COUNTY	TOTAL SHEETS	SHEET NO.
S. D. I. F. A. P. 310	*	MADISON	272	102
ILLINOIS FED. AID PROJECT				
* 60-15HB-2 CONTRACT NO. 76624				

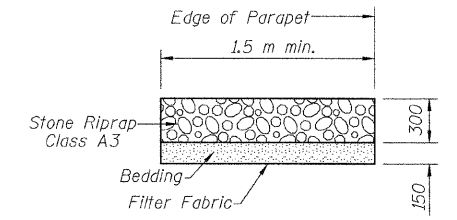

RIPRAP DETAIL

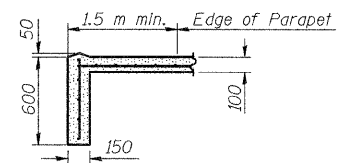

SECTION A-A

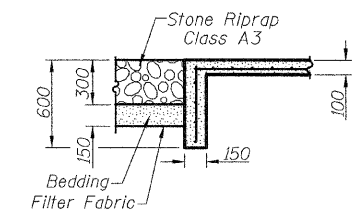

SECTION B-B BETWEEN RIPRAP AND CONCRETE SLOPEWALL



Alan D. Lukens 11-4-08 Date
 Licensed Structural Engineer
 State of Illinois No. 081-005167
 License Expires 11/30/10

APPROVED FOR STRUCTURAL ADEQUACY ONLY

Robert E. Anderson (TS)
 ENGINEER OF BRIDGES AND STRUCTURES

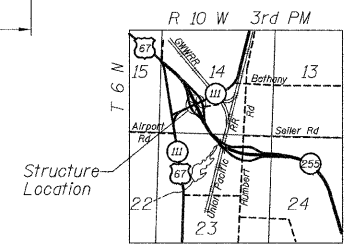

LOCATION SKETCH

GENERAL PLAN
 FAP RTE. 310 (IL RTE 255) OVER
 IL RTE 111
 SECTION 60-15HB-2
 MADISON COUNTY
 STATION 39+914.647
 SN 060-0330 (NB) & 060-0331 (SB)

Klingner & Assoc., P.C.