

bgj

12/7/2007

p:\001\1es\000024\d1111\crosssections\sec015c.dgn

FAP RTE	SECTION	COUNTY	TOTAL SHEETS	SHEET NO.
310	60-15-2 60-15HB-2	MADISON	272	159
STA.		TO STA.		
FED. ROAD DIST. NO.		ILLINOIS FED. AID PROJECT		
CONTRACT NO. 76624				

FINAL SURVEY	DATE
BY	
NO. AREAS CHECKED	
NO. AREAS CHECKED	

ORIGINAL SURVEY	DATE
BY	
NO. AREAS CHECKED	
NO. AREAS CHECKED	

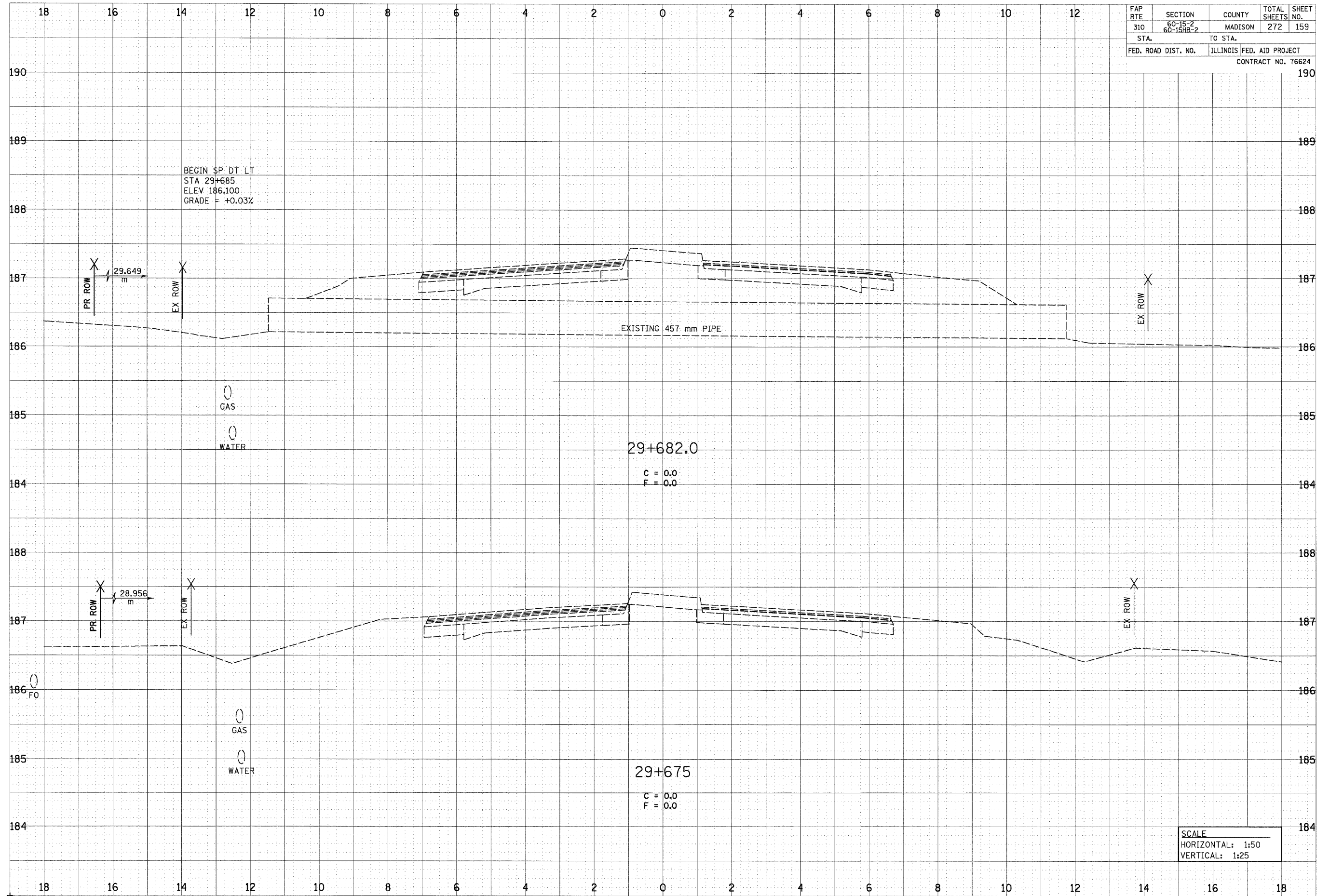

BEGIN SP. DT. LT.
 STA 29+685
 ELEV 186.100
 GRADE = +0.03%

EXISTING 457 mm PIPE

29+682.0
 C = 0.0
 F = 0.0

29+675
 C = 0.0
 F = 0.0

SCALE
 HORIZONTAL: 1:50
 VERTICAL: 1:25

IL 111, STA 29+675 TO STA 29+682.0