

RELOC. IL 3
 CURVE 184
 P.I. STA. = 783+43.79
 $\Delta = 11^\circ 19' 55.93''$ (LT)
 $D = 3^\circ 44' 53.82''$
 $R = 1,528.59'$
 $T = 151.66'$
 $L = 302.33'$
 $E = 7.51'$
 $e = \text{NORMAL CROWN}$
 P.C. STA = 781+92.13
 P.T. STA = 784+94.46

NOTES:

1. SEE REMOVAL PLANS FOR ALL DEMOLITION BETWEEN STA. 784+00 TO STA. 790+00.
2. SEE INTERSECTION DETAIL SHEETS 112 AND 113 FOR BROADWAY / 2ND STREET DETAILS AND PAVEMENT TRANSITIONS.
3. TRANSITION BACK CURB TO SIDEWALK OFFSET AS FOLLOWS;
 FROM 5.0' AT STA. 788+55 TO 3.5' AT STA. 788+85.
 FROM 3.5' AT STA. 788+95 TO 5.0' AT STA. 789+25
4. SEE GENERAL PLAN NOTE ON SHEET 44.

RELOC. IL 3
 CURVE 185
 P.I. STA = 789+67.23
 $\Delta = 33^\circ 54' 08.57''$ (LT)
 $D = 10^\circ 00' 00.00''$
 $R = 572.96'$
 $T = 174.64'$
 $L = 339.02'$
 $E = 26.02'$
 $e = 0.040$
 T.R. (BEGIN OF CURVE, S.B.) = 55'
 T.R. (BEGIN OF CURVE, N.B.) = 35'
 S.E. RUN = 135'
 P.C. STA = 787+92.59
 P.T. STA = 791+31.61

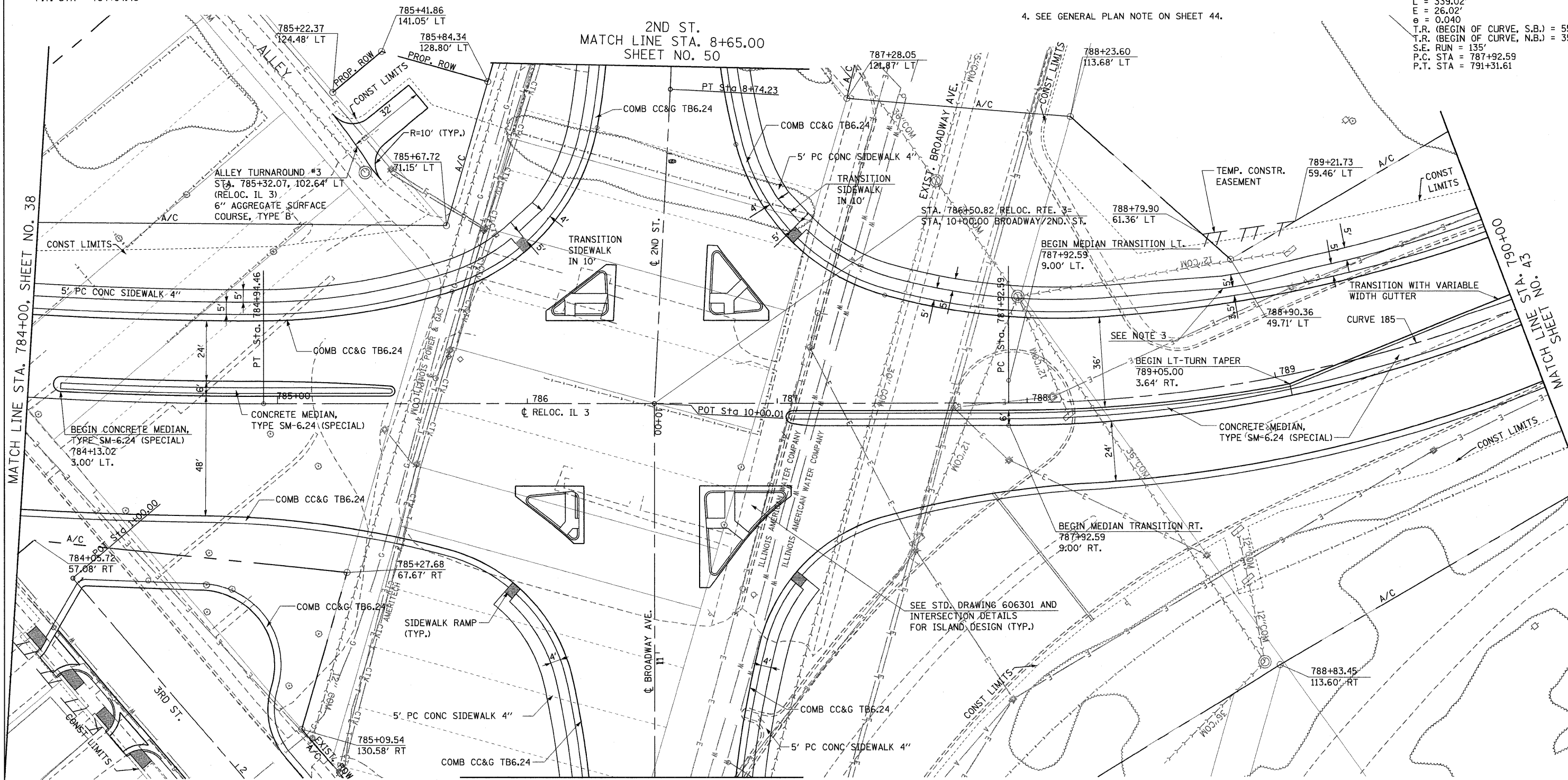

BROADWAY AVE.
 MATCH LINE STA. 11+50.00
 SHEET NO. 51

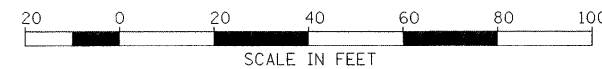

| | | | | | | | | | | | | |
|-----------------------------|------------------------|----------------------|-----------|---|---|--------------------------|----------------------------|--------------------|----------------|------------------|--------------|--|
| FILE NAME = r3mpt24_new.dgn | USER NAME = weaverlg | DESIGNED - L. WEAVER | REVISED - | STATE OF ILLINOIS DEPARTMENT OF TRANSPORTATION | RELOCATED IL 3 PLAN - STA. 784+00 TO STA. 790+00 | | F.A. RTE. 788 | SECTION 520-2-2 | COUNTY MADISON | TOTAL SHEETS 173 | SHEET NO. 41 | |
| PLOT SCALE = #SCALE# | PLOT DATE = 02/02/2009 | DRAWN - L. WEAVER | REVISED - | | SCALE: | SHEET NO. 6 OF 19 SHEETS | STA. 784+00 TO STA. 790+00 | CONTRACT NO. 76633 | | | | |
| | | CHECKED - A. FREY | REVISED - | | FED. ROAD DIST. NO. ILLINOIS FED. AID PROJECT | | | | | | | |
| | | DATE - 02/06/2009 | REVISED - | | | | | | | | | |