







LEGEND

-  SEEDING CLASS 2A
-  SEEDING CLASS 3
-  SEEDING CLASS 4B
-  RIPRAP
-  PERIMETER EROSION BARRIER- SILT FILTER FENCE OR OTHER AS APPROVED BY THE ENGINEER
-  INLET AND PIPE PROTECTION- STRAW BALES, FILTER FABRIC, AGGREGATES, ROLLED EXCELSIOR

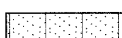

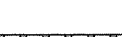
- NOTES:**
1. TEMPORARY SEEDING QUANTITIES INCLUDE FOUR (4) TIMES ONE TOTAL COVER APPLICATION (ENTIRE CONSTRUCTION LIMITS) TYPE 1 MULCH SHALL BE USED ON ALL TEMPORARY SEEDING.
 2. CLASS 2A SEEDING QUANTITIES INCLUDE ALL NON-PAVEMENT CONSTRUCTION AREAS EXCEPT THE FOLLOWING:
 - A) DETENTION BASIN (CLASS 4B)
 - B) 3:1 SIDE SLOPES FOR RIGHT SIDE OF RELOC. IL 3 (STA 775+10 TO 777+00) AND RELOC. IL 3 (STA. 790+50 TO 792+15). (CLASS 3)
 3. ALL AREAS THAT ARE 3:1 OR STEEPER SHOULD BE SEEDED AND FERTILIZED USING A HYDRAULIC SEEDER.
 4. EROSION CONTROL BLANKET SHALL BE USED OVER ALL PERMANENT SEEDING.

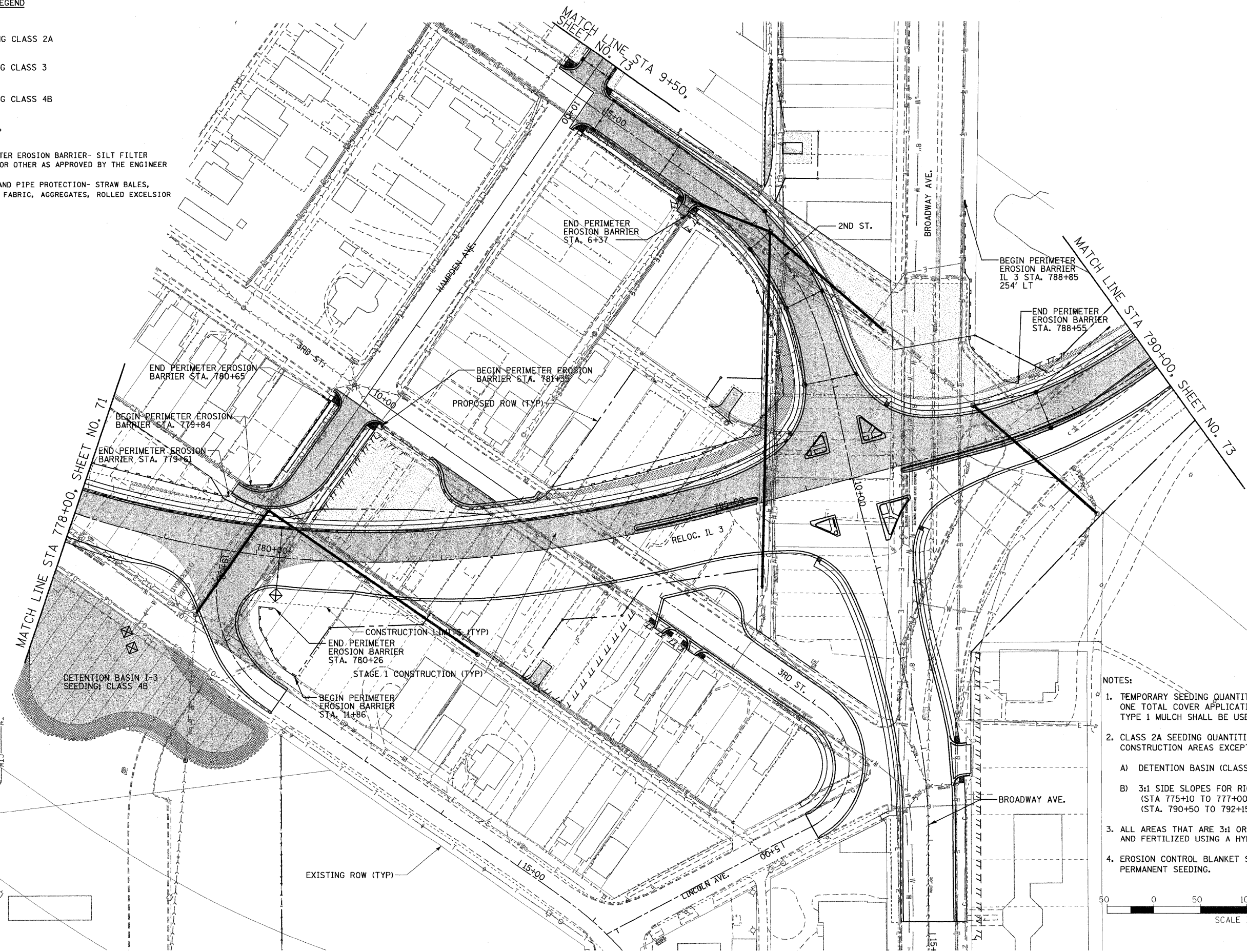
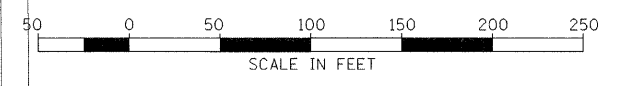

FILE NAME = r3nspp.stage1.02new.dgn	USER NAME = weaverlg	DESIGNED - A. PENICK	REVISED -	STATE OF ILLINOIS DEPARTMENT OF TRANSPORTATION	EROSION AND SEDIMENT CONTROL PLAN (CONSTRUCTION STAGE 1)	F.A. RTE. 788	SECTION 520-2-2	COUNTY MADISON	TOTAL SHEETS 173	SHEET NO. 72	
PLOT SCALE = \$SCALE\$		DRAWN - A. PENICK	REVISED -			SCALE: SHEET NO. 2 OF 9 SHEETS STA. TO STA.		FED. ROAD DIST. NO. ILLINOIS FED. AID PROJECT			
PLOT DATE = 02/02/2009		CHECKED - A. FREY	REVISED -			CONTRACT NO. 76633					
		DATE - 02/06/2009	REVISED -								