

1:34:12 PM

p:\00files\00024\dhumbert\planprofiles\drprofile015b03.dgn

FINAL SURVEYED	BY	DATE
SURVEY PLOTTED		
NOTE BOOK TEMPLATE		
AREAS CHECKED		
NO.		

ORIGINAL SURVEYED	BY	DATE
SURVEY PLOTTED		
NOTE BOOK TEMPLATE		
AREAS CHECKED		
NO.		

F.A.P. RTE.	SECTION	COUNTY	TOTAL SHEETS	SHEET NO.
310	60-15-1, 60-15HB-1	MADISON	238	54
STA.	TO STA.			
FED. ROAD DIST. NO.	ILLINOIS FED. AID PROJECT			
CONTRACT NO. 76635				

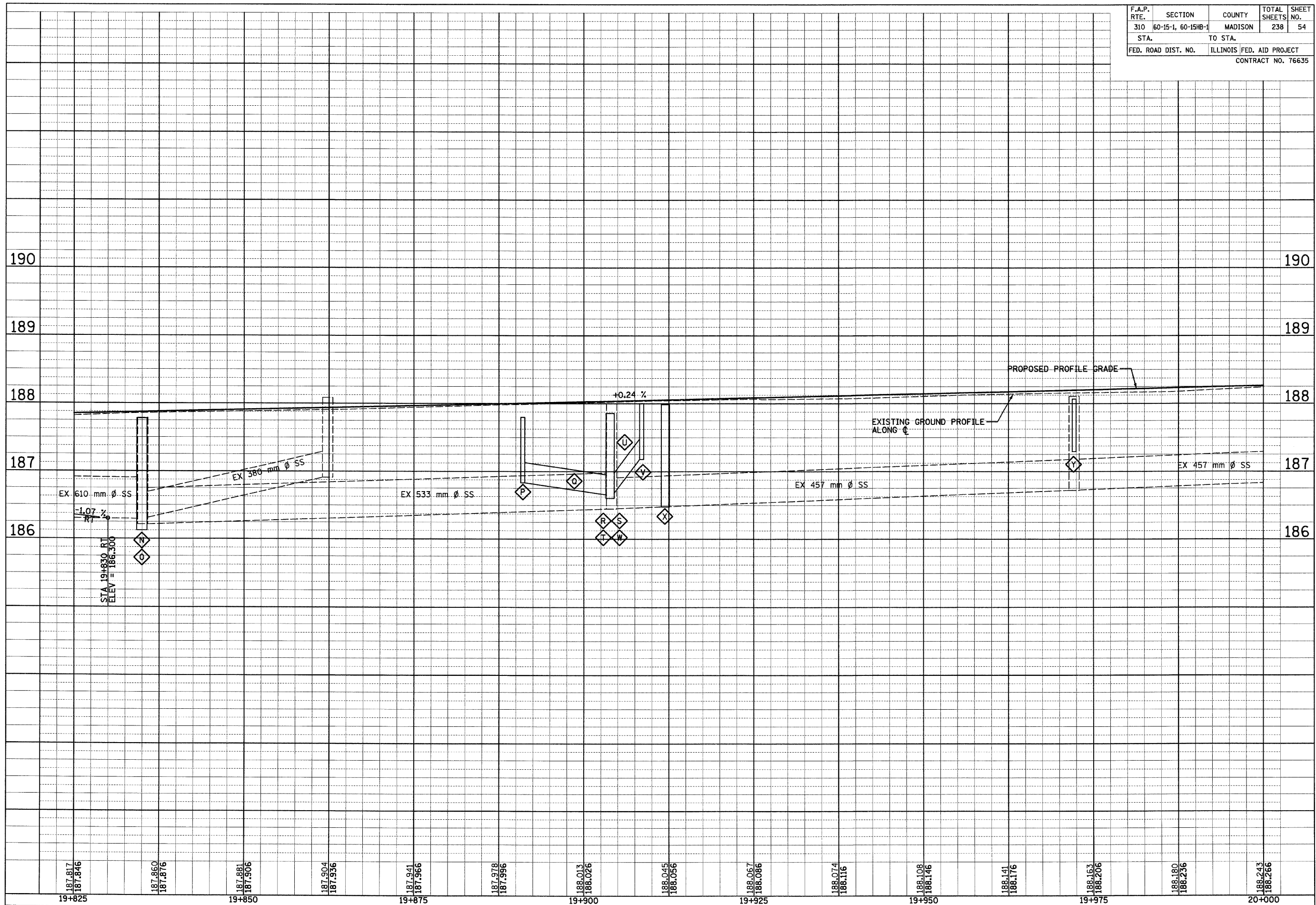

187.817 187.846	187.860 187.876	187.881 187.906	187.904 187.936	187.941 187.966	187.978 187.996	188.013 188.026	188.045 188.066	188.067 188.086	188.074 188.116	188.108 188.146	188.141 188.176	188.163 188.206	188.180 188.236	188.243 188.266
19+825		19+850		19+875		19+900		19+925		19+950		19+975		20+000

DRAINAGE PROFILE HUMBERT ROAD STA 19+825 TO STA 20+000