

1:36:48 PM

p:\00files\00024\dhumbert\planprofiles\dr-profile\1e015b06.dgn

FINAL SURVEYED	BY	DATE
SURVEY PLOTTED		
NOTE BOOK TEMPLATE		
AREAS CHECKED		
NO.		

ORIGINAL SURVEYED	BY	DATE
SURVEY PLOTTED		
NOTE BOOK TEMPLATE		
AREAS CHECKED		
NO.		

F.A.P. RTE.	SECTION	COUNTY	TOTAL SHEETS	SHEET NO.
310	60-15-1, 60-15HB-1	MADISON	238	60
STA. 20+350		TO STA.	20+525	
FED. ROAD DIST. NO.		ILLINOIS	FED. AID PROJECT	
CONTRACT NO. 76635				

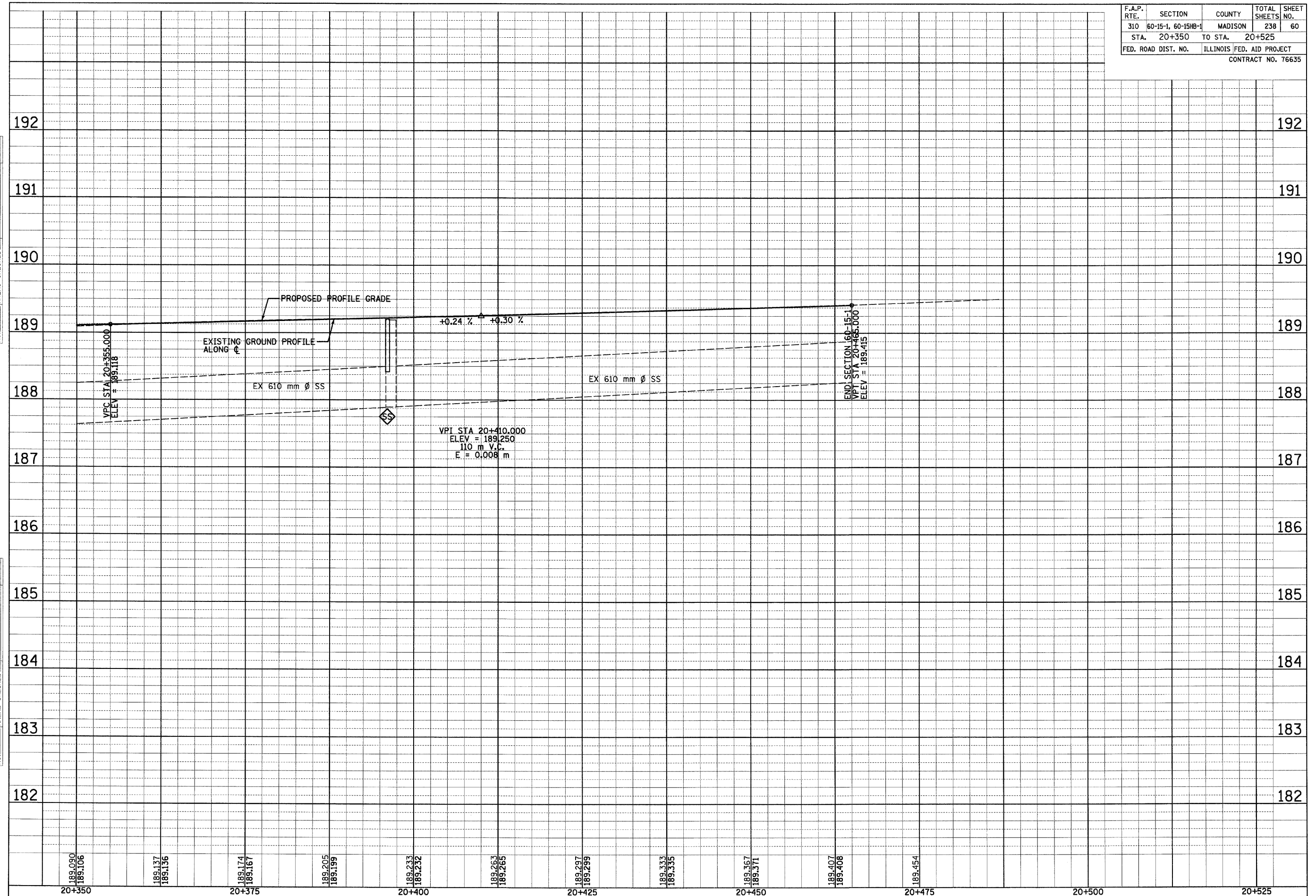

189.090	189.106	189.137	189.136	189.174	189.167	189.205	189.199	189.233	189.232	189.263	189.265	189.297	189.299	189.333	189.335	189.367	189.371	189.407	189.408	189.454	
20+350				20+375				20+400				20+425				20+450			20+475		

DRAINAGE PROFILE HUMBERT ROAD STA 20+350 TO STA 20+465