

F.A.P. RTE.	SECTION	COUNTY	TOTAL SHEETS	SHEET NO.
310	60-15-1, 60-15HB-1	MADISON	238	87
STA.		TO STA.		
FED. ROAD DIST. NO.		ILLINOIS FED. AID PROJECT		
CONTRACT NO. 76635				

**PAVEMENT JOINT LEGEND**

- EXPANSION JOINT 
  - SAWED LONGITUDINAL 
  - TIED LONGITUDINAL CONSTRUCTION 
  - SAWED CONTRACTION 
- SEE STANDARDS 420001 & 420106 FOR DETAILS

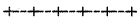
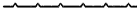
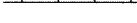
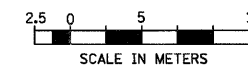
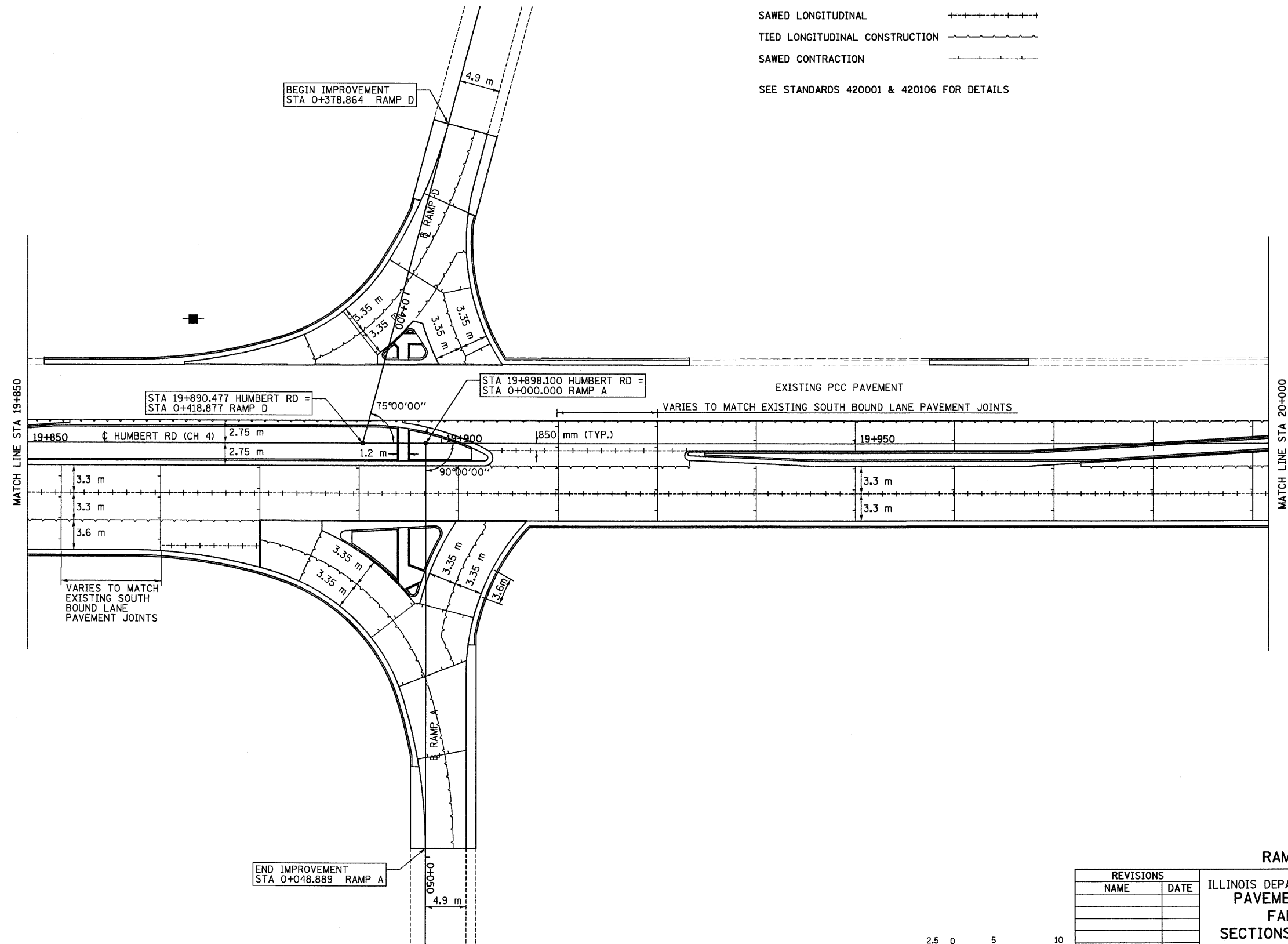

REVISIONS	
NAME	DATE

**RAMP A & RAMP D**

ILLINOIS DEPARTMENT OF TRANSPORTATION  
**PAVEMENT JOINT DETAILS**  
 FAP 310 (IL 255)  
 SECTIONS 60-15-1, 60-15HB-1  
 MADISON COUNTY

DRAWN BY SEB  
 CHECKED BY

DATE SEPT 2001

p:\00files\00224\dhumbert\detail\misc\pjdet015b-rampad.dgn