

F.A.P. RTE.	SECTION	COUNTY	TOTAL SHEETS	SHEET NO.
310	60-15-1, 60-15HB-1	MADISON	238	96
STA.		TO STA.		
FED. ROAD DIST. NO.		ILLINOIS FED. AID PROJECT		
CONTRACT NO. 76635				

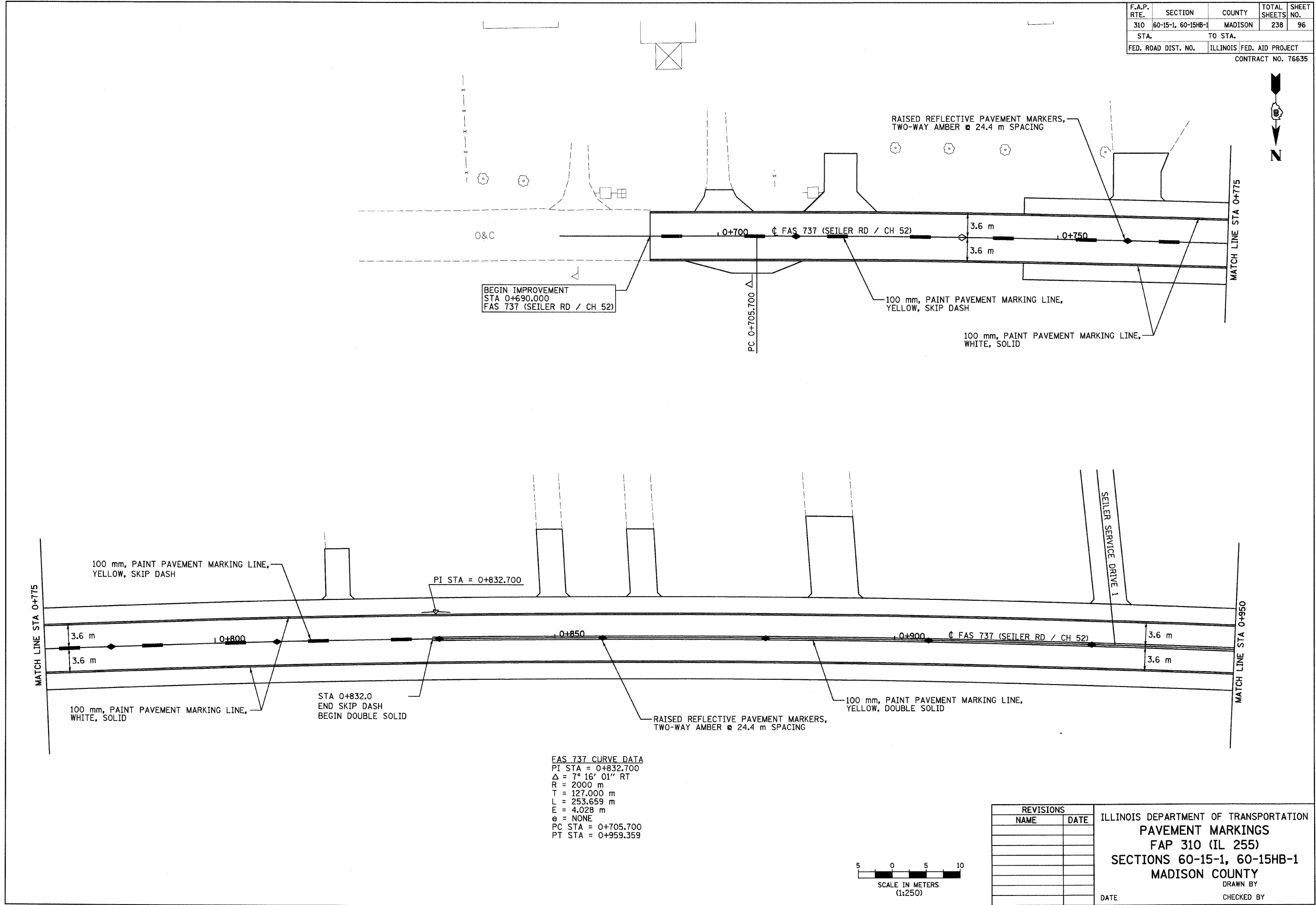

BEGIN IMPROVEMENT
STA 0+690.000
FAS 737 (SEILER RD / CH 52)

PI STA = 0+832.700

FAS 737 CURVE DATA
PI STA = 0+832.700
 $\Delta = 7^\circ 16' 01''$ RT
R = 2000 m
T = 127.000 m
L = 253.659 m
E = 4.028 m
e = NONE
PC STA = 0+705.700
PT STA = 0+959.359

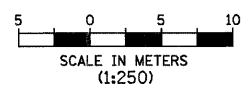

REVISIONS	
NAME	DATE

ILLINOIS DEPARTMENT OF TRANSPORTATION
PAVEMENT MARKINGS
FAP 310 (IL 255)
SECTIONS 60-15-1, 60-15HB-1
MADISON COUNTY
DRAWN BY
CHECKED BY
DATE

SEILER ROAD STA 0+705 TO STA 0+775

pt:\02f\les\00224\dhumber-t\pvm\mark-ks\pvm\015bse1101.dgn