

F.A.P. RTE.	SECTION	COUNTY	TOTAL SHEETS	SHEET NO.
310	60-15-1, 60-15HB-1	MADISON	238	110
STA.		TO STA.		
FED. ROAD DIST. NO.		ILLINOIS	FED. AID PROJECT	CONTRACT NO. 76635

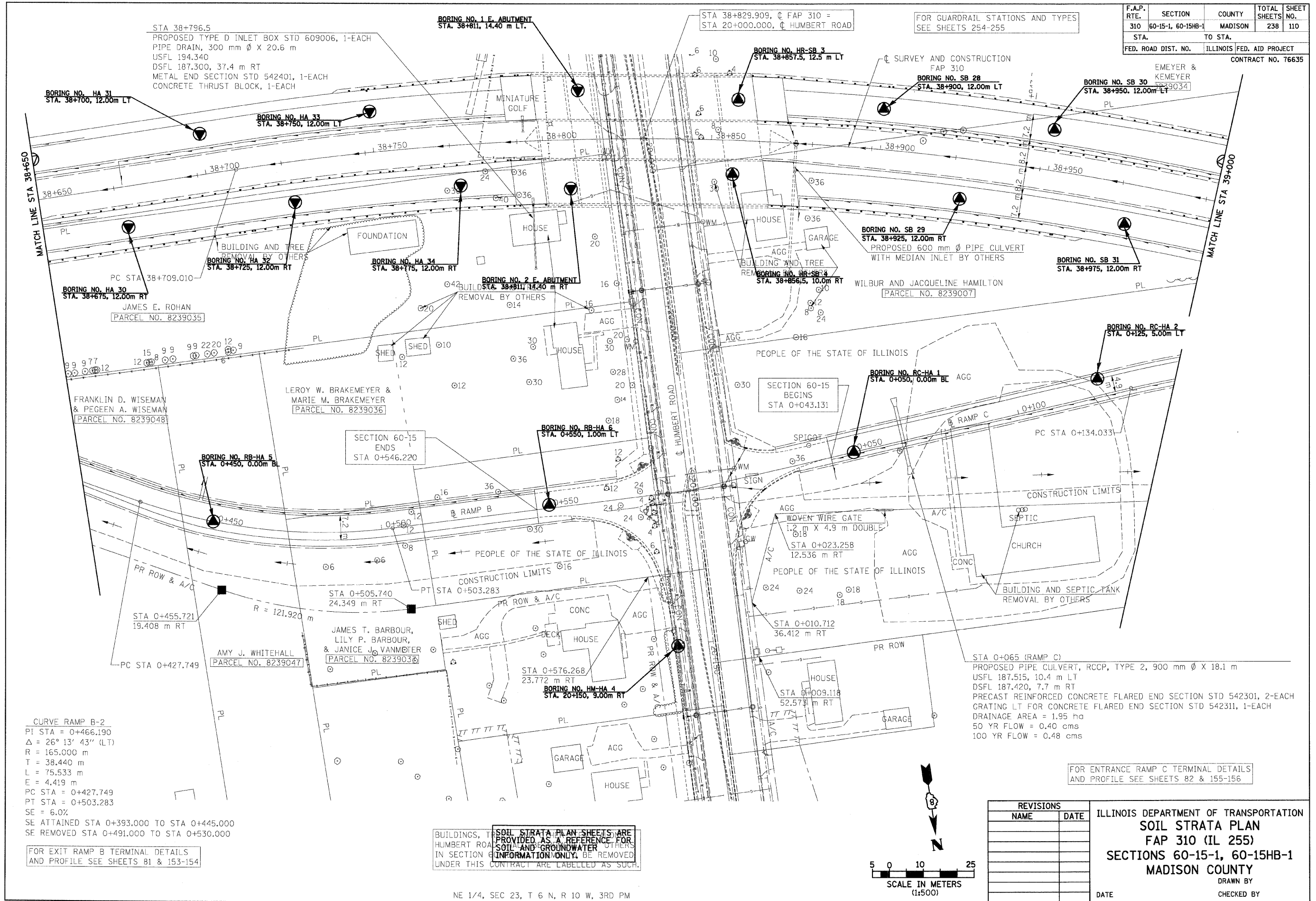

STA 38+796.5
 PROPOSED TYPE D INLET BOX STD 609006, 1-EACH
 PIPE DRAIN, 300 mm Ø X 20.6 m
 USFL 194.340
 DSFL 187.300, 37.4 m RT
 METAL END SECTION STD 542401, 1-EACH
 CONCRETE THRUST BLOCK, 1-EACH

STA 38+829.909, C FAP 310 =
 STA 20+000.000, C HUMBERT ROAD

FOR GUARDRAIL STATIONS AND TYPES
 SEE SHEETS 254-255

BORING NO. HA 31
 STA. 38+700, 12.00m LT

BORING NO. HA 33
 STA. 38+750, 12.00m LT

BORING NO. HR-SB 3
 STA. 38+857.5, 12.5 m LT

BORING NO. SB 28
 STA. 38+900, 12.00m LT

BORING NO. SB 30
 STA. 38+950, 12.00m LT

BORING NO. HA 30
 STA. 38+675, 12.00m RT
 JAMES E. ROHAN
 PARCEL NO. 8239035

BORING NO. HA 32
 STA. 38+725, 12.00m RT

BORING NO. HA 34
 STA. 38+775, 12.00m RT

BORING NO. 2 E. ABUTMENT
 STA. 38+811, 14.40 m RT

BORING NO. HR-SB 4
 STA. 38+856.5, 10.0m RT

BORING NO. SB 29
 STA. 38+925, 12.00m RT
 PROPOSED 600 mm Ø PIPE CULVERT
 WITH MEDIAN INLET BY OTHERS

BORING NO. SB 31
 STA. 38+975, 12.00m RT

FRANKLIN D. WISEMAN
 & PEGEEN A. WISEMAN
 PARCEL NO. 8239048

LEROY W. BRAKEMEYER &
 MARIE M. BRAKEMEYER
 PARCEL NO. 8239036

SECTION 60-15
 ENDS
 STA 0+546.220

BORING NO. RB-HA 6
 STA. 0+550, 1.00m LT

BORING NO. RC-HA 1
 STA. 0+050, 0.00m BL

BORING NO. RC-HA 2
 STA. 0+125, 5.00m LT

BORING NO. RB-HA 5
 STA. 0+450, 0.00m BL

STA 0+455.721
 19.408 m RT

AMY J. WHITEHALL
 PARCEL NO. 8239047

JAMES T. BARBOUR,
 LILY P. BARBOUR,
 & JANICE J. VANMETER
 PARCEL NO. 8239036

STA 0+576.268
 23.772 m RT

BORING NO. HM-HA 4
 STA. 20+150, 9.00m RT

STA 0+009.118
 52.573 m RT

STA 0+065 (RAMP C)
 PROPOSED PIPE CULVERT, RCCP, TYPE 2, 900 mm Ø X 18.1 m
 USFL 187.515, 10.4 m LT
 DSFL 187.420, 7.7 m RT
 PRECAST REINFORCED CONCRETE FLARED END SECTION STD 542301, 2-EACH
 GRATING LT FOR CONCRETE FLARED END SECTION STD 542311, 1-EACH
 DRAINAGE AREA = 1.95 ha
 50 YR FLOW = 0.40 cms
 100 YR FLOW = 0.48 cms

FOR ENTRANCE RAMP C TERMINAL DETAILS
 AND PROFILE SEE SHEETS 82 & 155-156

CURVE RAMP B-2
 PI STA = 0+466.190
 $\Delta = 26^\circ 13' 43''$ (LT)
 R = 165.000 m
 T = 38.440 m
 L = 75.533 m
 E = 4.419 m
 PC STA = 0+427.749
 PT STA = 0+503.283
 SE = 6.0%
 SE ATTAINED STA 0+393.000 TO STA 0+445.000
 SE REMOVED STA 0+491.000 TO STA 0+530.000

FOR EXIT RAMP B TERMINAL DETAILS
 AND PROFILE SEE SHEETS 81 & 153-154

BUILDINGS, TRAILS, AND OTHERS
 HUMBERT ROAD AND OTHERS
 IN SECTION 60-15 TO BE REMOVED
 UNDER THIS CONTRACT ARE LABELLED AS SUCH.

NE 1/4, SEC 23, T 6 N, R 10 W, 3RD PM

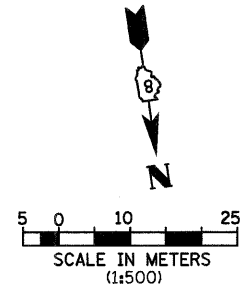

REVISIONS	
NAME	DATE

ILLINOIS DEPARTMENT OF TRANSPORTATION
 SOIL STRATA PLAN
 FAP 310 (IL 255)
 SECTIONS 60-15-1, 60-15HB-1
 MADISON COUNTY
 DRAWN BY
 CHECKED BY
 DATE
 IL 255 (FAP 310), STA 38+650 TO STA 39+000

p:\02\files\000224\dhumbert\soilstrata\ssplan015a11.dgn