

F.A.P. RTE.	SECTION	COUNTY	TOTAL SHEETS	SHEET NO.
310	60-15-1, 60-15HB-1	MADISON	238	117
STA. 20+000 TO STA. 20+175		FED. ROAD DIST. NO. ILLINOIS FED. AID PROJECT		
CONTRACT NO. 76635				

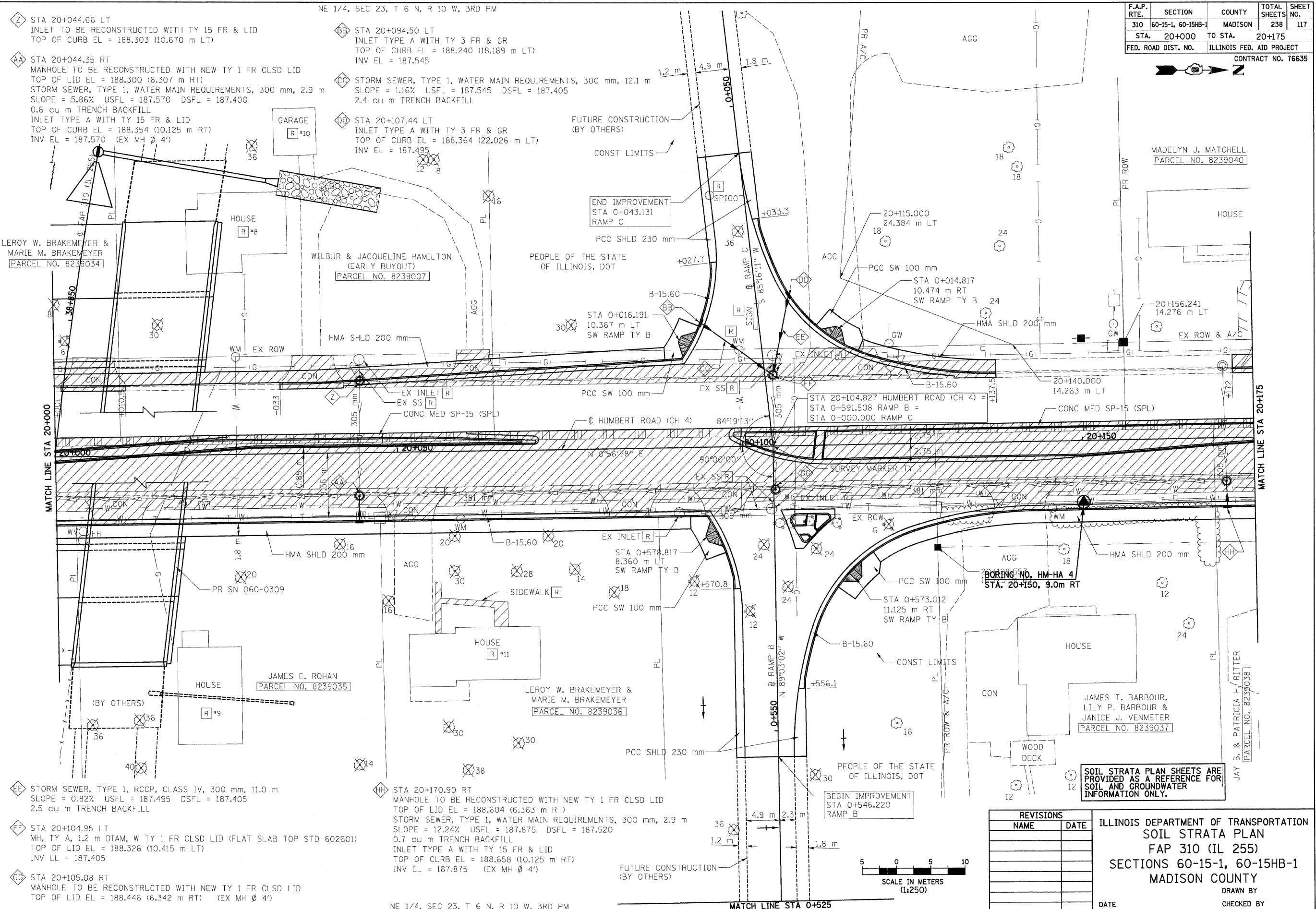

- ◆ Z STA 20+044.66 LT
INLET TO BE RECONSTRUCTED WITH TY 15 FR & LID
TOP OF CURB EL = 188.303 (10.670 m LT)
- ◆ AA STA 20+044.35 RT
MANHOLE TO BE RECONSTRUCTED WITH NEW TY 1 FR CLSD LID
TOP OF LID EL = 188.300 (6.307 m RT)
STORM SEWER, TYPE 1, WATER MAIN REQUIREMENTS, 300 mm, 2.9 m
SLOPE = 5.86% USFL = 187.570 DSFL = 187.400
0.6 cu m TRENCH BACKFILL
INLET TYPE A WITH TY 15 FR & LID
TOP OF CURB EL = 188.354 (10.125 m RT)
INV EL = 187.570 (EX MH Ø 4')
- ◆ BB STA 20+094.50 LT
INLET TYPE A WITH TY 3 FR & GR
TOP OF CURB EL = 188.240 (18.189 m LT)
INV EL = 187.545
- ◆ CC STORM SEWER, TYPE 1, WATER MAIN REQUIREMENTS, 300 mm, 12.1 m
SLOPE = 1.16% USFL = 187.545 DSFL = 187.405
2.4 cu m TRENCH BACKFILL
- ◆ DD STA 20+107.44 LT
INLET TYPE A WITH TY 3 FR & GR
TOP OF CURB EL = 188.364 (22.026 m LT)
INV EL = 187.495
- ◆ EE STORM SEWER, TYPE 1, RCCP, CLASS IV, 300 mm, 11.0 m
SLOPE = 0.82% USFL = 187.495 DSFL = 187.405
2.5 cu m TRENCH BACKFILL
- ◆ FF STA 20+104.95 LT
MH, TY A, 1.2 m DIAM, W TY 1 FR CLSD LID (FLAT SLAB TOP STD 602601)
TOP OF LID EL = 188.326 (10.415 m LT)
INV EL = 187.405
- ◆ GG STA 20+105.08 RT
MANHOLE TO BE RECONSTRUCTED WITH NEW TY 1 FR CLSD LID
TOP OF LID EL = 188.446 (6.342 m RT) (EX MH Ø 4')
- ◆ HH STA 20+170.90 RT
MANHOLE TO BE RECONSTRUCTED WITH NEW TY 1 FR CLSD LID
TOP OF LID EL = 188.604 (6.363 m RT)
STORM SEWER, TYPE 1, WATER MAIN REQUIREMENTS, 300 mm, 2.9 m
SLOPE = 12.24% USFL = 187.875 DSFL = 187.520
0.7 cu m TRENCH BACKFILL
INLET TYPE A WITH TY 15 FR & LID
TOP OF CURB EL = 188.658 (10.125 m RT)
INV EL = 187.875 (EX MH Ø 4')

REVISIONS	
NAME	DATE

ILLINOIS DEPARTMENT OF TRANSPORTATION
 SOIL STRATA PLAN
 FAP 310 (IL 255)
 SECTIONS 60-15-1, 60-15HB-1
 MADISON COUNTY
 DRAWN BY
 CHECKED BY
 DATE

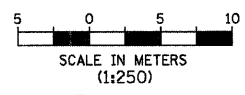

p:\02f\les\0024\dhumbert\soil\strata\asplan015b04.dgn