

F.P. R.T.E.	SECTION	COUNTY	TOTAL SHEETS	SHEET NO.
331	3-2, 8X-1, 4-2	SALINE	220	31
STA.		TO STA.		
FED. ROAD DIST. NO.		ILLINOIS	FED. AID PROJECT	

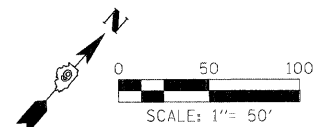

CHECKED BY: BJW
 PLOT DATE: 2/2/2009
 DRAWN BY: DMS
 PLOT SCALE: 1/4" = 50'

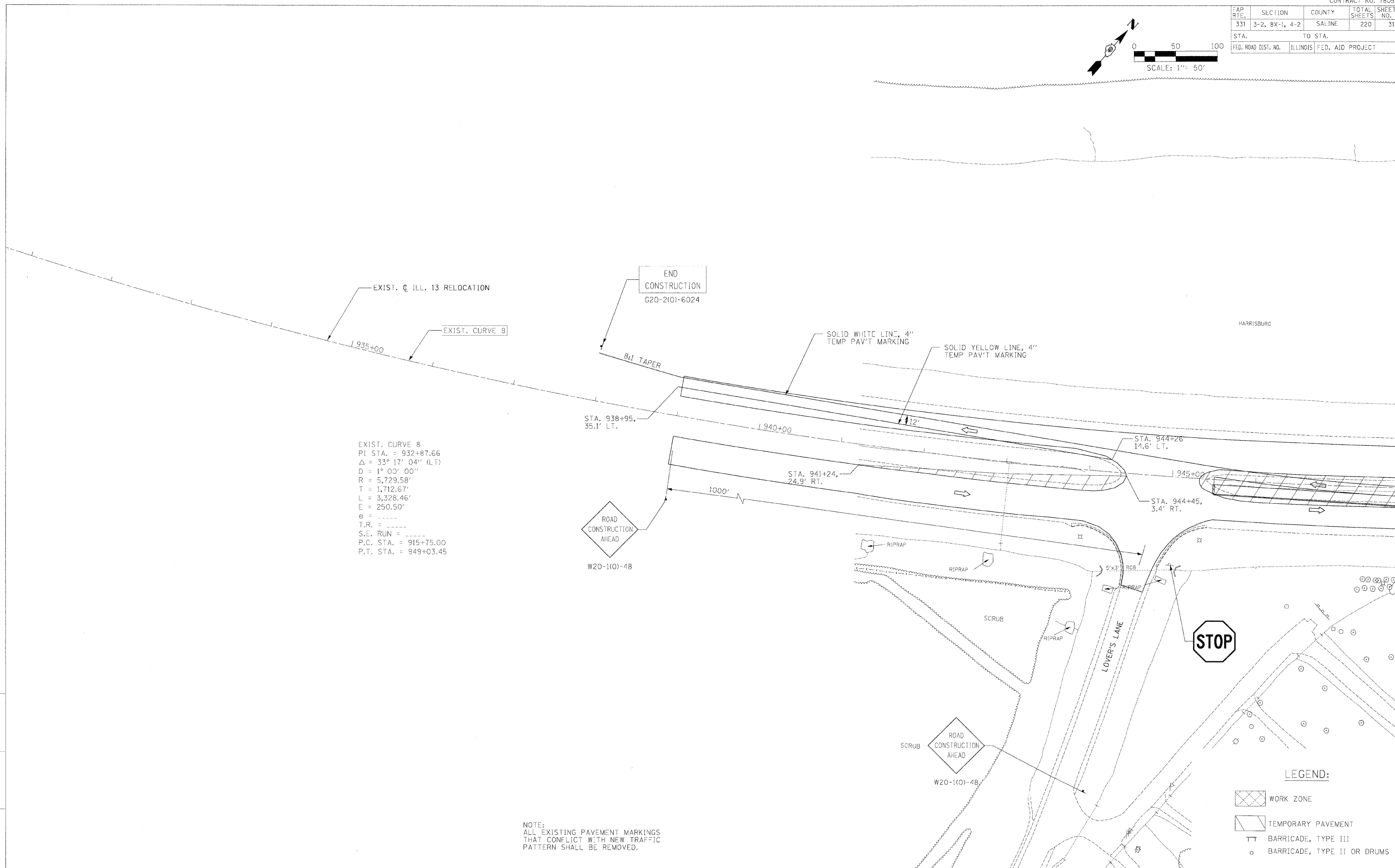

EXIST. CURVE 8
 P.I. STA. = 932+87.66
 $\Delta = 33^\circ 17' 04''$ (LT)
 $D = 1^\circ 00' 00''$
 $R = 5,729.58'$
 $T = 1,712.67'$
 $L = 3,328.46'$
 $E = 250.50'$
 $e =$
 $T.R. =$
 $S.E. RUN =$
 $P.C. STA. = 915+75.00$
 $P.T. STA. = 949+03.45$

NOTE:
 ALL EXISTING PAVEMENT MARKINGS
 THAT CONFLICT WITH NEW TRAFFIC
 PATTERN SHALL BE REMOVED.

LEGEND:

	WORK ZONE
	TEMPORARY PAVEMENT
	BARRICADE, TYPE III
	BARRICADE, TYPE II OR DRUMS