

F.A. RTE.	SECTION	COUNTY	TOTAL SHEETS	SHEET NO.
331	*	SALINE	220	88

STA.	TO S.I.A.
FED. ROAD DIST. NO.	ILLINOIS FED. AID PROJECT

• 3-2, (8X-11B, 4-2

HARRISBURG

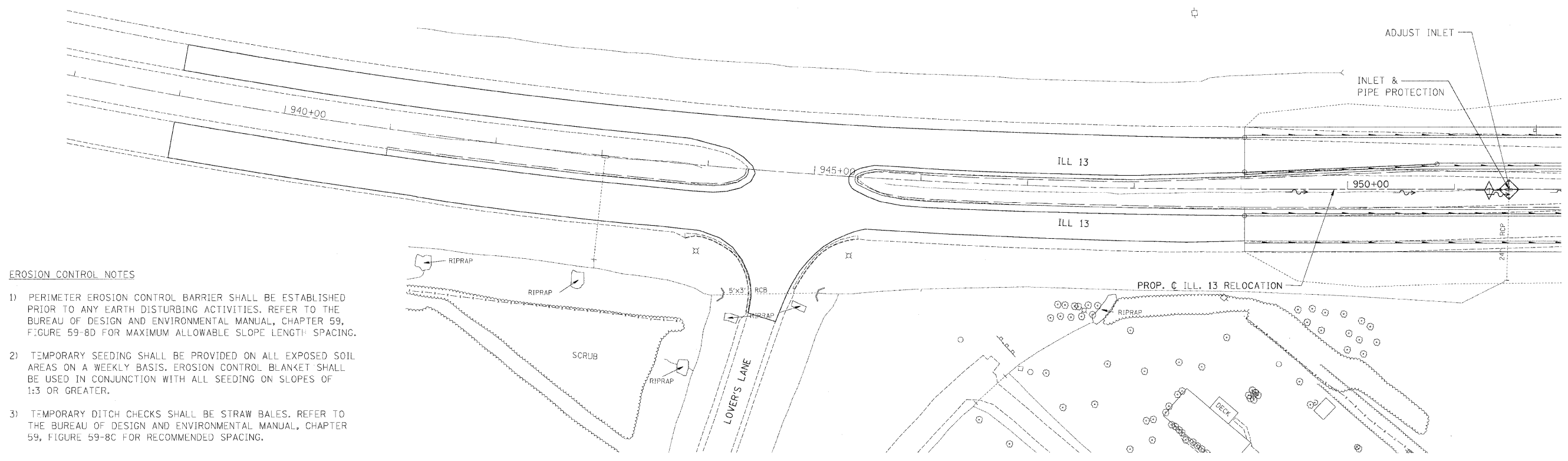

EROSION CONTROL NOTES

- 1) PERIMETER EROSION CONTROL BARRIER SHALL BE ESTABLISHED PRIOR TO ANY EARTH DISTURBING ACTIVITIES. REFER TO THE BUREAU OF DESIGN AND ENVIRONMENTAL MANUAL, CHAPTER 59, FIGURE 59-8D FOR MAXIMUM ALLOWABLE SLOPE LENGTH SPACING.
- 2) TEMPORARY SEEDING SHALL BE PROVIDED ON ALL EXPOSED SOIL AREAS ON A WEEKLY BASIS. EROSION CONTROL BLANKET SHALL BE USED IN CONJUNCTION WITH ALL SEEDING ON SLOPES OF 1:3 OR GREATER.
- 3) TEMPORARY DITCH CHECKS SHALL BE STRAW BALES. REFER TO THE BUREAU OF DESIGN AND ENVIRONMENTAL MANUAL, CHAPTER 59, FIGURE 59-8C FOR RECOMMENDED SPACING.

CHECKED BY: B.W. PLOT DATE: 2/27/2009
 DRAWN BY: DMS PLOT SCALE: 1:50

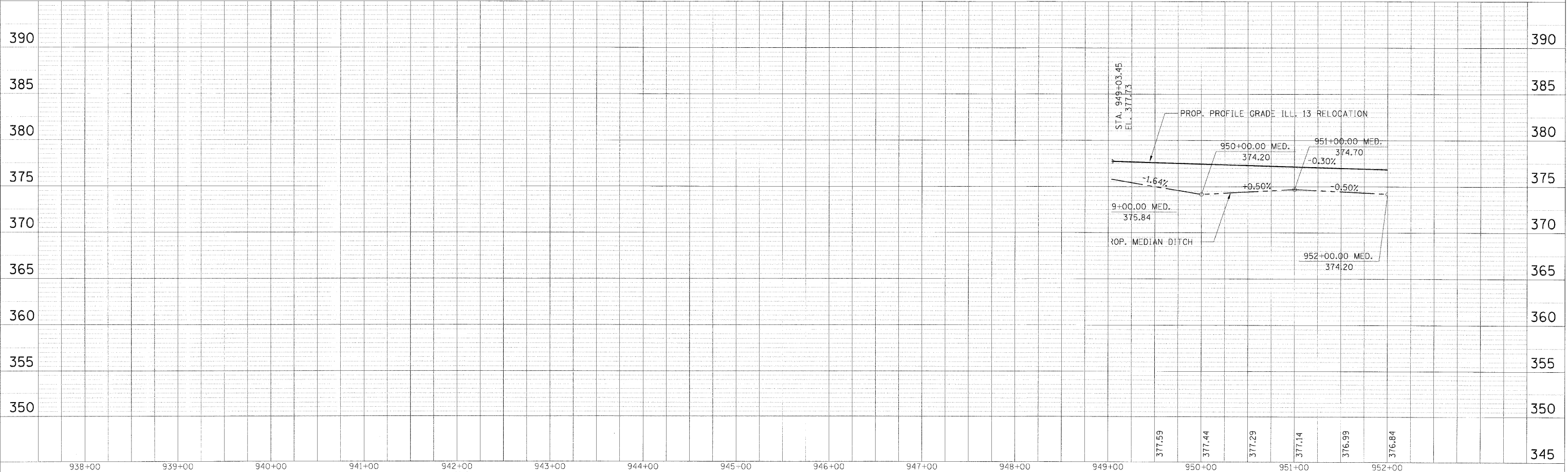

TEMPORARY EROSION CONTROL PLAN - STA. 949 + 03.45 TO STA. 952 + 00.00

M:\PROJECTS\PROJECTS\ROADWAY\COMMON\Reference Files
 Active File: eb3505.dwg