

ROUTE NO.	SECTION	COUNTY	TOTAL SHEETS	SHEET NO.
CH 2006-00275-00-PV		LOGSALLE	218	101
STA. 6+00		TO STA. 9+50		
FED. ROAD DIST. NO. 3		ILLINOIS	FED. AID PROJECT	
CONTRACT NO. 87352				

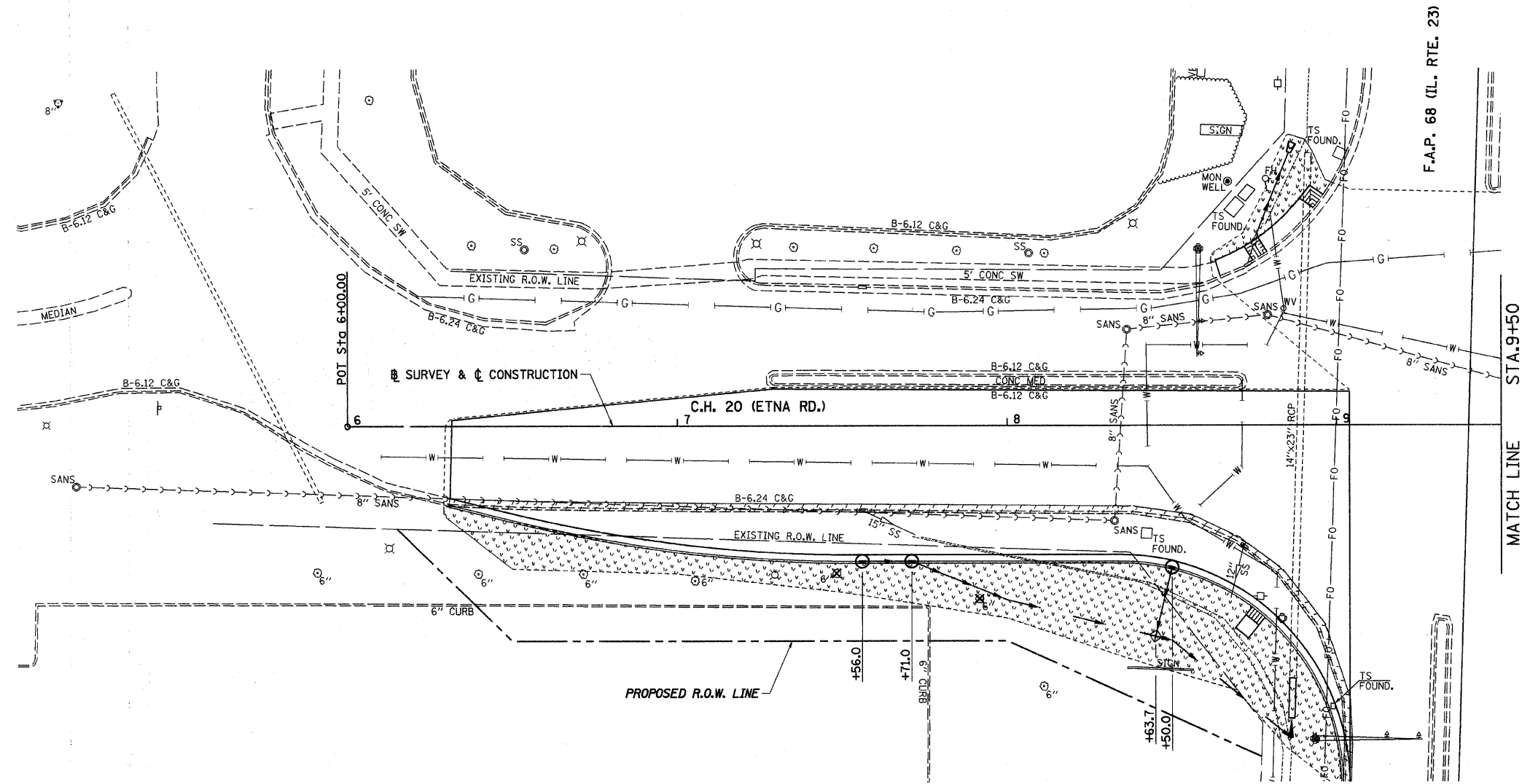

TEMPORARY EROSION CONTROL LEGEND

- ⊕ INLET AND PIPE PROTECTION
- ⊕ TEMPORARY DITCH CHECKS
- FILTER FABRIC - INLET PROTECTION
- PERIMETER EROSION BARRIER
- ▨ EROSION CONTROL BLANKET
- ▨ MULCH

NOTE:
TEMPORARY EROSION CONTROL SEEDING
OF THE ENTIRE DISTURBED AREA AS
DIRECTED BY THE ENGINEER.

