

Stage IV Removal
 Remove North Leg of wye
 Remove North half of culvert Sta 7+00
 Remove Temporary Pavement LT Sta 7+00 to LT Sta 11+91
 Remove Temporary Pavement LT Sta 12+18 to LT Sta 12+91
 Remove portion of patch used as Temporary Pavement LT Sta 11+91 to 12+18

Stage IV Construction
 Construct IL 116 WB Sta 8+00 to 11+91

Stage IV Traffic Control
 Traffic Control and Protection (Special)
 Traffic shifts south to Temp Pavement and proposed Eastbound Lane
 Type III Pavement marking tape Sta 6+25 to 13+41
 Type III Pavement marking tape Sta 289+54 to 292+57

W1-4L(O)-48

W13-1(O)-2424

500' from start of taper on east end

ROAD CONSTRUCTION AHEAD

W20-1(O)-48

1000' minimum, 1500' maximum from start of taper on east end

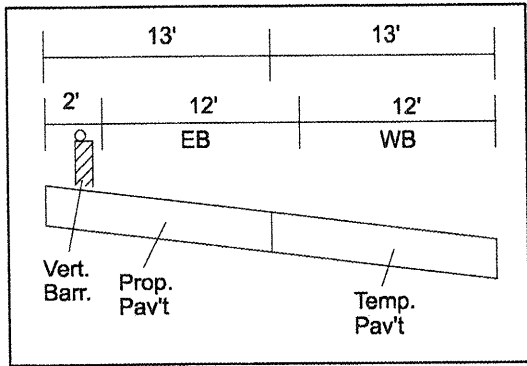
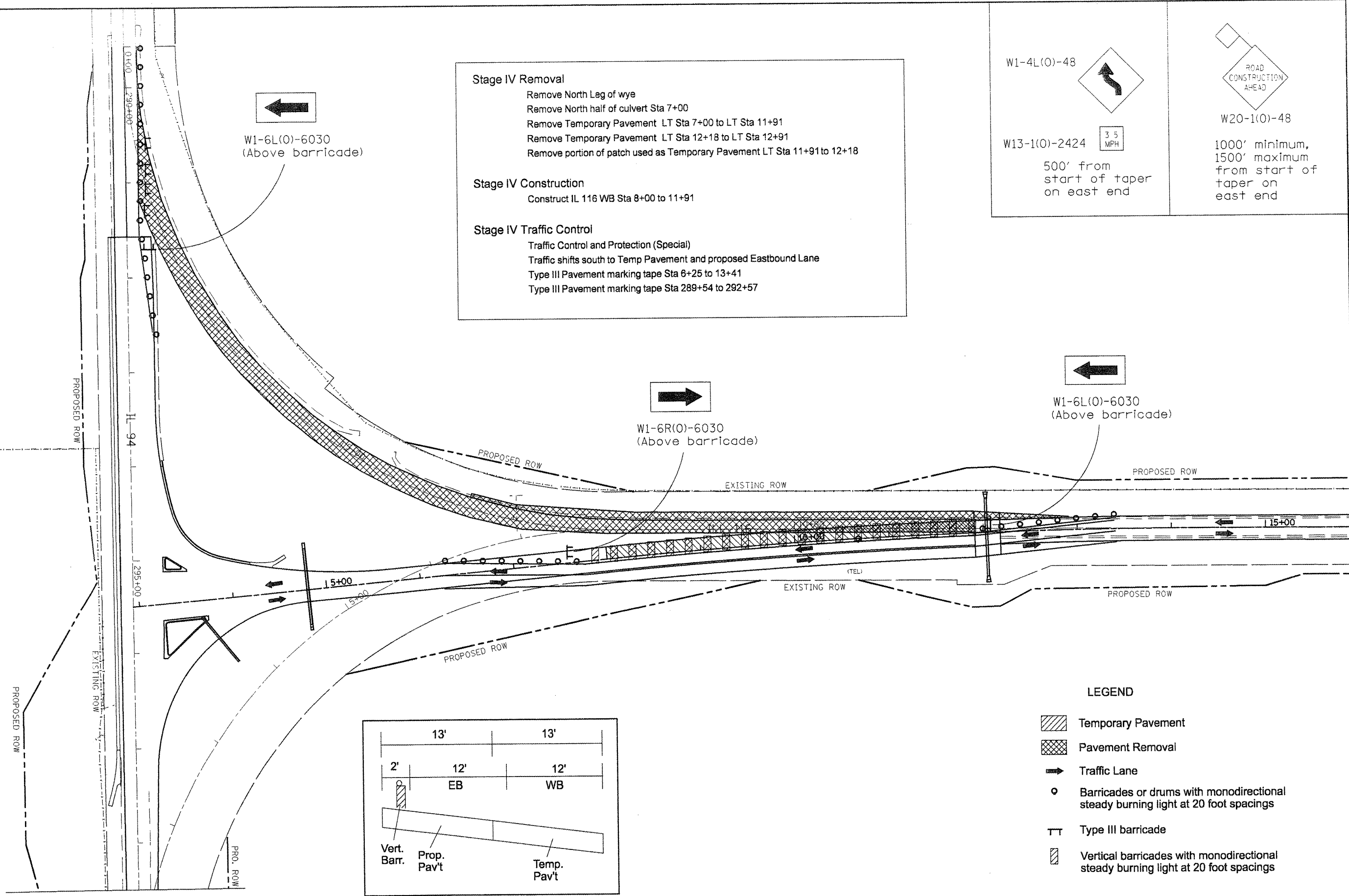

- LEGEND**
- Temporary Pavement
 - Pavement Removal
 - Traffic Lane
 - Barricades or drums with monodirectional steady burning light at 20 foot spacings
 - Type III barricade
 - Vertical barricades with monodirectional steady burning light at 20 foot spacings

FILE NAME = staging.dgn	USER NAME = hude1sonme	DESIGNED -	REVISED -
		DRAWN -	REVISED -
		CHECKED -	REVISED -
		DATE -	REVISED -

**STATE OF ILLINOIS
 DEPARTMENT OF TRANSPORTATION**

SUGGESTED STAGES OF CONSTRUCTION - STAGE IV			
SCALE:	SHEET NO. OF SHEETS	STA. TO STA.	

F.A.P. RTE. 665	SECTION	COUNTY HENDERSON	TOTAL SHEETS 83	SHEET NO. 83
CONTRACT NO. 88773			ILLINOIS FED. AID PROJECT	

• (136,137)W&RS-3136R109BR-2