

DATE	
BY	
PLANNING	
DESIGNED	
DRAWN	
CHECKED	
DATE	

DATE	
BY	
PROFILE	
DESIGNED	
DRAWN	
CHECKED	
DATE	

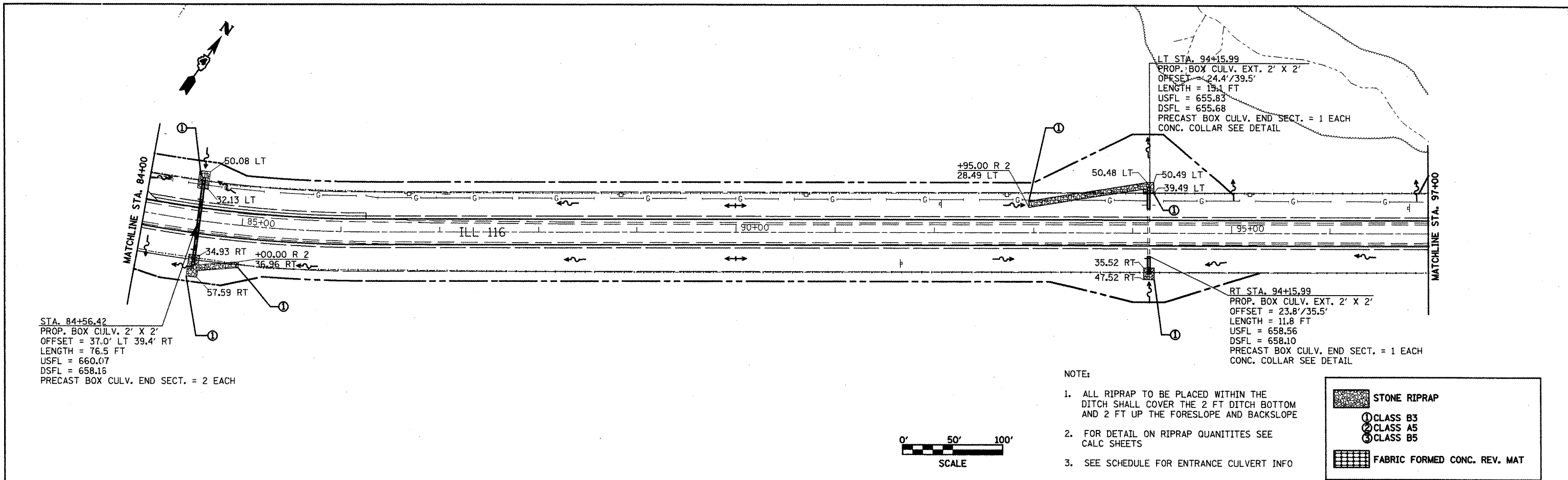

STA. 84+56.42  
 PROP. BOX CULV. 2' X 2'  
 OFFSET = 37.0' LT 39.4' RT  
 LENGTH = 76.5 FT  
 USFL = 660.07  
 DSFL = 658.16  
 PRECAST BOX CULV. END SECT. = 2 EACH

LT STA. 94+15.99  
 PROP. BOX CULV. EXT. 2' X 2'  
 OFFSET = 24.4' / 39.5'  
 LENGTH = 15.1 FT  
 USFL = 655.83  
 DSFL = 655.68  
 PRECAST BOX CULV. END SECT. = 1 EACH  
 CONC. COLLAR SEE DETAIL

RT STA. 94+15.99  
 PROP. BOX CULV. EXT. 2' X 2'  
 OFFSET = 23.8' / 35.5'  
 LENGTH = 11.8 FT  
 USFL = 658.56  
 DSFL = 658.10  
 PRECAST BOX CULV. END SECT. = 1 EACH  
 CONC. COLLAR SEE DETAIL

- NOTE:
- ALL RIPRAP TO BE PLACED WITHIN THE DITCH SHALL COVER THE 2 FT DITCH BOTTOM AND 2 FT UP THE FORESLOPE AND BACKSLOPE
  - FOR DETAIL ON RIPRAP QUANTITIES SEE CALC SHEETS
  - SEE SCHEDULE FOR ENTRANCE CULVERT INFO

**STONE RIPRAP**

- ① CLASS B3
- ② CLASS A5
- ③ CLASS B5

**FABRIC FORMED CONC. REV. MAT**

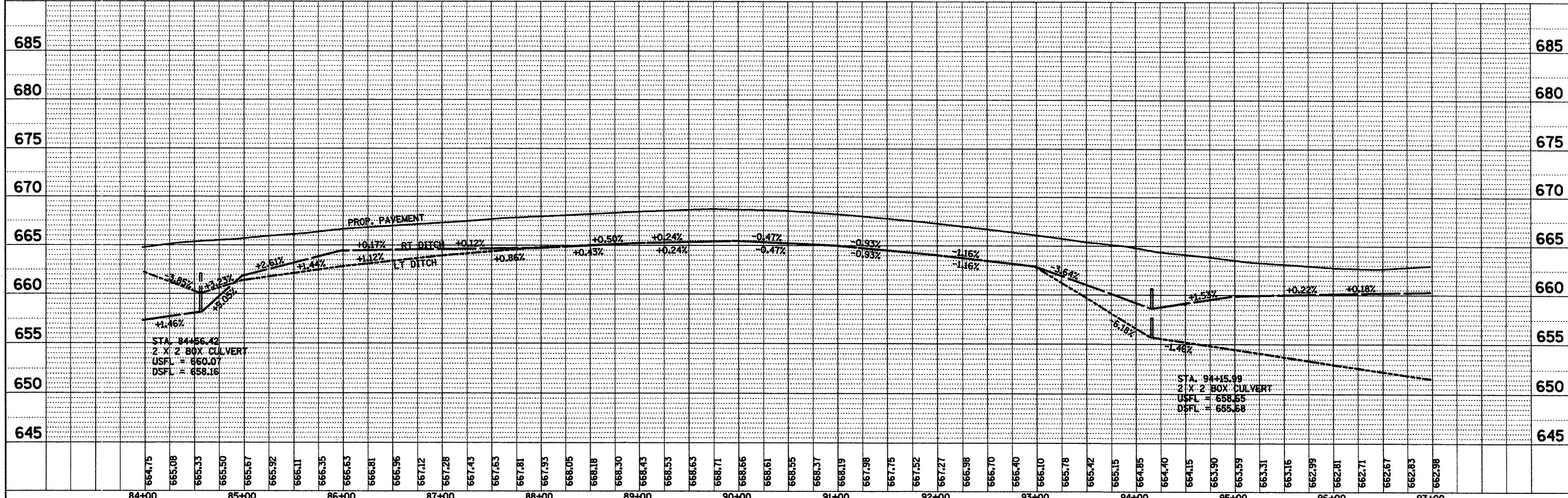
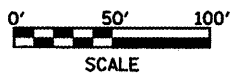

FILE NAME = d:\detail.dgn	USER NAME = ghadineam	DESIGNED -	REVISED -	<b>STATE OF ILLINOIS DEPARTMENT OF TRANSPORTATION</b>	<b>PROPOSED DRAINAGE IL 116 STA. 84+00 TO STA. 97+00</b>			F.A.P. RTE. 665	SECTION (136,137) WARS-3136R109BR-1	COUNTY HENDERSON	TOTAL SHEETS 115	SHEET NO. 115			
		DRAWN -	REVISED -					SCALE: SHEET NO. OF SHEETS STA. TO STA.			CONTRACT NO. 88773				
		CHECKED -	REVISED -					FED. ROAD DIST. NO. (ILLINOIS) FED. AID PROJECT							
		DATE = 2/27/2009	REVISED -												