

DATE	
BY	
REVIEWED	
ALIGNMENT CHECKED	
RT. OF WAY CHECKED	
NOTE BOOK NO.	
FILE NAME	

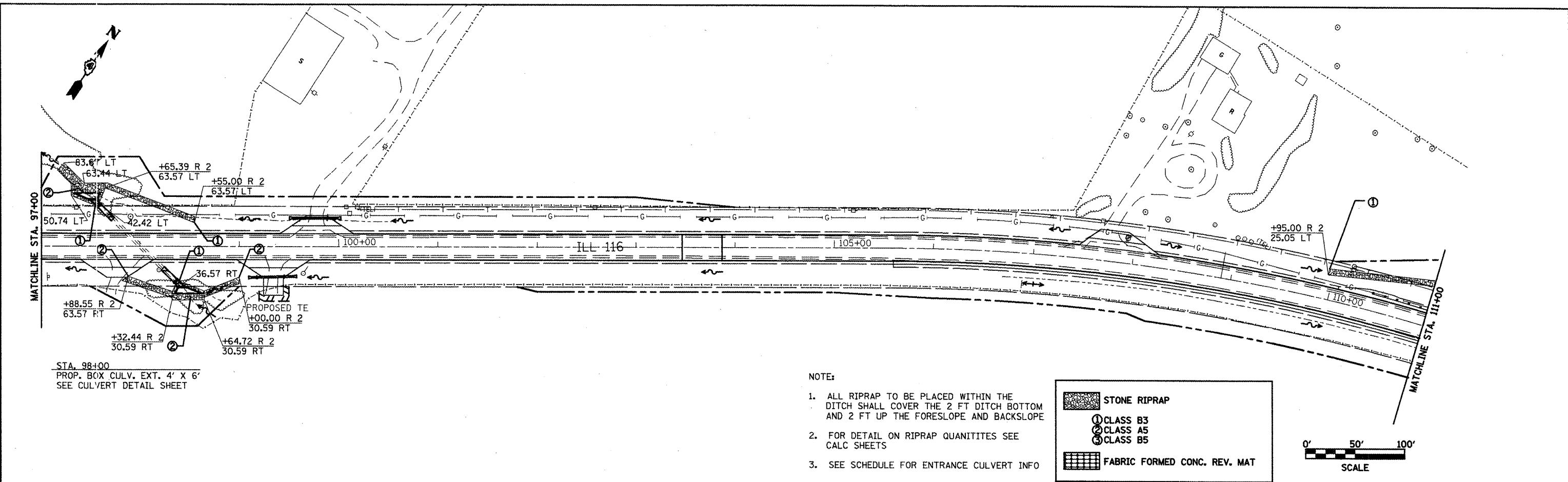

- NOTE:
- ALL RIPRAP TO BE PLACED WITHIN THE DITCH SHALL COVER THE 2 FT DITCH BOTTOM AND 2 FT UP THE FORESLOPE AND BACKSLOPE
 - FOR DETAIL ON RIPRAP QUANTITIES SEE CALC SHEETS
 - SEE SCHEDULE FOR ENTRANCE CULVERT INFO

STONE RIPRAP

- ① CLASS B3
- ② CLASS A5
- ③ CLASS B5

FABRIC FORMED CONC. REV. MAT

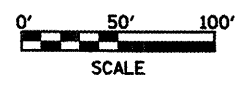

DATE	
BY	
REVIEWED	
PROFILE PLOTTED	
CHECKED	
NOTE BOOK NO.	
STRUCTURE NOTATIONS CHD	

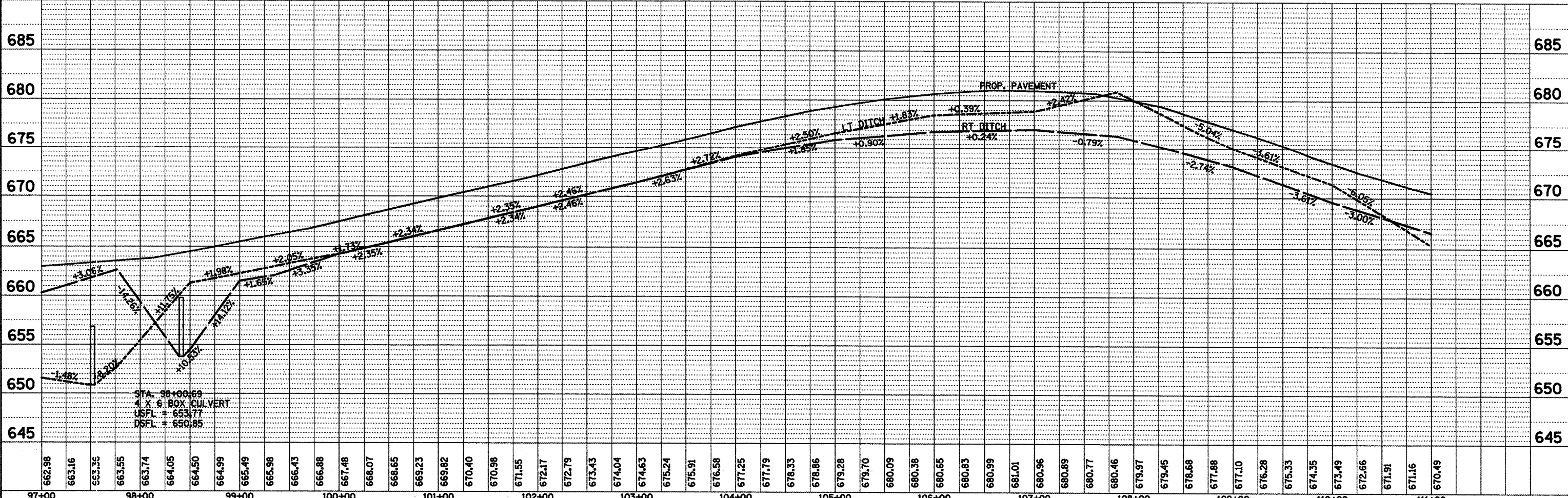

FILE NAME = dr-andetail.dgn	USER NAME = ghdnsam	DESIGNED -	REVISED -	STATE OF ILLINOIS DEPARTMENT OF TRANSPORTATION	PROPOSED DRAINAGE IL 116 STA. 97+00 TO STA. 111+00	F.A.P. RTE. 665	SECTION 036J1371WARS-3136R109BR-1	COUNTY HENDERSON	TOTAL SHEETS 110	SHEET NO. 110	
	PLOT SCALE = 100.0000 / IN.	DRAWN -	REVISED -			SCALE:	SHEET NO. OF SHEETS STA. TO STA.	CONTRACT NO. 88773			
	PLOT DATE = 2/27/2009	CHECKED -	REVISED -			FED. ROAD DIST. NO. ILLINOIS FED. AID PROJECT					
		DATE -	REVISED -								