

- Q1 x = 6'-6"
- Q2 x = 5'-8"
- Q3 x = 4'-11"
- Q4 x = 4'-1"
- Q5 x = 3'-4"
- Q6 x = 2'-6"
- Q7 x = 1'-9"

*6 @ 8" cts. 2 bars of each length req.

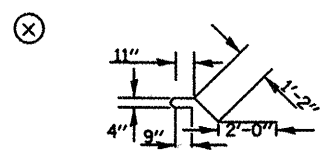

*4 @ 12" cts. 35 bars req.

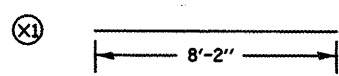

*4 @ 4" cts. 12 bars req.

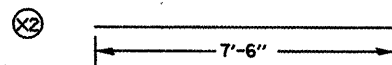

*4 @ 4" cts. 12 bars req.

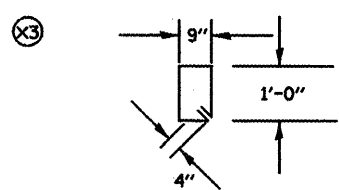

*4 @ 12" cts. 12 bars req.

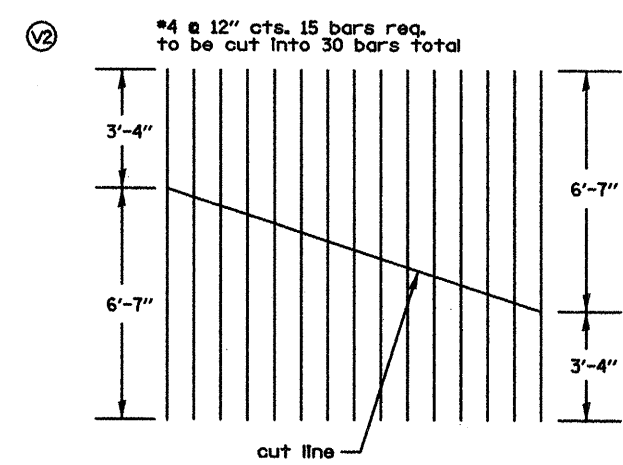
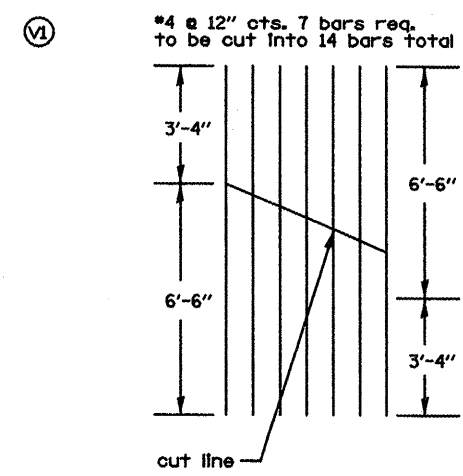
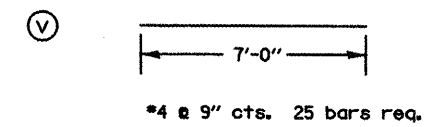
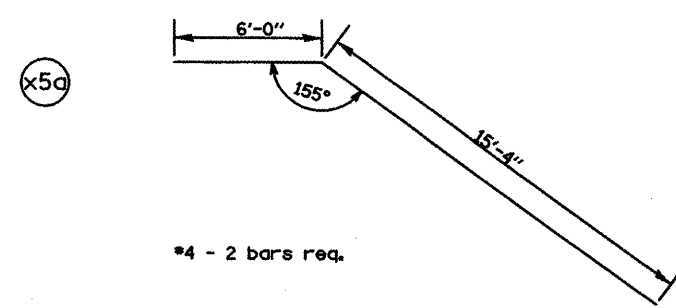
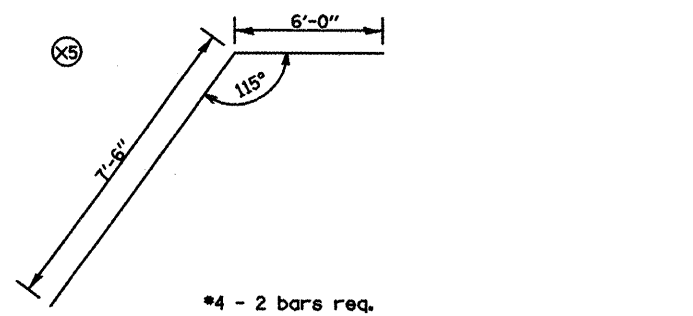
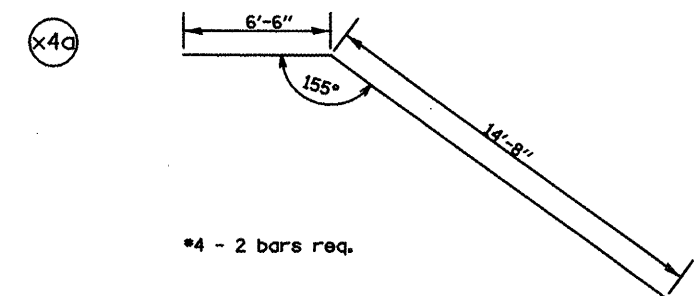
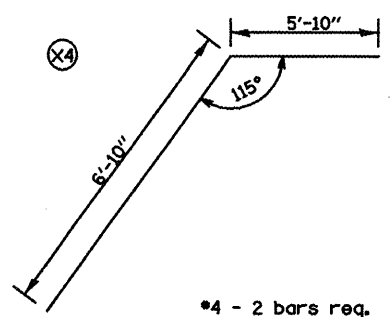

DRAWING NOT TO SCALE

FILE NAME = d-a1ndetail.dgn	USER NAME = ghdvnaem	DESIGNED -	REVISED -	STATE OF ILLINOIS DEPARTMENT OF TRANSPORTATION	STA. 155+19 6' X 6' BOX CULVERT EXTENSION DETAIL			F.A.P. RTE.	SECTION	COUNTY	TOTAL SHEETS	SHEET NO.		
		DRAWN -	REVISED -		SCALE:	SHEET NO.	OF	SHEETS	STA.	TO STA.	665	(136.137)WARS-3(136R)109BR-1	HENDERSON	143
		CHECKED -	REVISED -										CONTRACT NO. 88773	
		DATE -	REVISED -										FED. ROAD DIST. NO. ILLINOIS FED. AID PROJECT	