

PLAN	REVISIONS	DATE
NO.	BY	
NO.	BY	
NO.	BY	
NO.	BY	
NO.	BY	
NO.	BY	
NO.	BY	
NO.	BY	
NO.	BY	
NO.	BY	

PROFILE	REVISIONS	DATE
NO.	BY	
NO.	BY	
NO.	BY	
NO.	BY	
NO.	BY	
NO.	BY	
NO.	BY	
NO.	BY	
NO.	BY	
NO.	BY	

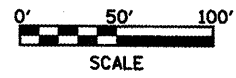

LEGEND	
①	HMA BASE COURSE (6") INCIDENTAL HMA (2")
②	AGGREGATE SURFACE COURSE (8")

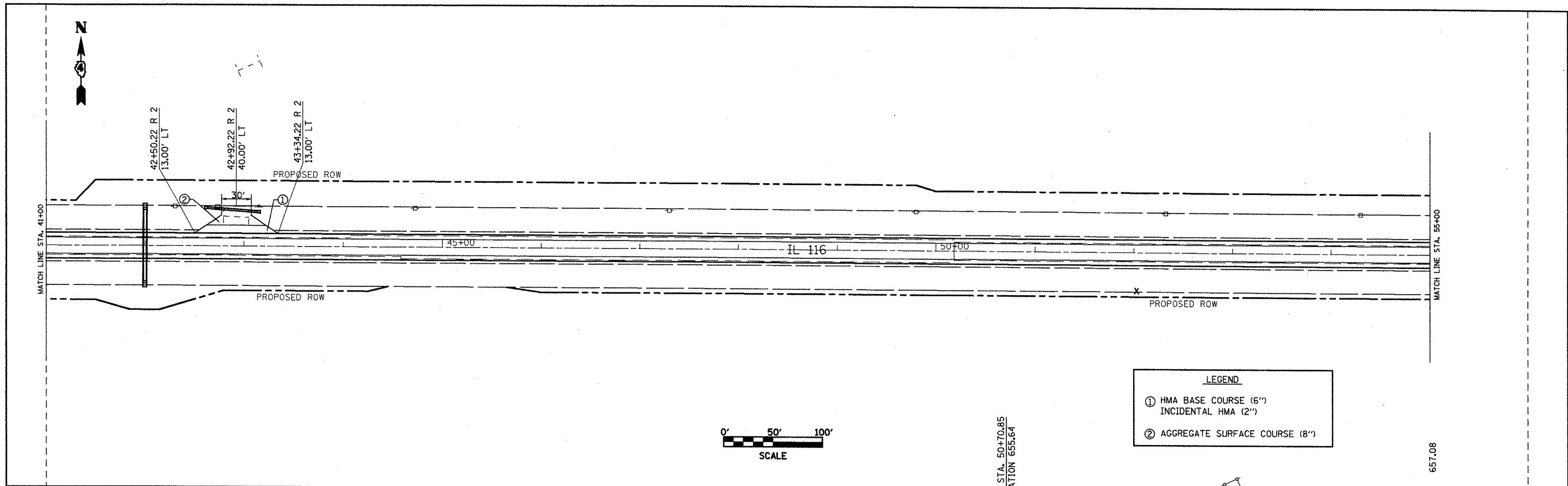
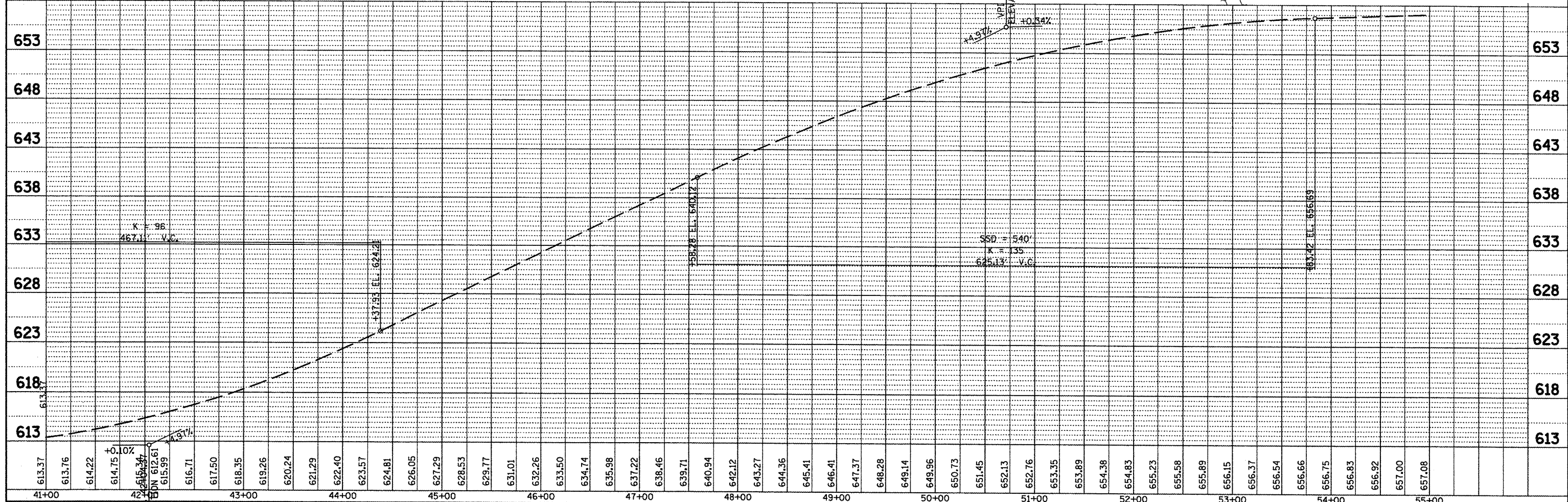

FILE NAME = mscsheets.dgn	USER NAME = ghdsnaen	DESIGNED -	REVISED -	STATE OF ILLINOIS DEPARTMENT OF TRANSPORTATION	PROPOSED PLAN/PROFILE - IL 116		F.A.P. RTE. 665	SECTION (136,137)W&RS-3d336R109BR-2	COUNTY HENDERSON	TOTAL SHEETS 1168	SHEET NO. 1168
PLDT SCALE = 100.0000' / IN.	PLDT DATE = 2/27/2009	DRAWN -	REVISED -		SCALE:	SHEET NO.	OF SHEETS	STA.	TO STA.	CONTRACT NO. 88773	
		CHECKED -	REVISED -		FED. ROAD DIST. NO.		ILLINOIS FED. AID PROJECT				
		DATE -	REVISED -								