

| | | |
|------|----------|------|
| PLAN | SURVEYED | DATE |
| | ALIGNED | BY |
| | NOTED | |
| | FILED | |
| | NO. | |

RADIUS RETURN
HMA BASE COURSE, 6" = 43.1 TONS
INCIDENTAL HMA SURF., 2" = 14.4 TONS
SUB-BASE GRAN. MAT'L, TYP A, 6" = 142.1 SO. YD.

RT. STA. 9+04.76 TO RT. STA. 9+54.63
HMA BASE COURSE WIDENING, 9" = 17.6 SO. YD.

LT. STA. 9+04.47 TO LT. STA. 9+54.63
HMA BASE COURSE WIDENING, 9" = 18.9 SO. YD.

STA. 9+04.76 TO STA. 9+54.63
BITUMINOUS SURFACE TREATMENT CLASS A-1
BITUMINOUS MATERIALS (COVER & SEAL COATS) = 5.3 GALLONS
(SEE ARTICLE 403.02 FOR MATERIAL TYPES)
SEAL COAT AGGREGATE = 1.3 TONS
(USE GRADATION CA16)

| | | |
|---------|----------|------|
| PROFILE | SURVEYED | DATE |
| | PLOTTED | BY |
| | NOTED | |
| | FILED | |
| | NO. | |

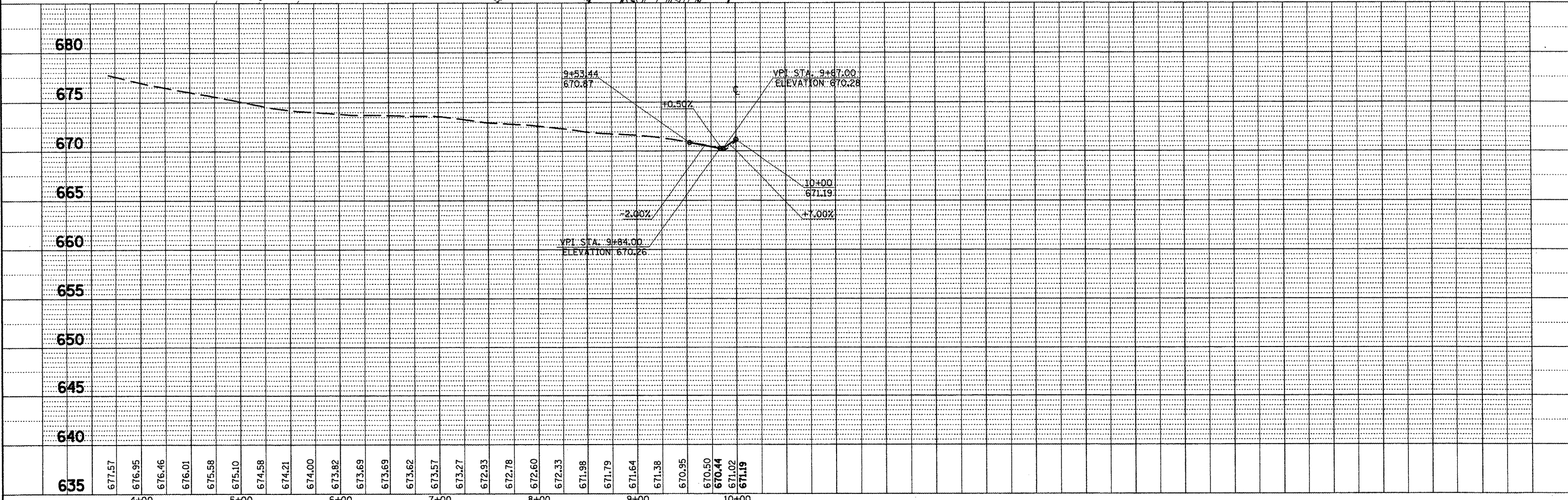

NOTE
THE EDGE OF EXISTING PAVEMENT SHALL BE
CLEANED TO THE SATISFACTION OF THE
ENGINEER BEFORE PLACEMENT OF THE WIDENING.

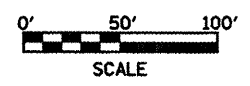

| | | | | | | | | | | | | | | | | | | | |
|------------------------------|----------------------|------------|-----------|---|--|--|--|--|--|--|--|---|--------------------------------------|------------------|------------------|--------------------|--|--|--|
| FILE NAME = slderdht.dgn | USER NAME = ghidraam | DESIGNED - | REVISED - | STATE OF ILLINOIS DEPARTMENT OF TRANSPORTATION | | | | 1700E PLAN & PROFILE SHEET 2 OF 2 | | | | F.A.P. RTE. 665 | SECTION (136.137)WARS-3(136R)1098R-2 | COUNTY HENDERSON | TOTAL SHEETS 183 | SHEET NO. 183 | | | |
| PLDT SCALE = 100.0000' / IN. | CHECKED - | REVISED - | REVISED - | | | | | | | | | SCALE: SHEET NO. OF SHEETS STA. TO STA. | | | | CONTRACT NO. 88773 | | | |
| PLDT DATE = 2/17/2009 | DATE - | REVISED - | REVISED - | | | | | | | | | ILLINOIS FED. AID PROJECT | | | | | | | |
| | | | | | | | | | | | | | | | | | | | |