

RADIUS RETURN
 HMA BASE COURSE, 6" = 41.6 TONS
 INCIDENTAL HMA SURF., 2" = 13.9 TONS
 SUB-BASE GRAN. MAT'L, TYP A, 6" = 137 SQ. YD.

LT. STA. 9+06.70 TO LT. STA. 9+56.62
 HMA BASE COURSE WIDENING, 9" = 17.5 SQ. YD.

RT. STA. 9+06.55 TO RT. STA. 9+56.62
 HMA BASE COURSE WIDENING, 9" = 16.6 SQ. YD.

STA. 9+06.70 TO STA. 9+56.62
 BITUMINOUS SURFACE TREATMENT CLASS A-1
 BITUMINOUS MATERIALS (COVER & SEAL COATS) = 5.7 GALLONS
 (SEE ARTICLE 403.02 FOR MATERIAL TYPES)
 SEAL COAT AGGREGATE = 1.4 TONS
 (USE GRADATION CA 16)

NOTE
 THE EDGE OF EXISTING PAVEMENT SHALL BE
 CLEANED TO THE SATISFACTION OF THE
 ENGINEER BEFORE PLACEMENT OF THE WIDENING.

STA. 168+13.42 IL 116 =
 10+00 S1800E

STA. 168+15.79 IL 116 =
 10+00 N1800E

STA. 167+71.71 (IL 116)
 RT. 13.0 FT.

STA. 167+71.87
 LT. 13.0 FT.

STA. 9+56.62
 LT. 12.0 FT.

STA. 10+44.87
 LT. 12.0 FT.

STA. 9+06.70
 LT. 8.43 FT.

STA. 11+24.74
 LT. 5.23 FT.

STA. 9+06.55
 RT. 8.25 FT.

STA. 11+25.09
 RT. 6.43 FT.

STA. 9+56.62
 RT. 12.0 FT.
 STA. 168+55.72 (IL 116)
 RT. 13.0 FT.

STA. 10+44.87
 RT. 12.22 FT.
 STA. 168+55.95 (IL 116)
 LT. 13.0 FT.

N1800E
 HMA BASE COURSE, 6" = 96.6 TONS
 INCIDENTAL HMA SURF., 2" = 32.2 TONS
 SUB-BASE GRAN. MAT'L, TYP A, 6" = 317.7 SQ. YD.



DATE	
BY	
PLAN	
SURVEYED	
ALIGNED	
CHECKED	
RT. OF WAY CHECKED	
ROAD FILE NAME	

DATE	
BY	
PROFILE	
SURVEYED	
GRADES CHECKED	
B.M. NOTED	
STRUCTURE NOTATIONS CHECKED	

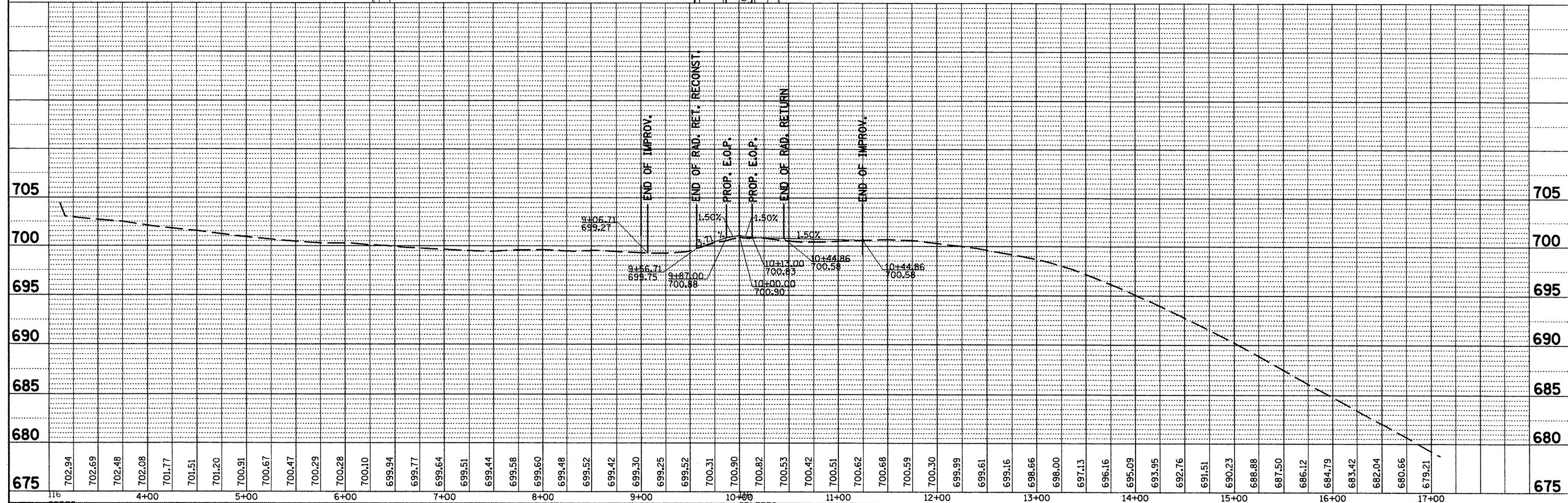

FILE NAME: 3RR13 300.000000 siderdahtg	USER NAME: ghidneam	DESIGNED: -	REVISED: -	STATE OF ILLINOIS DEPARTMENT OF TRANSPORTATION 1800E PLAN & PROFILE SCALE: SHEET NO. OF SHEETS STA. TO STA.	F.A.P. RTE: 665	SECTION: (136.137)W&RS-3d136rd109BR-2	COUNTY: HENDERSON	TOTAL SHEETS: 184	SHEET NO.: 184	
PLOT SCALE: = 1/80.0000 / IN.	CHECKED: -	REVISED: -	CONTRACT NO. 88773		ILLINOIS FED. AID PROJECT					
PLOT DATE: = 2/17/2009	DATE: -	REVISED: -								
NOGAP										