



CITY OF URBANA
PUBLIC WORKS
ENGINEERING DIVISION

DRAWN BY: AUS
CHECKED BY: GLJ

DATED: 1/09
DESIGNED BY: CES
CITY SECTION
00-00361-00-PV

WINDSOR ROAD IMPROVEMENTS
REMOVALS & RELOCATIONS PLANS
STA 71+00 TO STA 80+00

SHEET NO.
29
OF
145

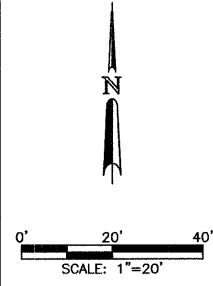
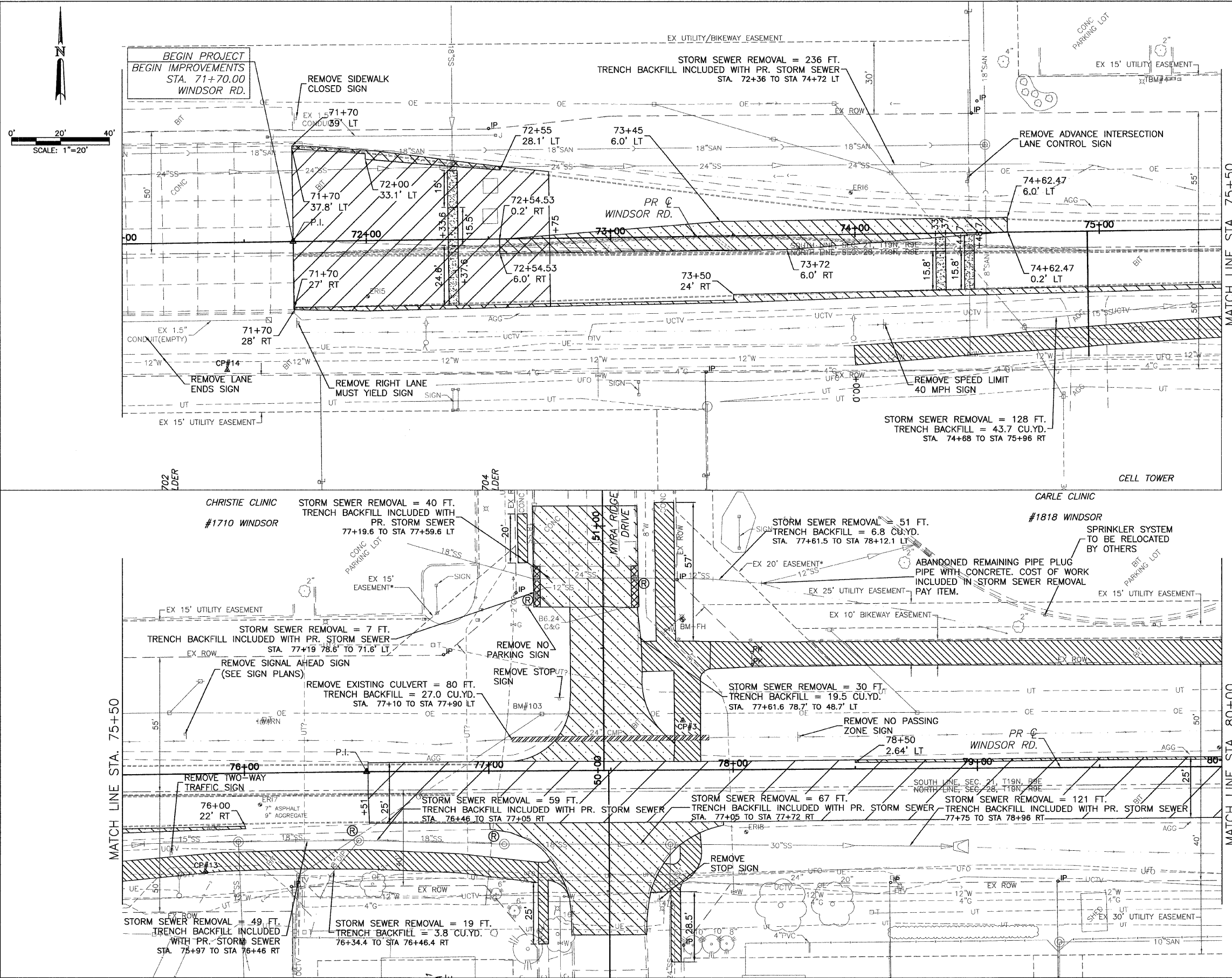

MATCH LINE STA. 75+50

MATCH LINE STA. 80+00

- LEGEND**
- STRUCTURE TO BE REMOVED
 - DRIVEWAY PAVEMENT REMOVAL
 - PAVEMENT REMOVAL
 - CLASS C PAVEMENT PATCHES
 - SIDEWALK REMOVAL
 - CULVERT REMOVAL
 - COMB. CURB & GUTTER REMOVAL
 - HMA SURFACE REMOVAL, VARIABLE DEPTH
 - HMA SURFACE REMOVAL, 2 1/2" DEPTH
 - TREE REMOVAL

ALL VARIOUS SIGNS WHICH INTERFERE WITH CONSTRUCTION OPERATIONS SHALL BE REMOVED AND RELOCATED AS DIRECTED BY THE ENGINEER. SEE SPECIAL PROVISIONS.

SEE PLAN AND PROFILE SHEETS AND DRAINAGE STRUCTURE SCHEDULES FOR STRUCTURE REMOVAL INFORMATION.

SEE INTERSECTION DETAIL SHEETS FOR THE REMOVAL LIMITS.

JAN 09 2009 12:52PM REMREC_STA71+00-80+00.DWG