

SW 1/4 SEC. 22, T.19N., R.9E., 3rd P.M.
CHAMPAIGN COUNTY, ILLINOIS

CONTRACT NO. 91391

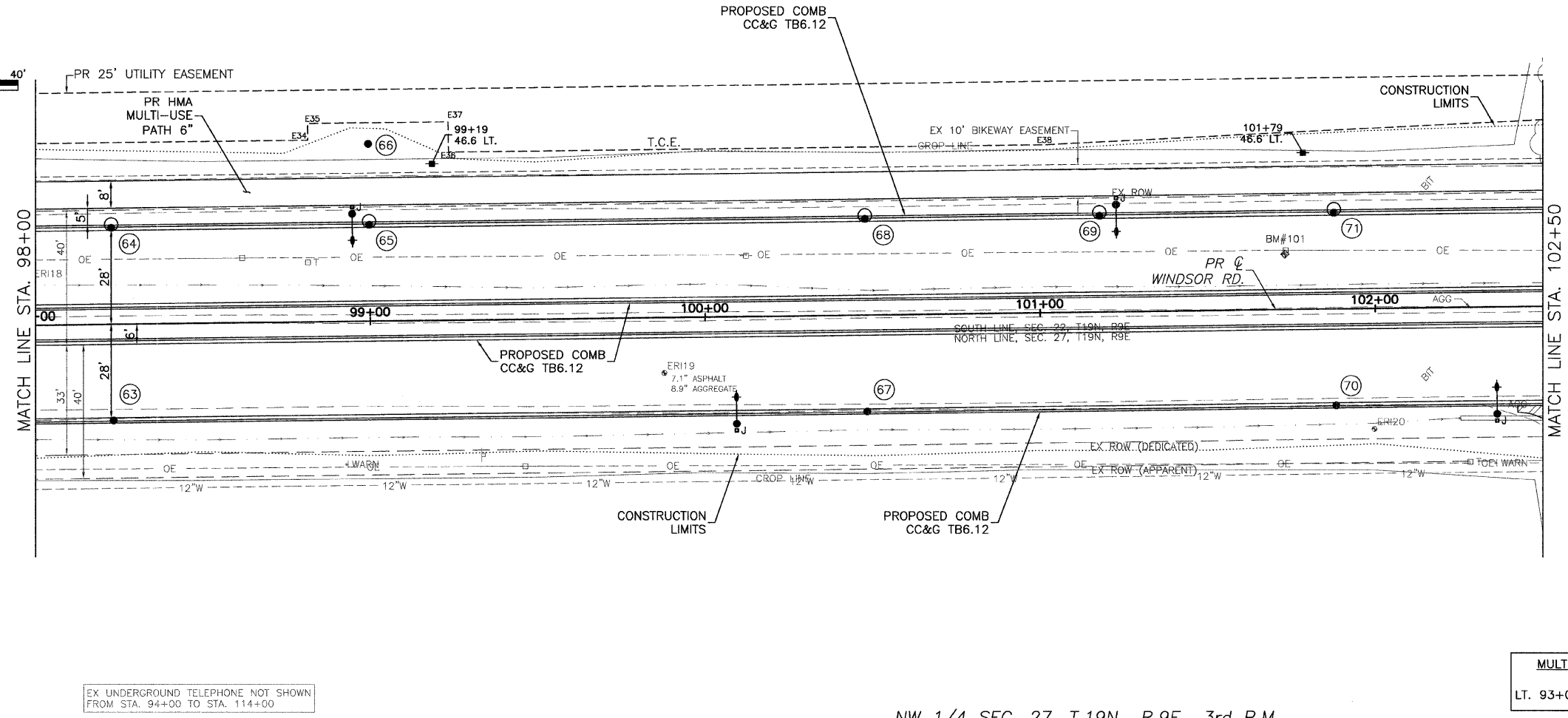
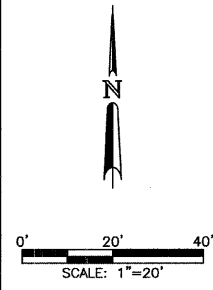

- LEGEND**
- DETECTABLE WARNINGS
 - PCC SIDEWALK
 - PCC DRIVEWAY PAVEMENT
 - AGGREGATE SURFACE COURSE, TYPE A
 - INCIDENTAL HMA SURFACE
 - DRAINAGE STRUCTURE NO. (SEE DRAINAGE SHEETS)

BM #101: STA. 101+73.00,
16.50' LT. RR SPIKE IN
FOURTEENTH POWER POLE WEST
OF STONE CREEK BLVD.
ELEV. = 718.41

- NOTES**
- TRANSITION CC&G B-6.12 TO CC&G B-6.24 IN 20'

TEMPORARY CONSTRUCTION EASEMENT STATIONS AND OFFSETS

| POINT | STATION | OFFSET |
|-------|-----------|----------|
| E34 | 98+82.00 | 54.00 LT |
| E35 | 98+82.00 | 59.00 LT |
| E36 | 99+24.00 | 50.00 LT |
| E37 | 99+24.00 | 59.00 LT |
| E38 | 101+02.00 | 50.00 LT |

MULTI-USE PATH/SIDEWALK CROSS SLOPES

| LOCATION | SLOPE |
|---------------------------|-------|
| LT. 93+02.00 TO 105+50.00 | 1/2% |

EX UNDERGROUND TELEPHONE NOT SHOWN
FROM STA. 94+00 TO STA. 114+00

NW 1/4 SEC. 27, T.19N., R.9E., 3rd P.M.
CHAMPAIGN COUNTY, ILLINOIS

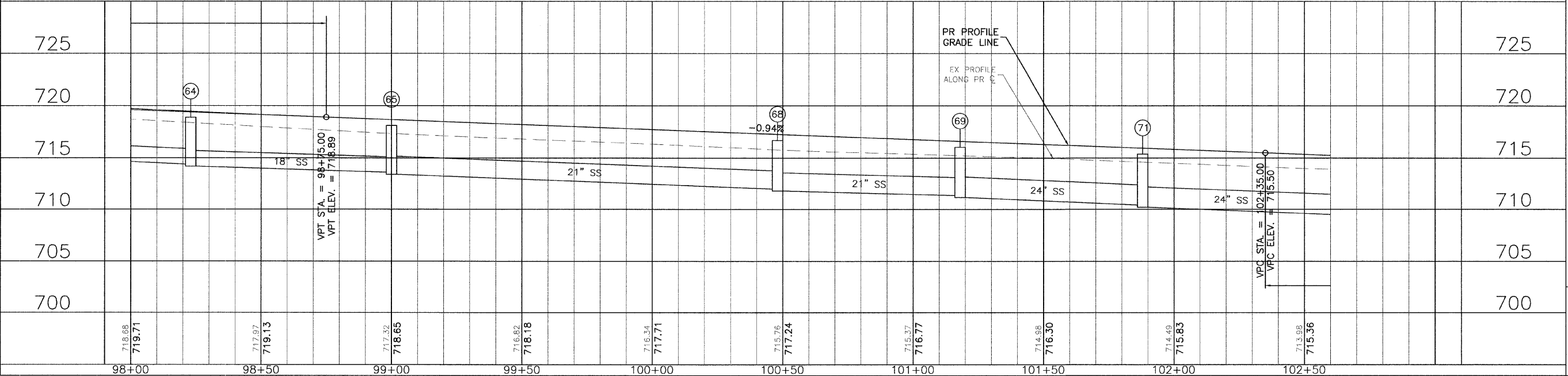

CITY OF URBANA
PUBLIC WORKS
ENGINEERING DIVISION

DRAWN BY: AJJ
CHECKED BY: GLJ
DESIGNED BY: CES
CITY SECTION
00-00361-00-PV

WINDSOR ROAD IMPROVEMENTS
PLAN AND PROFILES
STA 98+00 TO STA 102+50

SHEET NO.
43
OF
145

JAN 09 2009 11:38AM PP STA98+00-102+50.DWG