

CONTRACT NO. 91391

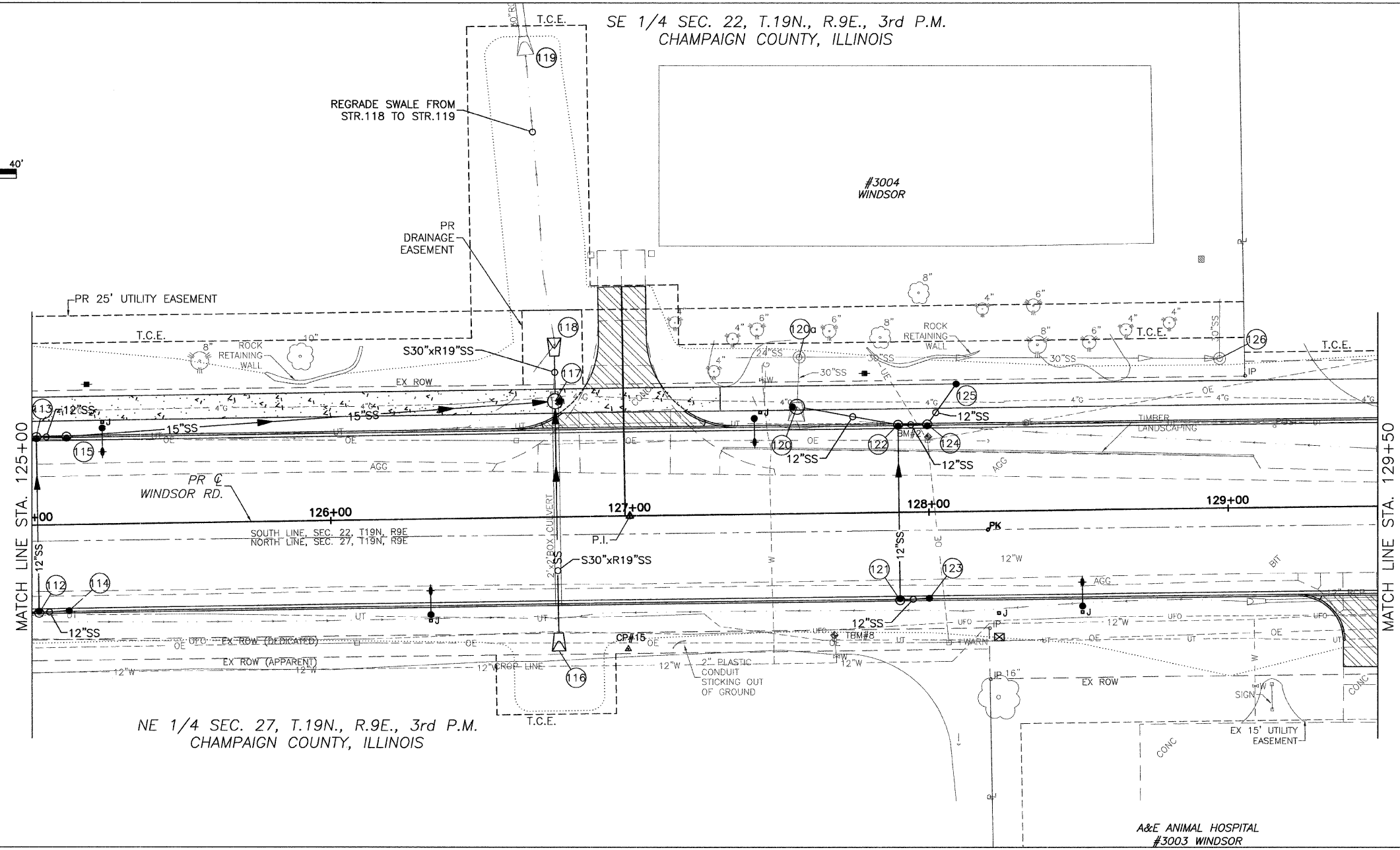

CITY OF URBANA  
PUBLIC WORKS  
ENGINEERING DIVISION

SE 1/4 SEC. 22, T.19N., R.9E., 3rd P.M.  
CHAMPAIGN COUNTY, ILLINOIS



BM #2: STA. 128+00, 25' LT. 16 P.  
NAIL IN N. SIDE OF POWER POLE ON N.  
SIDE OF WINDSOR RD. 1429.00' W. OF  
INTERSECTION RT. 130 & WINDSOR RD.  
ELEV.= 695.57

TBM #8: STA. 127+68.50, 40.50' RT.  
FLANGE BOLT BETWEEN THE 'E & L' IN THE  
WORD 'MUELLER' S. SIDE OF WINDSOR, E.  
OF ENTRANCE INTO STONE CREEK  
MAINTNENCE SHED 3004 WINDSOR  
ELEV.=697.00

NE 1/4 SEC. 27, T.19N., R.9E., 3rd P.M.  
CHAMPAIGN COUNTY, ILLINOIS

STORM SEWER STRUCTURE SCHEDULE											
STR. NO.	STRUCTURE TYPE	OFF-SET SIDE	STA. OF C/L STR.	OFFSET OF C/L STR.	EX. T/O FRAME/GRATE ELEV.	PR. T/O FRAME/GRATE ELEV.	PR. T/O FLAT SLAB TOP ELEV.	INVERT IN ELEV.	U.S. STR. NO.	INVERT OUT ELEV.	D.S. STR. NO.
112	RD INLET TY B T11 F&G	RT	125+01.94	29.29	696.74	695.24	693.44	111	693.40	113	
113	RD INLET TY B T11 F&G	LT	125+01.94	29.29	696.74	695.24	693.12	112	693.08	115	
114	INLETS TA T11 F&G	RT	125+12.00	28.79	696.74				693.34	112	
115	RD INLET TY B T11 F&G	LT	125+12.00	29.29	696.74	695.24	693.06	113	693.02	117	
116	PRCF END S EL EQRS 24	RT	125+75.60	44.79				692.94	DITCH		117
117	RD MAN 5 DIA T1F CL	LT	126+75.60	38.58	697.13	695.46	692.54	115	692.51	118	
118	PRCF END S EL EQRS 24	LT	126+75.60	59.71				692.54	116		118
								692.54	116		118
									117	692.42	DITCH

STORM SEWER STRUCTURE SCHEDULE											
STR. NO.	STRUCTURE TYPE	OFF-SET SIDE	STA. OF C/L STR.	OFFSET OF C/L STR.	EX. T/O FRAME/GRATE ELEV.	PR. T/O FRAME/GRATE ELEV.	PR. T/O FLAT SLAB TOP ELEV.	INVERT IN ELEV.	U.S. STR. NO.	INVERT OUT ELEV.	D.S. STR. NO.
119	NO WORK REQUIRED	LT	126+67.59	154.51				691.77	118		
120	RD MAN 5 DIA T1F CL	LT	127+56.31	35.71		696.79	695.12	691.91	122	691.71	120a
120a	NO WORK REQUIRED	LT	127+57.24	52.32	696.06			691.11	120	691.09	E
121	RD INLET TY B T11 F&G	RT	127+90.00	29.29		696.74	695.24	692.84	123	692.74	122
122	RD INLET TY B T11 F&G	LT	127+90.00	29.29		696.74	695.24	692.46	121	692.36	120
								692.46	124		
123	INLETS TA T11 F&G	RT	127+99.78	28.79		696.74				692.88	121
124	RD INLET TY B T11 F&G	LT	127+99.78	29.29		696.74	695.24	692.59	125	692.49	122
125	INLETS TA T1F OL	LT	128+09.61	42.58		696.54				692.73	124
126	NO WORK REQUIRED	LT	128+97.79	50.05	695.96			690.97	E	690.87	E

STORM SEWER PIPE SCHEDULE						
LOCATION STR. - STR. OR STA., O.S.	STORM SEW CL A 1 12 (FOOT)	STORM SEW CL A 1 15 (FOOT)	STORM SEW S30 R19 (FOOT)	STORM SEW CL A 2 12 (FOOT)	GRADE %	TRENCH BACKFILL (CU YD)
112 - 113	56				0.50	5.0
112 - 114	8				0.30	0.6
113 - 115	8				0.30	0.8
115 - 117		160			0.30	50.2
116 - 117			75		0.50	27.7
117 - 118			13		0.50	--
120 - 122				31	1.50	11.0
121 - 122	56				0.50	8.4
121 - 123	8				0.50	1.0
122 - 124				7	0.50	1.1
124 - 125	14				1.00	4.0

E=EXISTING  
\*STATION, OFFSET AND INVERT TO END OF END SECTION.  
\*\*CENTER OF 2 FT. OPENING = STA. 126+77.10, 38.56 FT. LEFT.

E=EXISTING  
\*\*\*BUILD MANHOLE OVER EXISTING STORM SEWER. MANHOLE INVERT IS ESTIMATED. FIELD VERIFY.  
CENTER OF 2 FT. OPENING = STA. 127+54.81, 35.73 FT. LEFT.

WINDSOR ROAD IMPROVEMENTS  
DRAINAGE PLANS  
STA 125+00 TO STA 129+50

SHEET NO.  
66  
OF  
145

JAN 09 2009 1:27PM DRAINAGE\_STA125+00-129+50.DWG