

MULTI-USE PATH PROFILE NORTH SIDE OF WINDSOR ROAD FROM STONE CREEK BLVD. TO STA 133+00

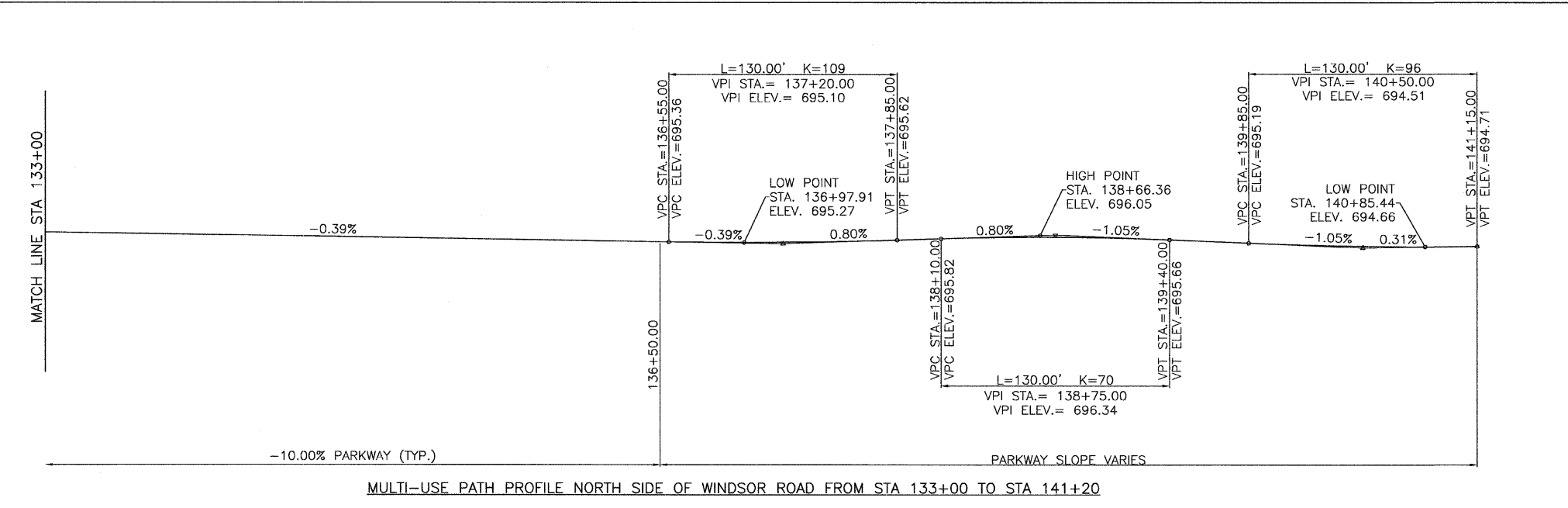

MULTI-USE PATH PROFILE NORTH SIDE OF WINDSOR ROAD FROM STA 133+00 TO STA 141+20

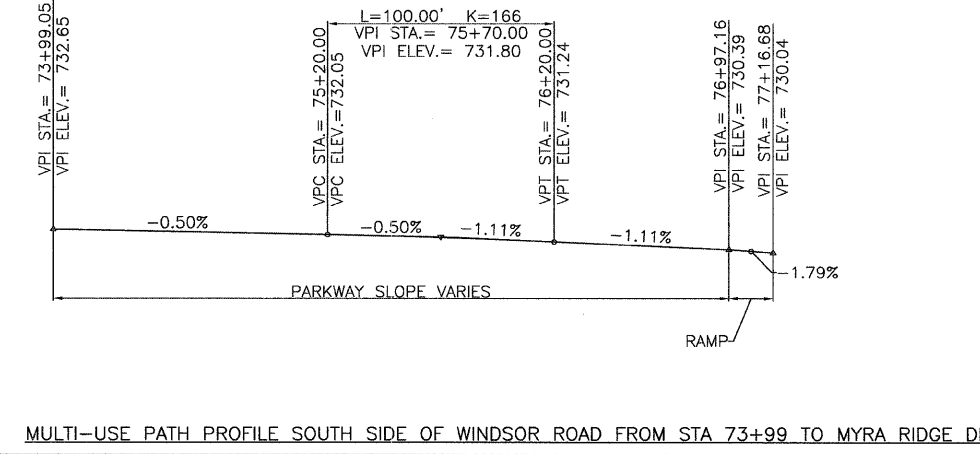

MULTI-USE PATH PROFILE SOUTH SIDE OF WINDSOR ROAD FROM STA 73+99 TO MYRA RIDGE DR.

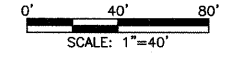

P.G.L. IS LOCATED AT INSIDE EDGE OF MULTI-USE PATH OR SIDEWALK. (SEE TYPICAL SECTIONS)