

SECTION 29, R. 6 W., T. 18 N. 3rd P.M.

F.A.S. RTE.	SECTION	COUNTY	TOTAL SHEETS	SHEET NO.
574	07-00056-00-PV	MENARD	34	9
CONTRACT NO.			93477	
FED. ROAD DIST. NO. ILLINOIS FED. AID PROJECT				

STATION 123+83
 INSTALL NEW 24" X 56" R.C.C.P., TYPE I WITH FLARED END SECTIONS
 INLET - EL. 611.0
 OUTLET - EL. 610.3

CURTIS L. & JEFFERY L. SAMPSON

N.W. LINE, E. 1/2, N.E. 1/4, SEC. 29

ROBERT SAMPSON

STA. 128+87 (F.A.S. 574) = STA. 5+00 (CANTRALL RD.)

INSTALL NEW 18" X 68" PIPE CULVERTS, CLASS D, TYPE I WITH METAL END SECTIONS
 INLET - EL. 612.4
 OUTLET - EL. 612.2

EXIST. 15" C.M.P. (TO BE REMOVED)

EXIST. GUARDRAIL (TO BE REMOVED)

EXIST. R.O.W.

PROP. R.O.W.

TICE ROAD

PROP. R.O.W.

CONTROL POINT F

MATCH LINE - STA. 123+50

CONST. LIMITS

EX. RDWY.

PT

CONTROL POINT E

CONST. LIMITS

EXIST. R.O.W.

N. LINE, S.E. 1/4, SEC. 29

CONTROL POINT F

PROJECT ENDS STA. 134+10

PROP. CURVE C6

PI STA. = 124+74.51
 $\Delta = 29^\circ 40' 18''$ (RT)
 $D = 4^\circ 15' 04''$
 $R = 1,347.78'$
 $T = 357.00'$
 $L = 697.97'$
 $E = 46.48'$
 $e = 0.06''$
 $T.R. = 40'$
 $S.E. RUN = 160'$
 $P.C. STA. = 121+17.51$
 $P.T. STA. = 128+15.48 = STA. 128+36.78$ BACK
 S.E. ATTAINMENT: STA. 119+67.51 TO STA. 121+67.51 LT.
 STA. 120+47.51 TO STA. 121+67.51 RT.
 STA. 127+65.48 TO STA. 129+65.48 LT.
 STA. 127+65.48 TO STA. 128+85.48 RT.

JAMES L. SAMPSON

MATCH LINE - STA. 5+55

JAMES L. SAMPSON

LEGEND

- INDICATES TEMPORARY CONST. EASEMENT
- INDICATES TEMPORARY DITCH CHECK
- INDICATES PERIMETER EROSION BARRIER
- INDICATES R.O.W. MARKER

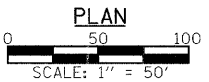
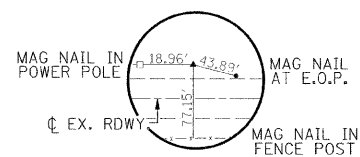
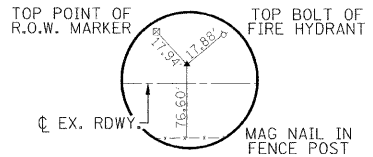

PLAN	SURVEYED	DATE
	BY	
	NOTED	
	DATE	

PROFILE	SURVEYED	DATE
	BY	
	NOTED	
	DATE	

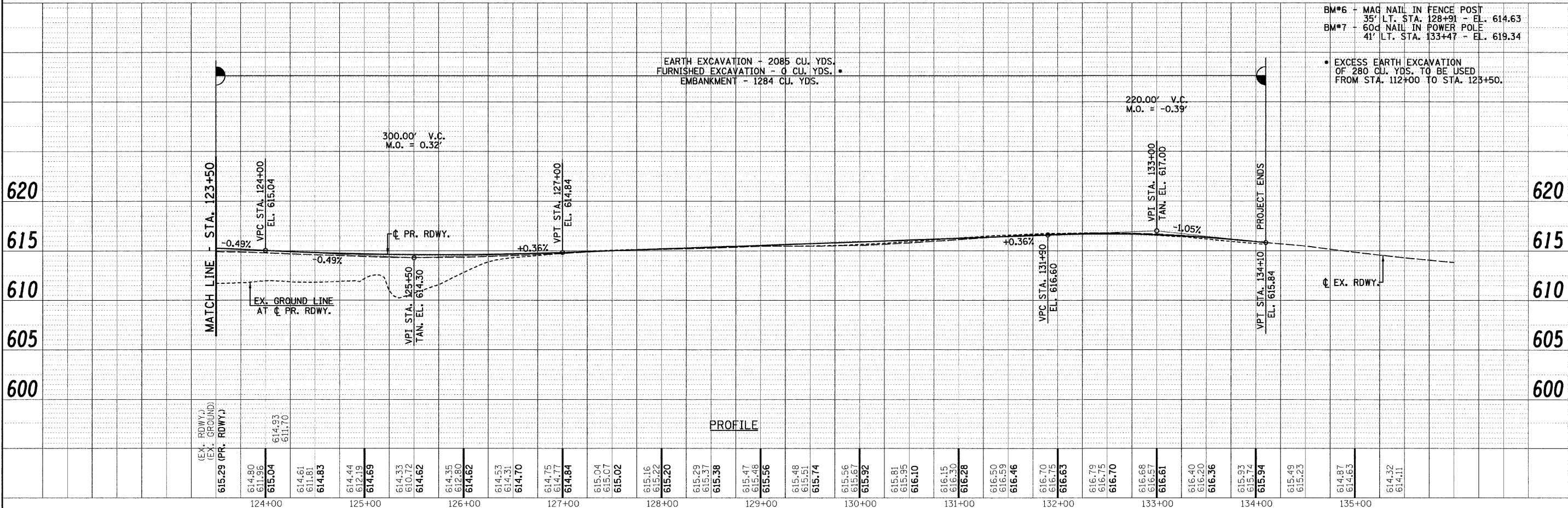

FILE NAME =	USER NAME = #USER#	DESIGNED -	REVISED -	<p>Allen Henderson & Associates, Inc. Civil and Structural Engineers Springfield, IL 62703 Phone: (217)544-8033 IL Design Firm No. 184-001907</p>	<p>PLAN & PROFILE</p> <p>SCALE: 1" = 50' SHEET NO. OF SHEETS STA. 102+90.00 TO STA. 134+10.00</p>		F.A.S. RTE.	SECTION	COUNTY	TOTAL SHEETS	SHEET NO.
		CHECKED -	REVISED -		574	07-00056-00-PV	MENARD	34	9		
		DRAWN -	REVISED -		CONTRACT NO.						
		CHECKED -	REVISED -		FED. ROAD DIST. NO. ILLINOIS FED. AID PROJECT						